

CALC. BY: *[Signature]*
 DATE: 6/10/00
 CHKD. BY: *[Signature]*
 DATE: 6/22/00

LAKE COUNTY
 L.A.K - 306 - 6.50

OHIO
 FHWA REGION 5

15
 38

BENCHMARK: TOP OF HYDRANT
 STA. 9+01, 22' LT.
 ELEV. 643.26

NOTE: ALL WORK SHOWN ON THIS SHEET, WITH THE EXCEPTION OF THE CONCRETE WALK & CURB RAMPS, SHALL BE PAID FOR 100% BY THE CITY OF MENTOR.

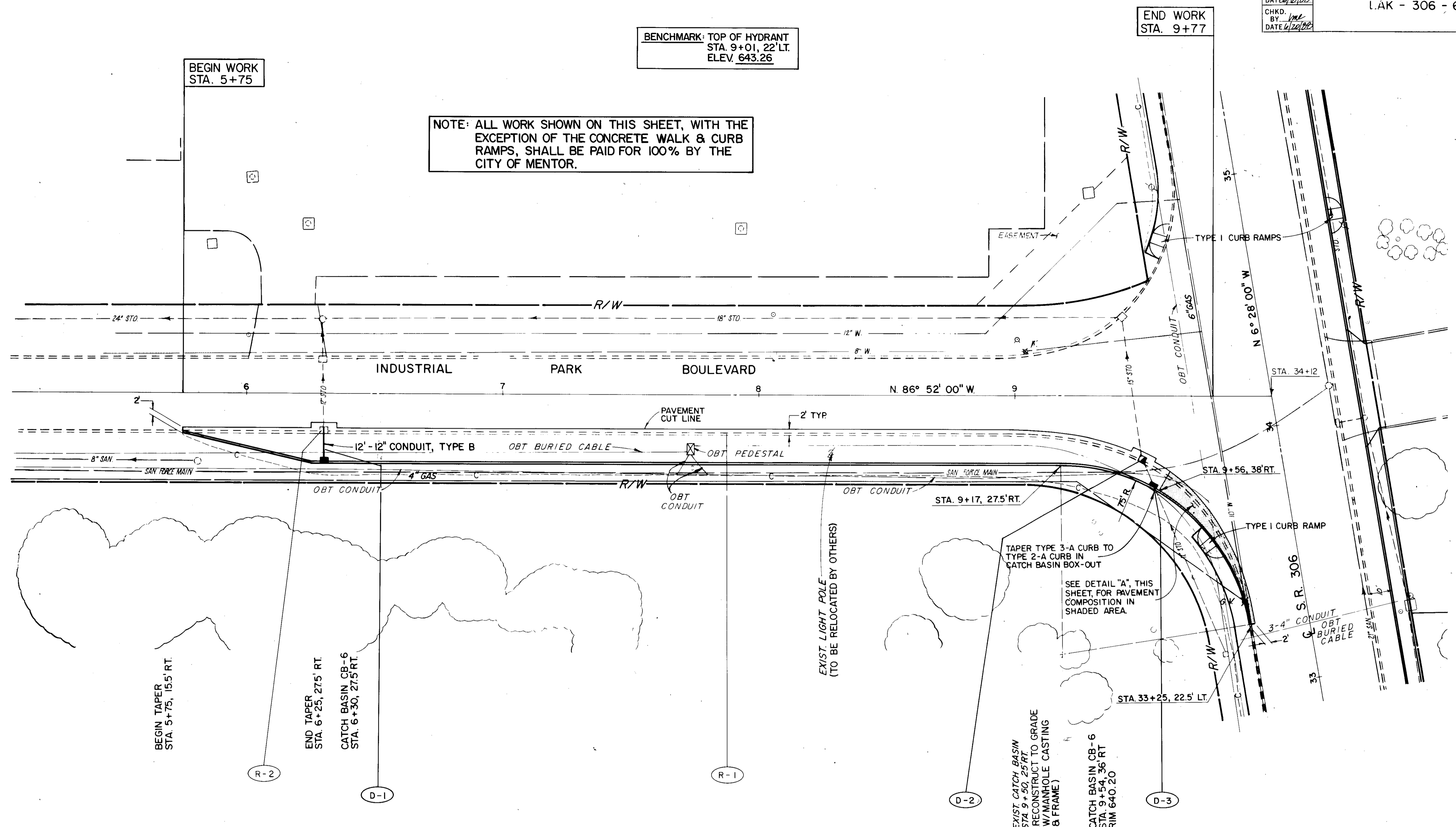

FOR SIGNALIZATION PLAN SEE SHEET 34
 FOR PAVEMENT MARKING PLAN SEE SHEET 32
 FOR STORM SEWER PROFILES SEE SHEET 16

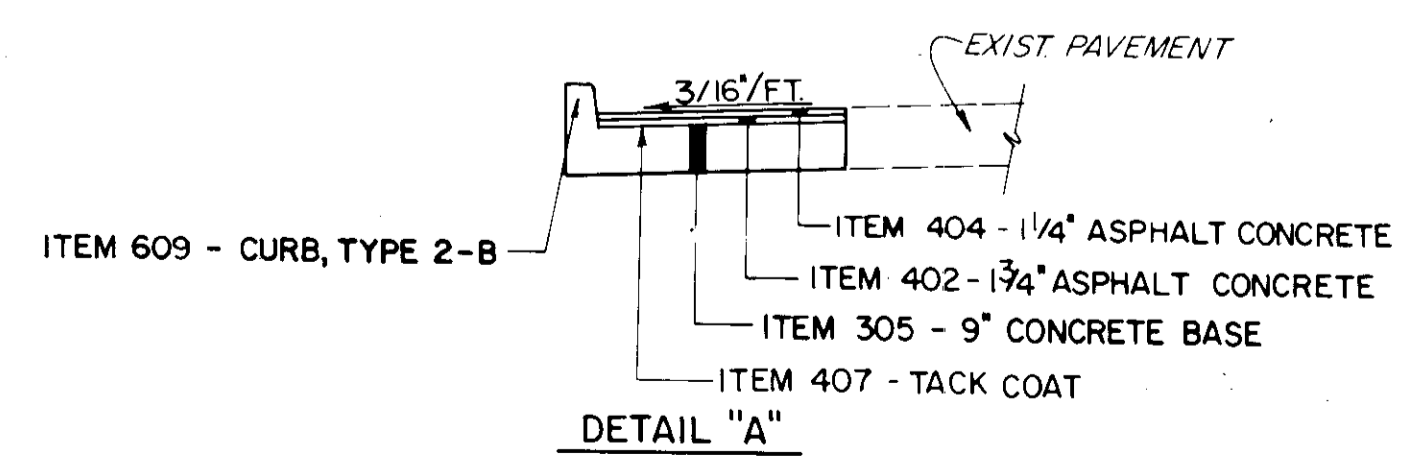

DRAINAGE		12\"/>		
REF.	LOCATION	L.F.	EACH	EACH
D-1	STA. 6+30, 15' RT. TO 27.5' RT.	12	1	
D-2	STA. 9+50, 25' RT.		1	1
D-3	STA. 9+54, 36' RT.		1	
TOTALS		12	2	1

ROADWAY		CURB & GUTTER REMOVED, AS PER PLAN	CATCH BASIN REMOVED
REF.	LOCATION	L.F.	EACH
R-1	STA. 5+75 TO 10+00, RT.	460	
R-2	STA. 6+30, 15.5' RT.		1
TOTALS		460	1

INDUSTRIAL PARK BOULEVARD