

5-11 1985

STATE OF OHIO  
DEPARTMENT OF TRANSPORTATION

LAKE COUNTY LAK-306-6.50	OHIO FHWA REGION 5	1 38
HES-1A35(7)		FEDERAL PROJECT

DESIGN DESIGNATION

Current Year ADT 1987	= 25398
Design Year ADT 2007	= 38097
D.H.V.	= 3810
D	= 50%
T	= 10%
V - DESIGN	= 35 MPH
V - LEGAL	= 25 MPH
FUNCTIONAL CLASSIFICATION	URBAN ARTERIAL

# LAK-306-6.50

## CITY OF MENTOR LAKE COUNTY

### HES-1A35(7)

CONVENTIONAL SIGNS

County Line	-----	Limited Access (only)	-----	LA
Township Line	-----	Right of Way (only)	-----	RW
Section Line	-----	Limited Access & Right of Way	-----	LA & RW
Corporation Line	-----	Existing Right of Way	-----	R/W
Fence Line (existing)	x x (proposed) x x	Property Line (in existing fence)	x x	
Center Line	352 353	Railroad		or
Trees, Stumps	(to be removed)	Guardrail (exist.)	o-o-o	(prop.)
Utility Poles: Telephone	φ	Manholes (exist.)	o	(adjst.)
Power	φ	Catch or Inlet Basins (exist.)	□	(adjst.)
Light	φ			

INDEX OF SHEETS

TITLE SHEET	1
TYPICAL SECTIONS	2
GENERAL NOTES	3, 4
MAINTENANCE OF TRAFFIC CALCULATIONS	5
DRIVE SUB-SUMMARY	7
GENERAL SUMMARY	8
PLAN SHEETS	9, 10
STORM SEWER PROFILES	11-15
CROSS-SECTIONS & DRIVE PROFILES	16
TRAFFIC CONTROL	17-24
Sheet 6 has been deleted	25-38, 27A, 27B

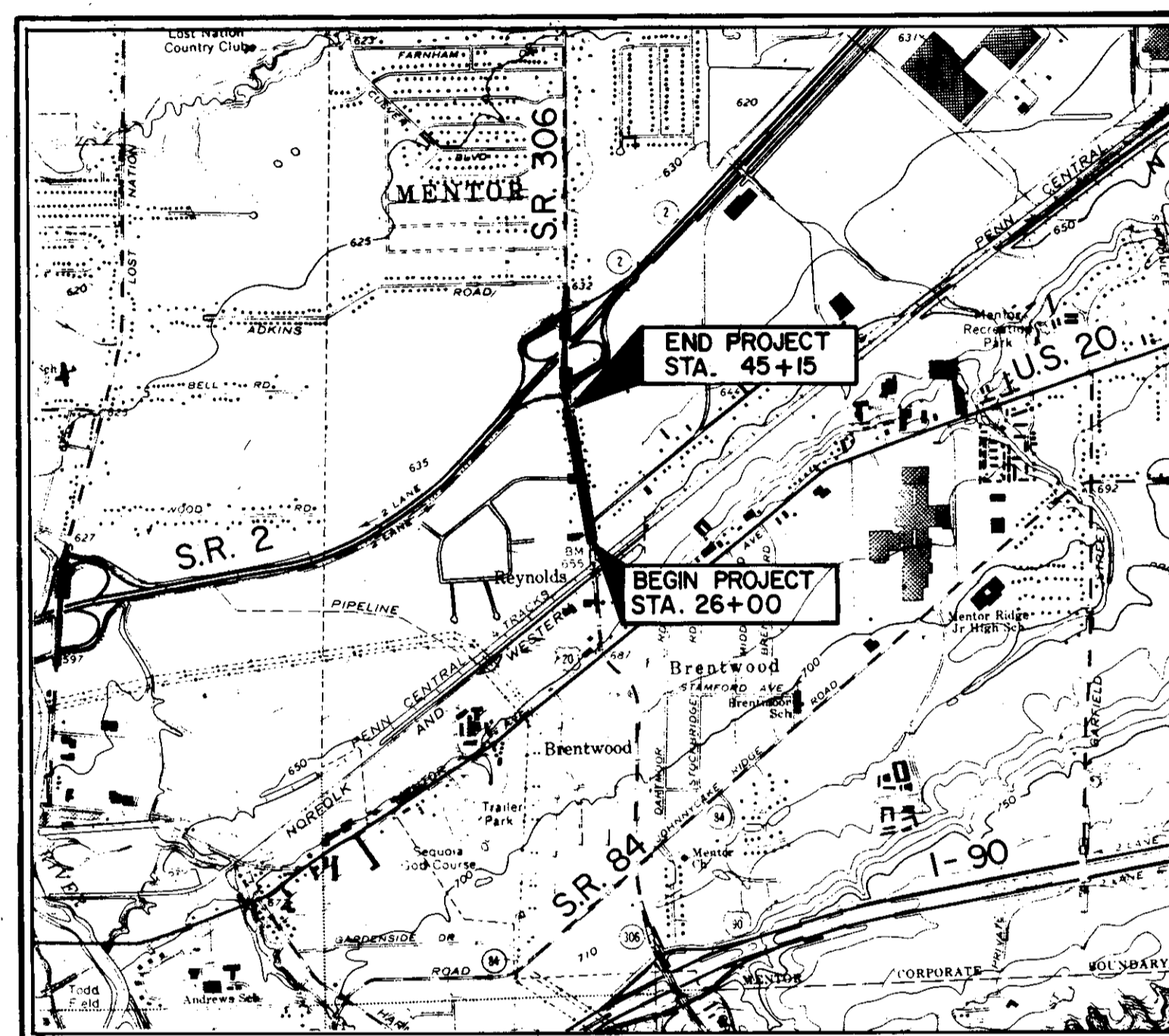

LOCATION MAP



Portion to be improved: \_\_\_\_\_  
State & Federal Routes: \_\_\_\_\_  
Other Roads: \_\_\_\_\_

SCALES



UNDERGROUND UTILITIES  
TWO WORKING DAYS  
**BEFORE YOU DIG**  
CALL 800-362-2764 (TOLL FREE)  
OHIO UTILITIES PROTECTION SERVICE  
NON-MEMBERS MUST BE CALLED DIRECT

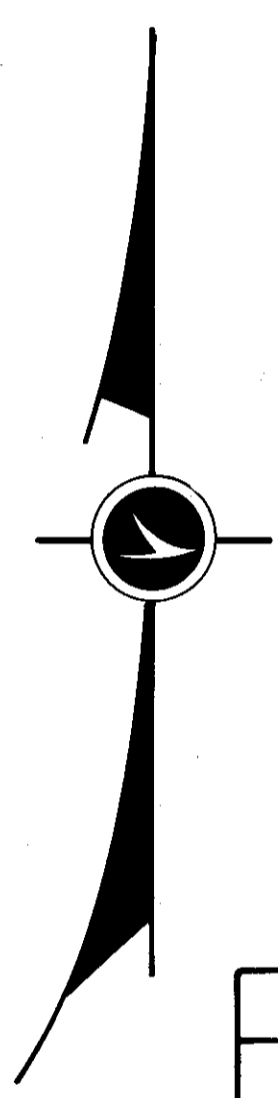

LINE DATA

BEGIN PROJECT	STA. 26+00
END PROJECT	STA. 45+15
LENGTH OF PROJECT	1915 LIN. FT. or 0.363 MI.
ADD FOR WORK	
S.R. 306	
STA. 45+15 TO STA. 57+40	1225 LIN. FT. or 0.232 MI.
INDUSTRIAL PARK BOULEVARD	
STA. 5+75 TO STA. 9+77	402 LIN. FT. or 0.076 MI.
LENGTH OF WORK	3542 LIN. FT. or 0.671 MI.

SUPPLEMENTAL SPECIFICATIONS	
847	10-17-83
944	10-1-87
947	10-17-83

SUPPLEMENTAL PRINTS OF STANDARD CONSTRUCTION DRAWINGS					
BP-3	12-6-76	HL-30.11	5-1-87	TC-21.20	1-20-84
BP-5	10-1-87	HL-30.22	5-1-87	TC-41.40	6-18-79
BP-6	10-1-87	HL-50.11	5-1-87	TC-41.41	8-2-79
BP-7	10-1-87			TC-71.10	4-9-79
BP-12	10-1-87	MT-99.10	11-14-86	TC-81.20	1-20-84
BP-4	10-1-87	MT-95.31	10-10-88	TC-82.10	8-29-84
				TC-83.20	1-20-84
CB-2-3	5-1-79			TC-84.20	1-20-84
CB-3A	5-1-79			TC-85.10	1-20-84
CB-6	5-1-79			TC-85.20	1-20-84
		MC-4	7-26-76		
		MC-11	8-1-78	TC-35.10	8-29-84
HW-4B	4-1-80				

1989 SPECIFICATIONS

The standard specifications of the State of Ohio, Department of Transportation, including changes and supplemental specifications listed in the proposal shall govern this improvement.

I hereby approve these plans and declare that the making of this improvement will not require the closing to traffic of the highway and that provisions for the maintenance and safety of traffic will be as set forth on the plans.

Approved: John A. Ballis  
Date: 2-25-88 District Deputy Director of Transportation

Approved: \_\_\_\_\_  
Date: \_\_\_\_\_ Engineer, Bureau of Bridges and Structural Design

Approved: James R. Longwecker  
Date: 1-31-89 Deputy Director Operations

Approved: Richard B. Must  
Date: 3/22/89 Director, Department of Transportation

06151

DEPARTMENT OF TRANSPORTATION  
FEDERAL HIGHWAY ADMINISTRATION

APPROVED: \_\_\_\_\_  
DIVISION ADMINISTRATOR DATE

Plan Prepared By:  
**CT Consultants, Inc.**  
Engineers • Architects • Planners  
Bloomington • Denver • North Dallas • Richmond • Irvine

Richard A. Flemer  
REGISTERED ENGINEER No. 29224



Project: \_\_\_\_\_  
Date of Letting: \_\_\_\_\_ 19\_\_\_\_, Contract No. \_\_\_\_\_  
LD0300 Rev. 11-1-78

STATE ROUTE 306

TITLE SHEET