

EXTRA AREA DETAILS

SCALE 1" = 20'

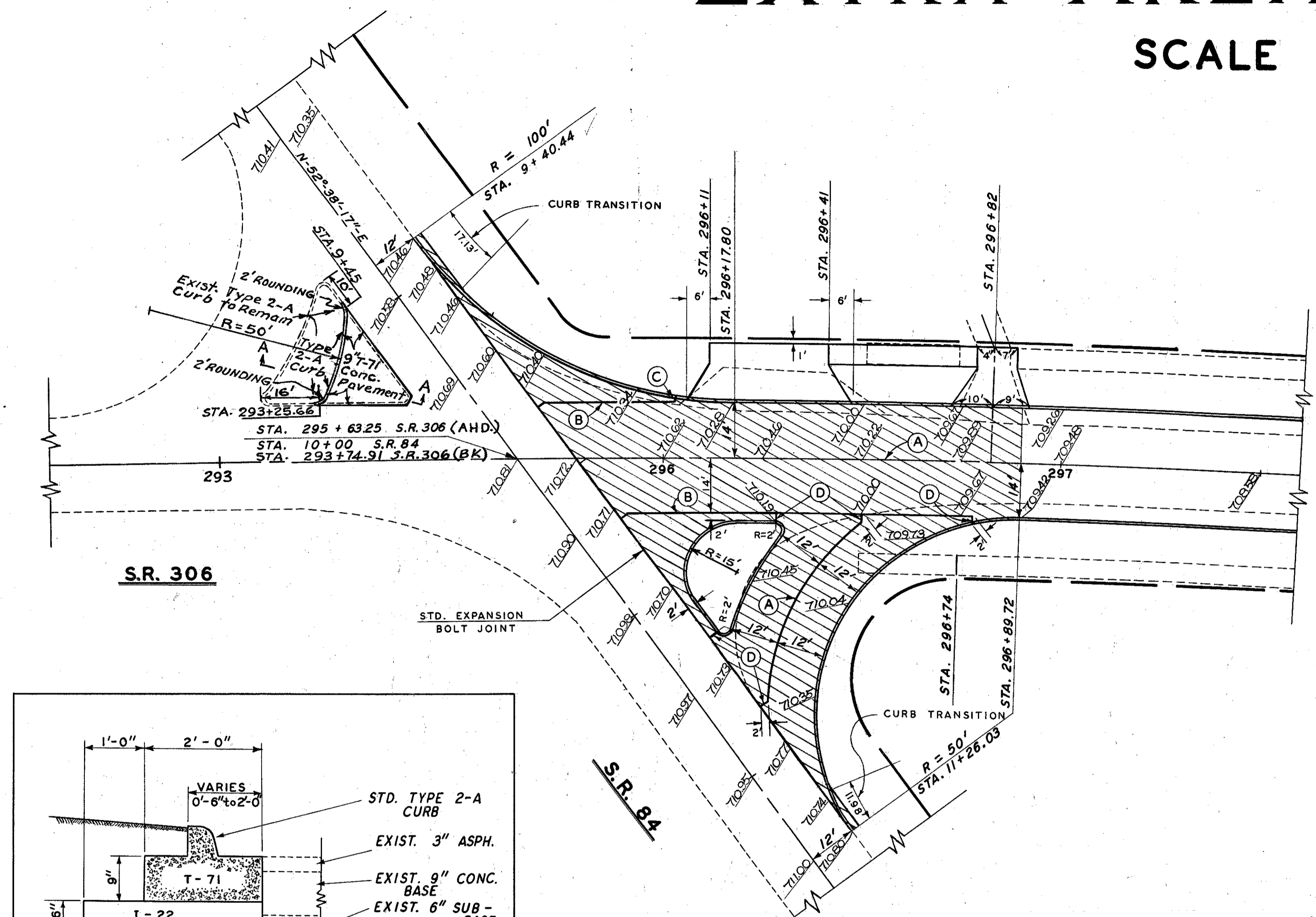

- LEGEND**
- (A) STANDARD LONGITUDINAL JOINT.
 - (B) STANDARD KEY JOINT WITHOUT TIE BARS.
 - (C) 2' EXPANSION JOINT WITHOUT DOWELS. (LOCATED ON RADIAL LINE.)
 - (D) EXPANSION JOINT WITHOUT DOWELS.
 - [Hatched Box] NEW REINFORCED PORTLAND CEMENT CONCRETE PAVEMENT.
 - [Diagonal Line Box] NEW ASPHALTIC CONCRETE PAVEMENT.
- 1" - T-35, 1 1/2" - B-35, 4" - B-19, 4" - I-22

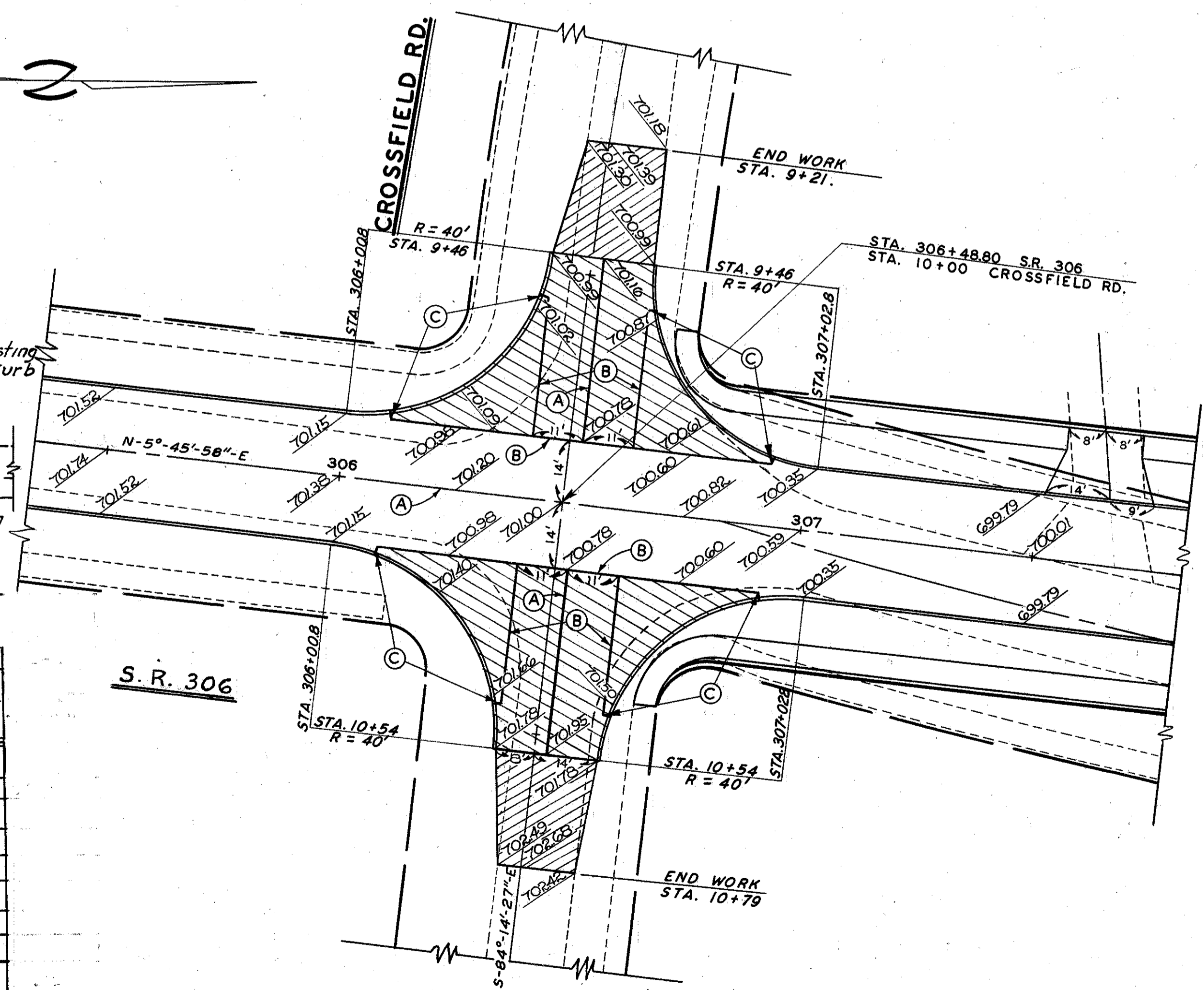
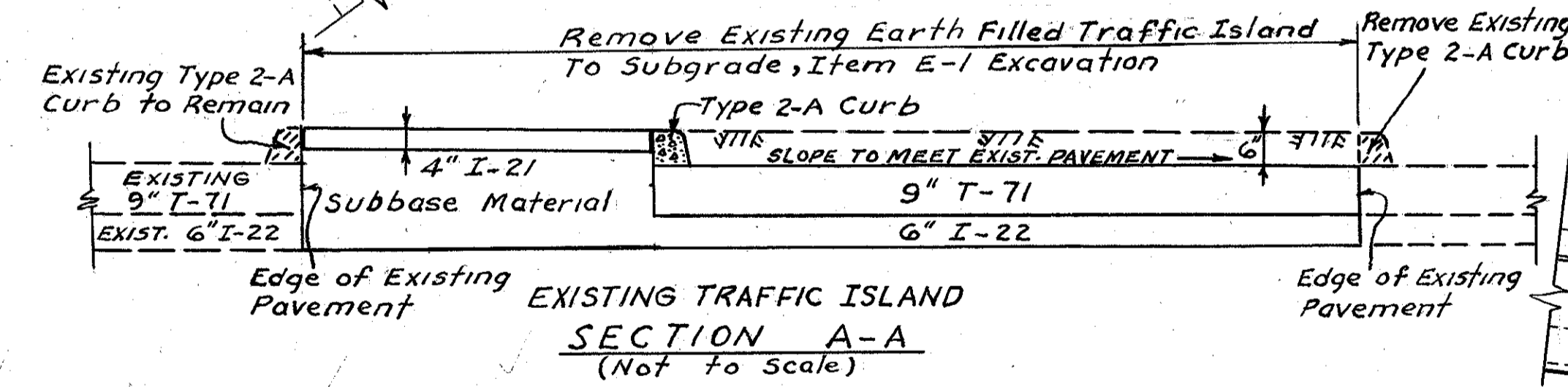
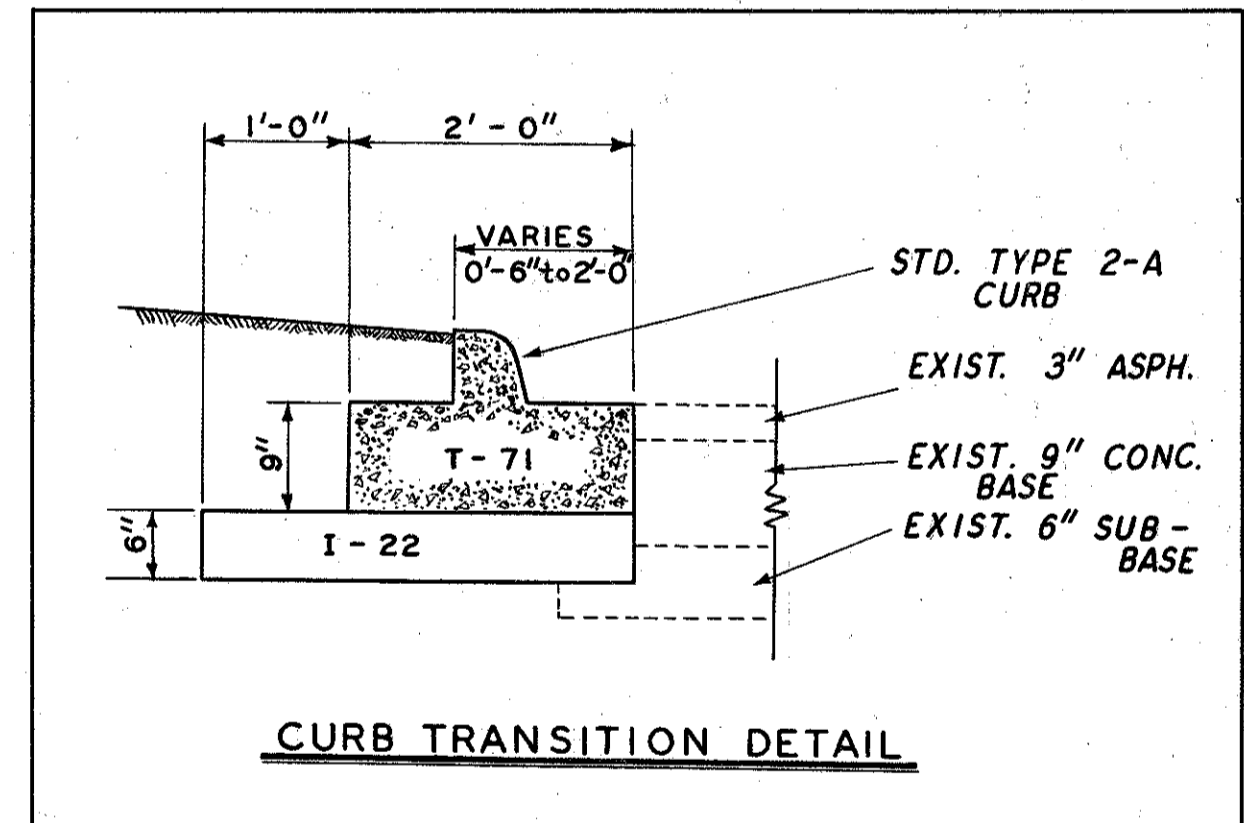

LOCATION STATION TO STATION		SIDE	T-71 REINFORCED PORTLAND CEMENT CONCRETE PAVEMENT SQ. YDS.	I-22 SUBBASE CU. YDS.	I-12 STANDARD TYPE 2-A CURB LIN. FT.	I-21 4" PORTLAND CEMENT CONCRETE TRAFFIC ISLAND PAVEMENT SQ. YDS.	T-30 BITUMINOUS PRIME COAT AT 0.4 GALS. PER. SQ. YD. GALS.	T-35 1" ASPHALTIC CONCRETE SURFACE COURSE CU. YDS.	B-35 1/2" ASPHALTIC CONCRETE LEVELING COURSE CU. YDS.	B-19 4" AGGREGATE BASE COURSE CU. YDS.	S-23 DOWEL HOLES EACH	SPECIAL STANDARD EXPANSION BOLTS EACH	E-1 EXCAVATION METHOD "A" CU. YDS.	E-8 REMOVAL AND DISPOSAL OF EXISTING CURB LIN. FT.
293+4.9 - 296+89.72		L	247	44	188									
296+04.5 - 296+89.72		R	370	70	206	54								
306+00.80 - 307+02.80		L	175	38	126		22	1.5	2	6				
306+00.80 - 307+02.80		R	175	38	126		22	1.5	2	6				
9+40.44 - 11+26.03		L									37	37		
SUB-TOTAL			967	190	646	54	44	3	4	12	37	37		
293+09.66 - 293+49.66		L	30	20	28	30							30	55
TOTAL			997	210	674	84	44	3	4	12	37	37	30	55