

LAKE COUNTY
LAK-306-474

QUANTITY CALCULATIONS
BY: DA DATE 9/10/81
CHKD: KS DATE 10/30/81
COLPETZER - WOODS CONSULTANTS

LAKE COUNTY COMMUNITY COLLEGE
VOL. 692, PG. 87-89

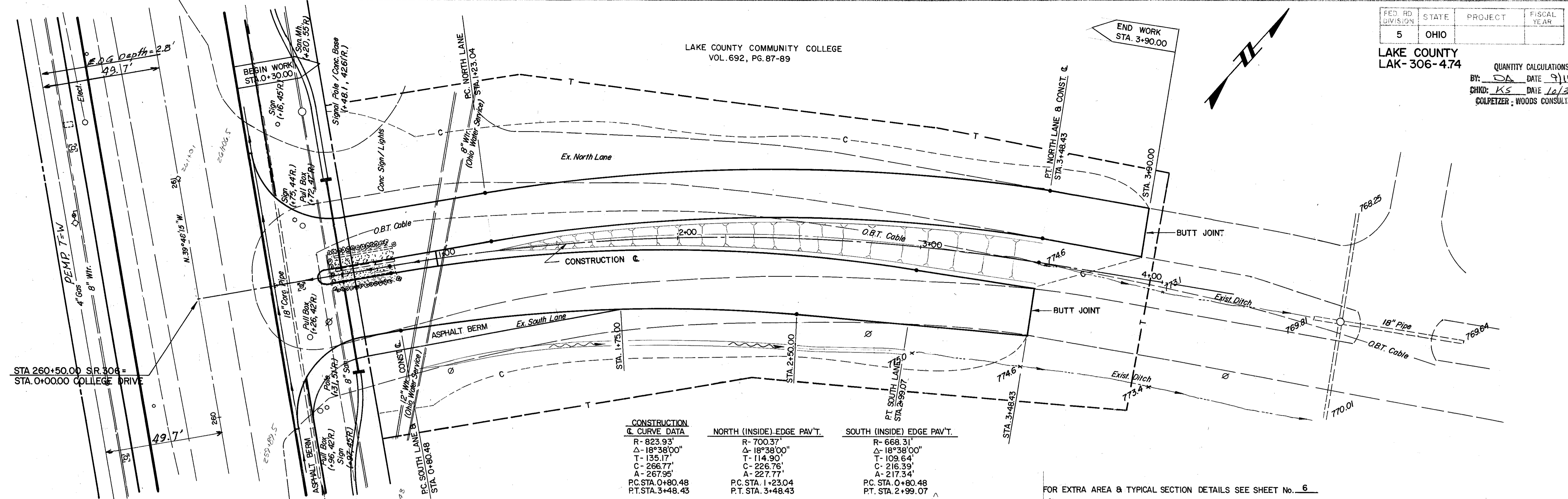

CONSTRUCTION C CURVE DATA	NORTH (INSIDE) EDGE PAV'T.	SOUTH (INSIDE) EDGE PAV'T.
R- 823.93	R- 700.37	R- 668.31
Δ- 18°38'00"	Δ- 18°38'00"	Δ- 18°38'00"
T- 135.17	T- 114.90	T- 109.64
C- 266.77	C- 226.76	C- 216.39
A- 267.95	A- 227.77	A- 217.34
P.C. STA. 0+80.48	P.C. STA. 1+23.04	P.C. STA. 0+80.48
P.T. STA. 3+48.43	P.T. STA. 3+48.43	P.T. STA. 2+99.07

FOR EXTRA AREA & TYPICAL SECTION DETAILS SEE SHEET No. 6

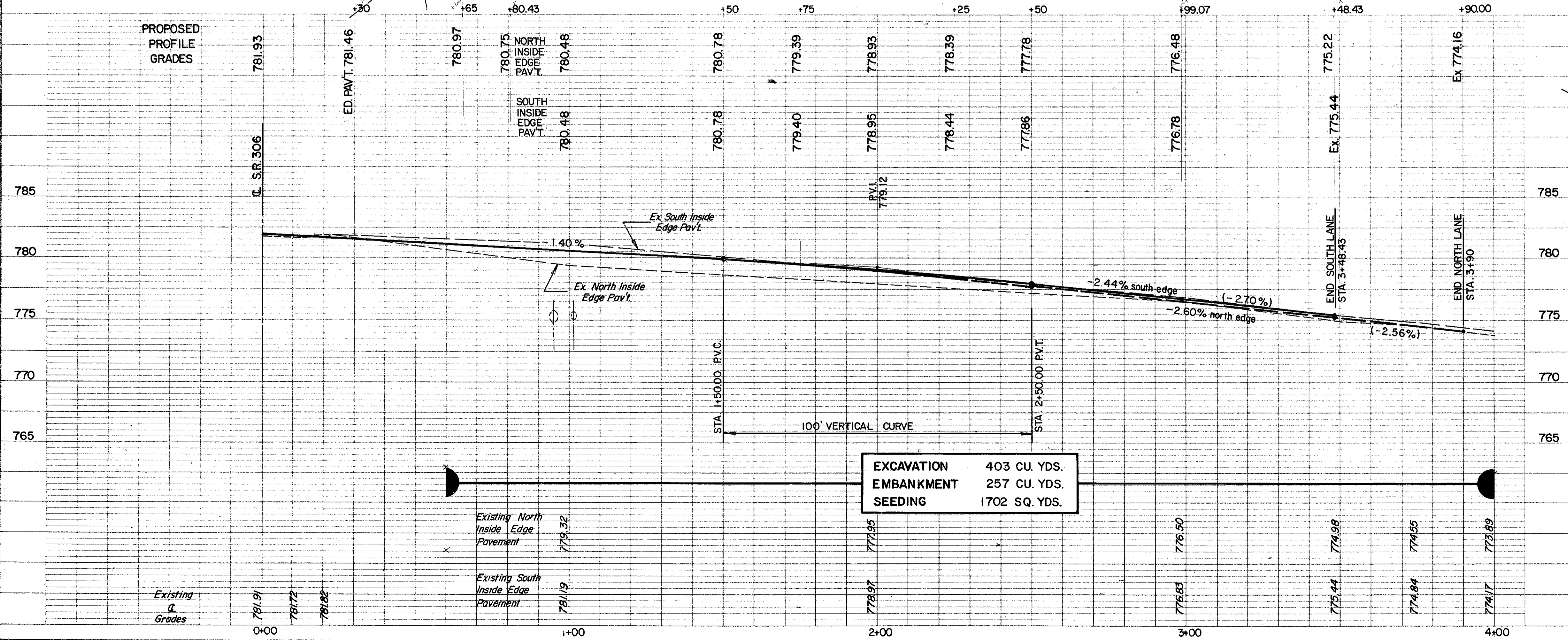

EXCAVATION	403 CU. YDS.
EMBANKMENT	257 CU. YDS.
SEEDING	1702 SQ. YDS.

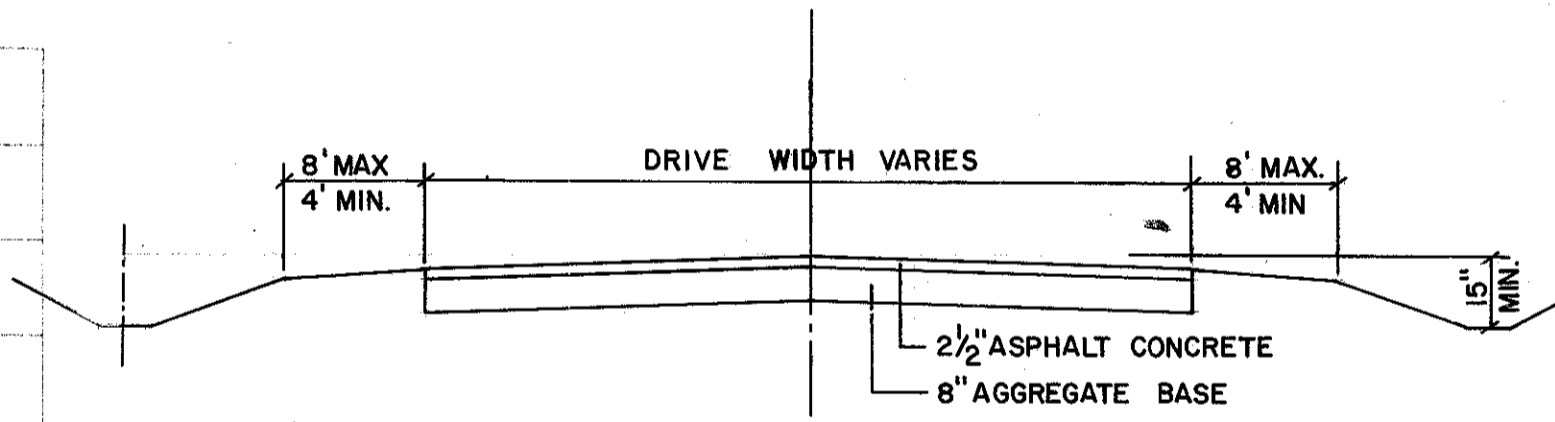

TYPICAL SECTION
EXISTING DRIVE
LAKELAND COLLEGE

ROADWAY REF.	LOCATION				

COLPETZER WOODS CONSULTANTS INC.
MENTOR, OHIO

STATE OF OHIO
DEPARTMENT OF TRANSPORTATION

DESIGNED	DRAWN	TRACED	CHECKED	REVIEW DATE	REVISED

PLAN
SURVEYED BY: []
DESIGNED BY: []
CHECKED BY: []
DATE: []

PROFILE
SURVEYED BY: []
DESIGNED BY: []
CHECKED BY: []
DATE: []