

FM

STATE OF OHIO
DEPARTMENT OF HIGHWAYS
BUREAU OF CONSTRUCTION

FED. AID DIST.	STATE	FED. AID PROJECT	FISCAL YEAR	1
10	OHIO		1934	33

LAKE COUNTY
S.H. 651 SEC'S. C (Pt.) - B (Pt.)
LAKE 06
4.10-5.76

MENTOR - ON - THE - LAKE SOUTHERN RD.

S.H. No 651 SEC'S. C (Pt.) & B (Pt.)

LAKE COUNTY

MENTOR & KIRTLAND TOWNSHIPS

NET LENGTH OF PROJECT 8,796.65 LIN. FT.

The Standard Specifications of the State of Ohio, Department of Highways, in force on date of contract, will govern this improvement.

I hereby approve these plans and declare that the making of this improvement will require the closing of the highway to traffic between Sta. 217+82.73 and Sta. 235+43.11 and that a temporary road will be provided as shown on the plans and estimates, and that the making of this improvement will not require the closing of the highway to traffic between Sta. 205+00 and Sta. 217+82.73 and that one way traffic will be maintained over this portion as provided for on the plans and estimates.

The necessary right of way has been provided.

CONVENTIONAL SIGNS

TOWNSHIP LINE	----
CENTER LINE	=====
PROPERTY LINE	-----
CITY OR VILLAGE LINE	-----
FENCE LINE	-x-x-x-x-
STEAM RAILROAD	====+====
POLE LINE	-T-T-T-T-
GUARD RAIL	-•-•-•-•-
DRAIN PIPE, NEW	-----
DRAIN PIPE, OLD	-----

SUPPLEMENTAL PRINTS OF STANDARD CONSTRUCTION DRAWINGS
T-71-J; T-70-71E No 1; D-T-71R TYPES A & B; G-7.07; I-1,2,3,4 & 5;
I-15-5C; I-8-C.B. I-2 & 2-2; I-8-I No 5; I-8-M.H. No 1; S-27-PC. 1 & 2;
I-12-CC TYPE 2; I-14-G No 1, 2 & 3.

INDEX OF SHEETS

TITLE SHEET	SHEET	1
TYPICAL SECTIONS		2
INTERSECTIONS AND BASIN DETAILS		8 - 9
PLAN AND PROFILE		3 - 6
CURVE TABLES		7
CROSS SECTIONS		10 - 29
STRUCTURAL DETAILS		30 - 32
SUMMARY OF QUANTITIES		33

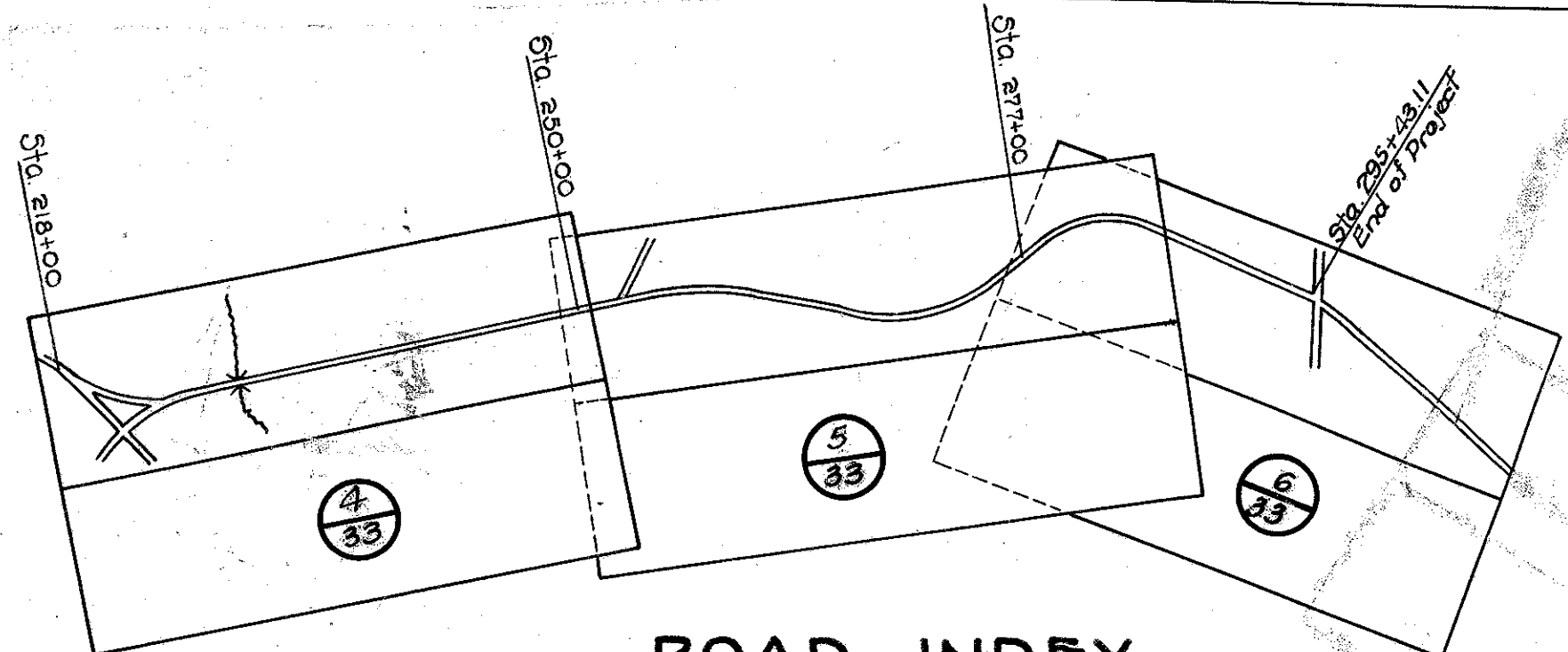
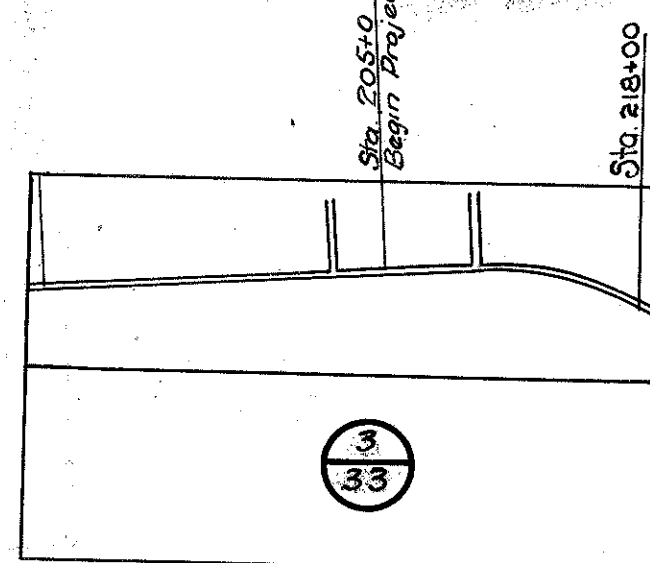

ROAD INDEX BY SHEETS

RIGHT OF WAY IS 60' MIN.
SCALE 1"=100'

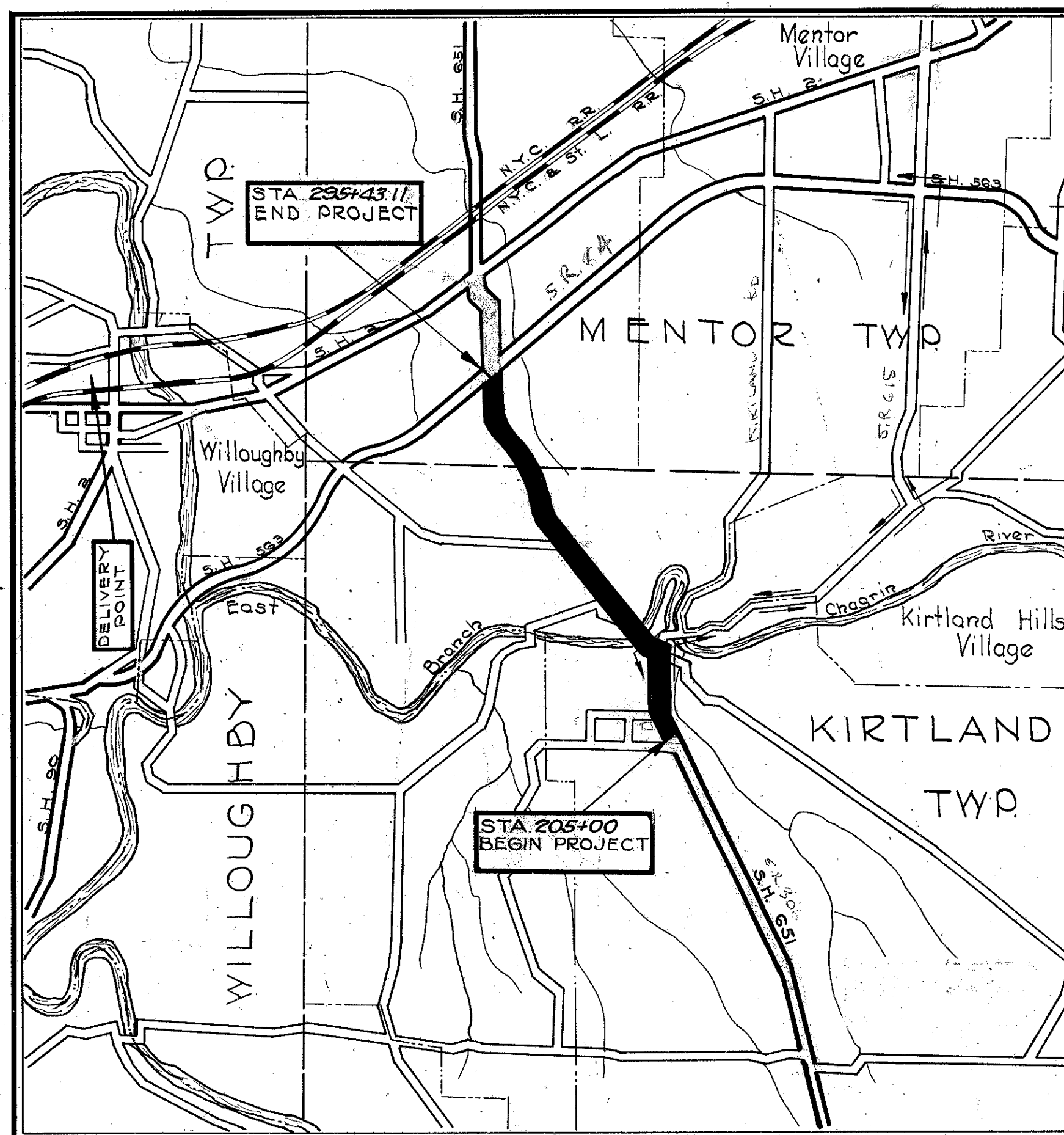

AVERAGE HAUL 4 MILES

LOCATION PLAN

SCALE OF MILES



PORTION TO BE IMPROVED
DETOURS SHOWN THUS
STATE HIGHWAYS
COUNTY ROADS

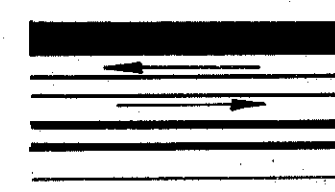

SCALES

PLAN	1"= 100'
PROFILE - VERTICAL	1"= 10'
PROFILE - HORIZONTAL	1"= 100'
CROSS SECTIONS	1"= 5'

- Approved A.B. Wilson
Date 5/2/34 Resident District Deputy Director.
- Approved Wayne Huff
Date 5/31/34 Resident Division Deputy Director.
- Approved _____
Date _____ Chief Engineer, Bureau of Maintenance.
- Approved _____
Date _____ Chief Engineer, Bureau of Bridges.
- Approved Edmer Hilty P.E.
Date 6-1-34 Chief Engineer, Bureau of Construction.
- Approved H.P. Chapman P.E.
Date 6-1-34 First Asst. Director, and Chief Engineer.
- Approved W. Ferrell P.E.
Date 6-1-34 Director of Highways.
- Recommended for Approval _____
Date _____ District Engineer, Bureau of Public Roads.
- Recommended for Approval _____
Date _____ Chief Engineer, Bureau of Public Roads.
- Approved _____
Date _____ Chief of Bureau.

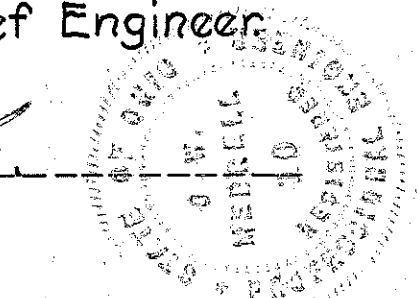

000062

CHECKING RECORD			RECEIVED	APPROVED
OFFICE	BY	DATE	By <u>W. Ferrell</u> Clerk of Sales	By <u>W. Ferrell</u> Planning Engineer
RESIDENT DIVISION			6-2-1934	Date 5-31-1934
BUREAU OF MAINTENANCE				Remarks <u>V.F. 10 Part 8 T-71</u>
BUREAU OF BRIDGES				<u>Grid 2 583</u>
BUREAU OF CONSTRUCTION	G.A.S.	10-6-33	Date	
BUREAU OF PUBLIC ROADS				

FILE NO LAKE COUNTY
S.H. No 651 SEC'S. C (Pt.) & B (Pt.)
1934

Contract No. 5969
Letting Date 6-23-34