

5-11

H-8
F-22

FED. RD. DIST. NO. 10	STATE OHIO	FED. AID PROJECT NRS. 696A	FISCAL YEAR 193	3
LAKE COUNTY				48
S.H. No. 651				
COUNTY Sec. E (Pt.) & B				

SR 293
LAKE SR 306
293 - 6.15±
John E. Morley

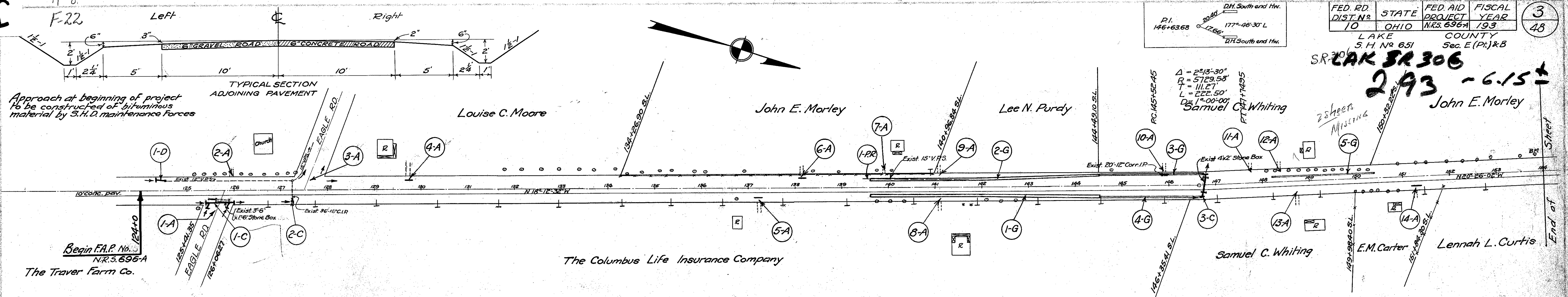

Approach at beginning of project to be constructed of bituminous material by S.H.D. maintenance forces

TYPICAL SECTION ADJOINING PAVEMENT

Begin F.A.P. No. N.R.S. 696-A
The Traver Farm Co.

The Columbus Life Insurance Company

Samuel C. Whiting

E.M. Carter

Lennah L. Curtis

Item No	Station	Removals		Type	Size	Excavation Cu. Yds.	Concrete 1:5 1/2	Reinf. steel Lbs.	V.S.P. (C) Lin. Ft.	V.S.P. (PR) Lin. Ft.	C.I.P. Lin. Ft.	Removal Stone Masonry Cu. Yds.	Old Conc. removed cu. yds.	Ys - 18"x12"	Work Required
		Type	Size												
1-C	125+80A	Stone Box	3.5x1.5	30'	18'x60'	30	3.3	92	20	56	6	30	2	2	Remove 3.5' x 1.5' stone box. Build 18' x 60' pipe culv. 24" to top of.
2-C	127+43				18'x6'	8	1.35	40			6				Place 2-18"x12" Ys + lay 10'-12" Pipe 20" N. and S. of E. on Eagle Rd. Build Hws on ends of 12" C.I.P. culv. inside of walls of stone box culv. Build hws. Rond L.
3-C	146+75				24'x30'	40	2.8	64	20	36	6	50	2	2	Remove parapets and coverstones of exist 4'-2" stone box. Build 24' x 30' C.I.P. culv. inside of walls of stone box culv. Build hws. Rond L.
TOTALS						78	5.45	196	20	92	18	80	4	4	

Note - see note on typical section sheet in regard to R.C.P. as an alternate.

Item No	Station	Rt. of Pipe	Pipe Lin. Ft.	conc. cu. yds.	Rein. steel Lbs.	Remarks
1-D	124+33	LT	20'	0.15		Hw. of 124+33
TOTALS			20'	0.15		

Note - All pipe shall have cemented joints where same are within 25' of trees or where directed by the engineer.

Item No	Station	Rt.	Pipe Lin. Ft.	Remarks
1-PR	139+45	LT	141+73	228'
TOTAL			228'	

Item No	Station	Rt.	Lin. Ft.	Type	Remarks
1-G	139+60	RT	490	I	std. Drwg. I-146
2-G	139+60	LT	490	I	std. Drwg. I-146
3-G	144+50	LT	225	3	Std. Drwg. I-146
4-G	144+50	RT	225	3	Std. Drwg. I-146
5-G	148+20	LT	220	2	curb and gutter (Std. Drwg. I-12 C.C.)
TOTALS			980'		447' outlet, 220' curb + gutter.

Item No	Station	Rt.	PRIVATE DRIVES & ROAD APPROACHES	
			corr. 18" Lid. Ft.	Place
1-A	125+70	RT	10	10
2-A	125+95	LT		3
3-A	127+70	LT		10
4-A	129+70	LT	20	3
5-A	137+22	RT	20	3
6-A	138+15	LT	20	3
7-A	139+90	RT		3
8-A	141+10	RT		3
9-A	141+10	LT		3
10-A	145+90	LT	20	3
11-A	147+17	LT		3
12-A	148+35	LT		3
13-A	148+75	RT		3
14-A	151+25	RT	20	3
TOTALS			40	56

Remove 20'-12" corr. at Sta 145+90 Lt.

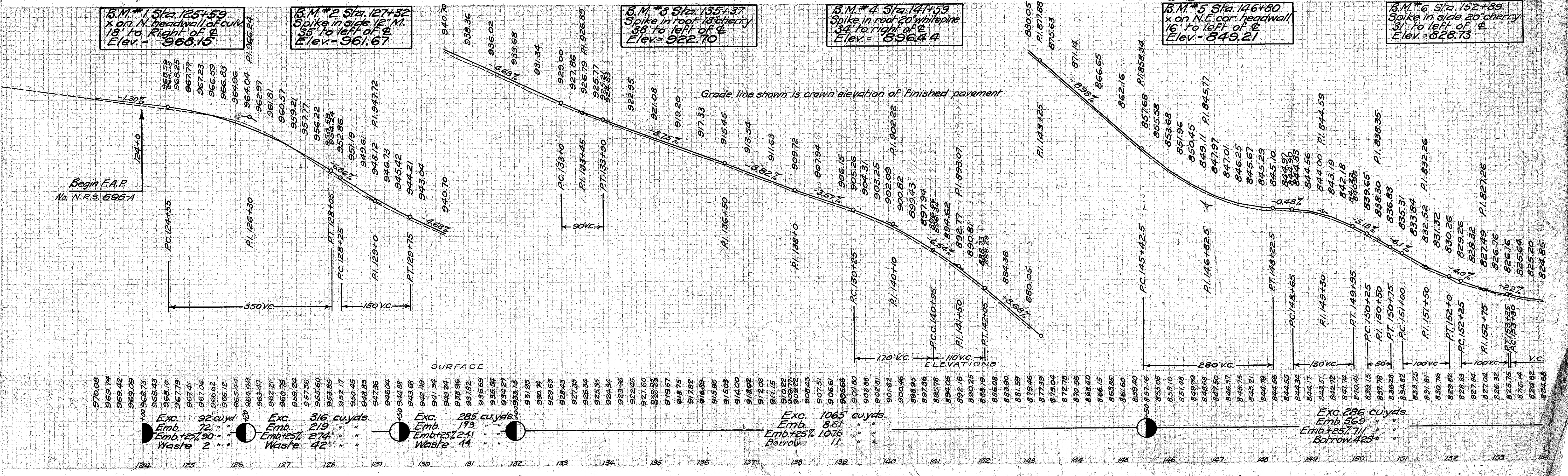

Exc. 92 cu. yds.
Emb. 219 " "
Waste 2 " "

Exc. 316 cu. yds.
Emb. 219 " "
Waste 42 " "

Exc. 285 cu. yds.
Emb. 173 " "
Waste 44 " "

Exc. 1065 cu. yds.
Emb. 861 " "
Waste 11 " "

Exc. 286 cu. yds.
Emb. 569 " "
Waste 257 " "
Borrow 425 " "