

STATE OF OHIO
DEPARTMENT OF TRANSPORTATION
LAK - 283 - 7.97
CITIES OF MENTOR & MENTOR-ON-THE-LAKE
LAKE COUNTY

PID NO. 11967
TEA

DESIGN DESIGNATION

Current Year 1997	=12,270
Design Year 2017 A.D.T.	=14,655
D.H.V.	= 1,466
D	= 50%
T	= 4%
V	=40MPH
LEGAL SPEED	=35MPH
FUNCTIONAL CLASSIFICATION	URBAN COLLECTOR
DESIGN EXCEPTION	NONE
BICYCLE DESIGN SPEED	=20MPH

CONVENTIONAL SIGNS

County Line	-----	Limited Access (only)	LA
Township Line	-----	Right of Way (only)	RW
Section Line	-----	Limited Access & Right of Way	LA & RW
Corporation Line	-----	Existing Right of Way	
Fence Line (existing) - x - x - x	(proposed) - x - x - x	Property Line (in existing fence)	x - x - x
Center Line	-----	Railroad	----- or -----
Trees	⊗, ⊙, ⊕, ⊖, ⊗, ⊙, ⊕, ⊖	Guardrail (exist.)	○ (prop.)
Utility Poles: Telephone	⊕, Power	Manholes (exist.)	○ (adjst.) ⊙ (prop.)
		Catch or Inlet Basins (exist.)	⊠ (adjst.) ⊡ (prop.)

INDEX OF SHEETS

TITLE SHEET	.1
SCHEMATIC PLAN	2
TYPICAL SECTIONS	3-6
GENERAL NOTES	7-8
MAINTENANCE OF TRAFFIC NOTES	9
GENERAL SUMMARY	10-12
PLAN & PROFILES	13-33
CROSS SECTIONS	34-73
DRIVEWAY PROFILES	74-78
DRIVEWAY SCHEDULE AND DETAILS	79-80
PAVEMENT DETAILS	81
DRAINAGE DETAILS	82
SANITARY DETAILS	83
PAVEMENT MARKING DETAILS	84-96
SIGNING PLAN	97-104

MICROFILMED
JUL 21 1999

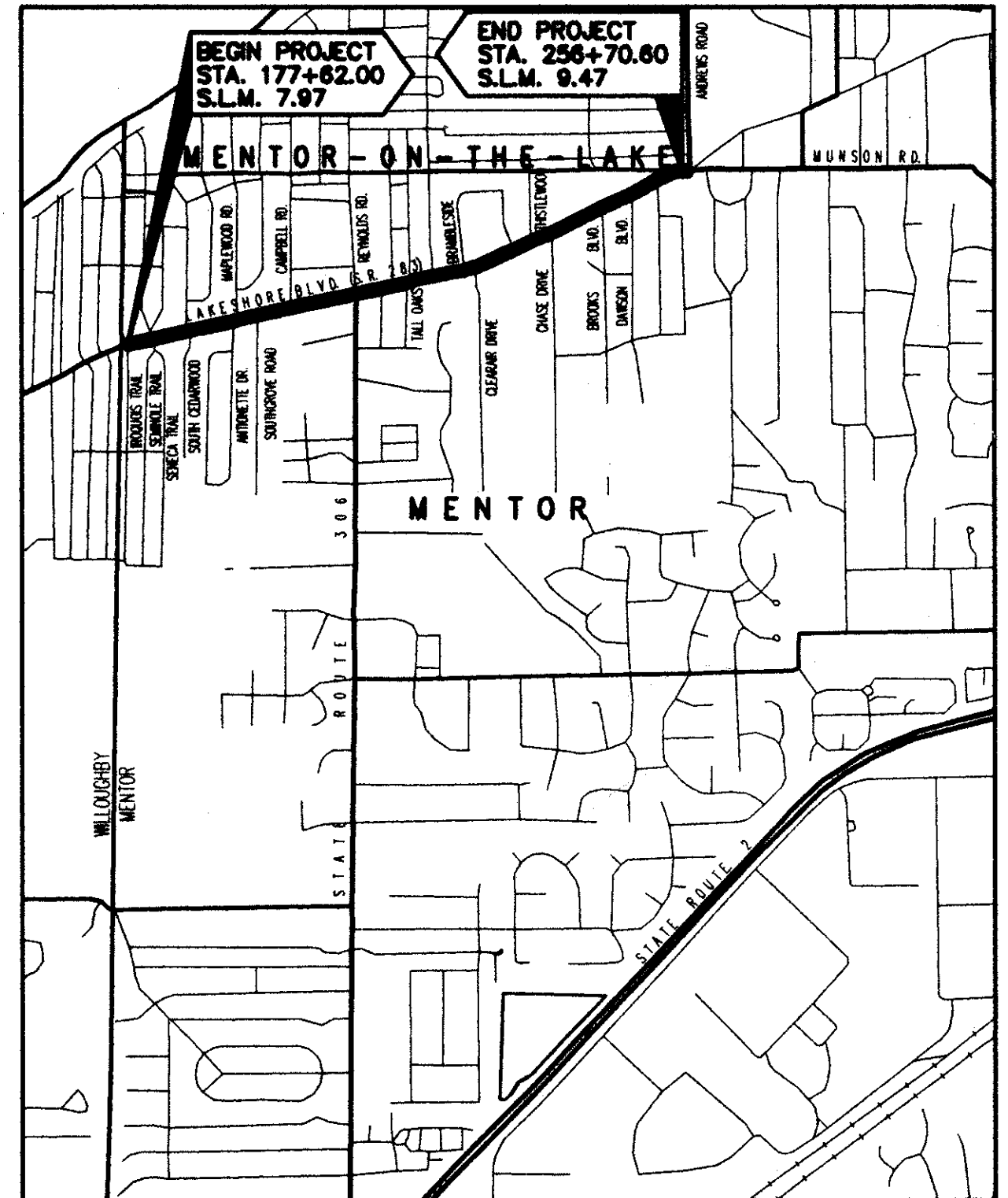

LOCATION MAP

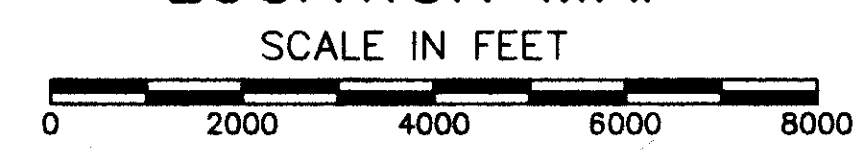

Portion to be improved	=====
State & Federal Routes	=====
Other Roads	-----

SCALES

Plan	-----	0 20 40
Profile	Horizontal	0 20 40
	Vertical	0 10 20
Cross Section:	Horizontal	0 10 20
	Vertical	0 10 20

UNDERGROUND UTILITIES
TWO WORKING DAYS
BEFORE YOU DIG
CALL 800-382-2764 (TOLL FREE)
OHIO UTILITIES PROTECTION
SERVICE
NON-MEMBERS
MUST BE CALLED DIRECT

SUPPLEMENTAL SPECIFICATIONS	
806	9-09-97

LINE DATA

BEGIN PROJECT	STA. 177+62.00
END PROJECT	STA. 256+70.60
LENGTH OF PROJECT	7908.60 L.F. or 1.50 MILES
ADD FOR WORK STA. 146+25 TO STA 150+20 (S.R. 306)	500.00 L.F.
LENGTH OF WORK	8408.60 L.F. or 1.593 MILES

SUPPLEMENTAL PRINTS OF STANDARD CONSTRUCTION DRAWINGS

BP-1.1	2-21-92	CB-1.1M	7-12-95	RM-1.1M	4-8-97	TC-21.20	9-01-92	TC-71.10	9-10-91
BP-1.2	2-21-92	CB-2.1M	7-12-95	DM-1.1M	10-21-97				
BP-2.1M	4-8-97	CB-2.2M	7-12-95	MC-8	6-12-75	TC-41.10	8-29-84	TC-81.20	1-20-84
BP-2.5M	4-8-97	CB-6	5-01-79	DM-4.3M	6-30-95	TC-41.20	6-21-94	TC-82.10	8-29-84
BP-3.1	2-21-92					TC-41.40	6-16-79		
BP-5.1	10-28-94	I-1	12-18-84	MT-95.31	10-10-88	TC-42.20	3-26-79	TC-83.20	1-20-84
BP-7.1	10-30-92			MT-97.10	4-29-88				
				MT-97.11	10-04-89	TC-52.10M	7-29-94	TC-85.10	1-20-84
						TC-52.20M	7-29-94	TC-85.20	1-20-84
		MH-1	12-18-84	MT-99.20	4-29-88				
		MH-1.2M	9-6-95	MT-105.10	7-1-92	TC-65.10M	11-01-95		
				MT-105.11	7-1-92	TC-65.12M	11-01-95		
						TC-65.13M	11-03-93		

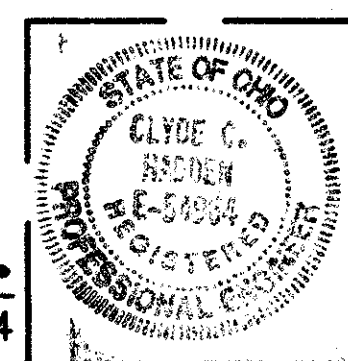

Project: _____
Date of Letting: _____ 19 ____ Contract No. _____
CLYDE C. HADDEN P.E. No. 54964

Approved: *[Signature]*
Date: 11/25/98 District Deputy Director of Transportation

Approved: *[Signature]*
Date: 3-5-98 Director, Department of Transportation

DEPARTMENT OF TRANSPORTATION
FEDERAL HIGHWAY ADMINISTRATION

APPROVED _____

DIVISION ADMINISTRATOR _____ DATE _____

LAK-283-7.97
980388
104PDS
06-10-98
DIST. 12

COPYRIGHT - DATE: 01-09-98 08:16 CT CONSULTANTS, INC. H:\CT\283\7.97\WTL.DWG