

PAVEMENT DETAILS

REF	LOCATION	PAVEMENT															
		301	304	402	310	404	407	407	408	409	409	411	452	609	403	408	202
		Bituminous Aggregate Base AC-20	Aggregate Base	Asphalt Concrete AC-20	6" Subbase Type II	Asphalt Concrete AC-20	Cover Aggregate	Tack Coat	Bituminous Prime Coat	Seal Coat Bituminous Material	Seal Coat Cover Aggregate, No. 8	Stabilized Crushed Aggregate	8" Plain Portland Cement Concrete Pavement	Curb, Std Type G. Mod. Per Plan	Asphalt Conc. AC-20	Cover Aggregate	Wearing Course Removed
		Cu.Yd.	Cu.Yd.	Cu.Yd.	Cu.Yd.	Cu.Yd.	Tons	Gal.	Gal.	Gal.	Cu.Yd.	Cu.Yd.	Sq.Yd.	Lin.Ft.	Cu.Yd.	Cu.Yd.	Sq.Yd.
P.1	Sta. 5+30												9				
P.2	Sta. 7+85 to Sta. 8+90												16				
P.3	Sta. 12+90												15				
P.4	Sta. 14+33												10				
P.5	Sta. 12+00											32					
P.6	Sta. 4+30 to Sta. 8+90		90					163	122	3						3	
P.7	Sta. 11+50 to Sta. 15+50		67					120	90	2						3	
P.8	Sta. 11+50 to Sta. 12+25												75				
P.9	Sta. 4+30 to Sta. 8+90	131		65	151	46	4	151							35		
P.10	Sta. 11+50 to Sta. 15+50	122		73	143	52	3	133							30		
P.11	Erie Road																60
	Totals	253	157	138	294	98	7	284	283	212	5	50	32	75	65	6	60

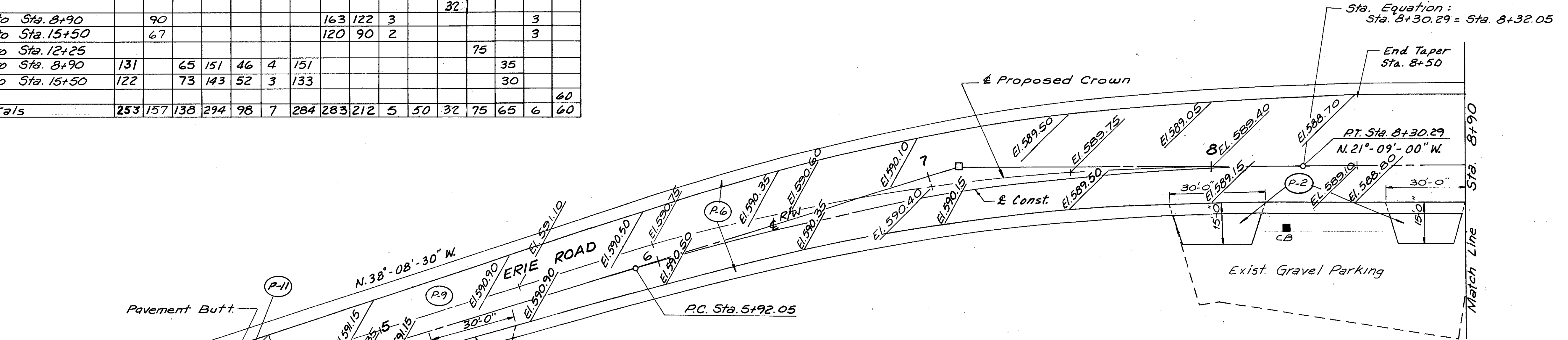
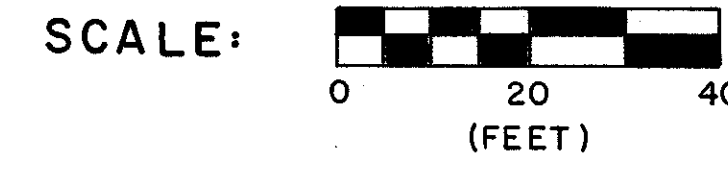

ERIE RD. - MISCELLANEOUS DATA

Station	Pavem't. Edge Rt.	Pavem't. Edge Lt.	Proposed Crown	Station	Pavem't. Edge Rt.	Pavem't. Edge Lt.	Proposed Crown
4+30	4.5'	15.0'	*	11+50	13.0'	24.8'	± R/W
4+50	4.9'	15.5'	5.5' Lt.	12+00	13.5'	22.3'	0.5' Rt.
5+00	5.9'	16.7'	5.5' Lt.	12+50	14.0'	19.8'	1.0' Rt.
5+50	6.9'	17.9'	5.5' Lt.	13+00	14.5'	17.3'	1.5' Rt.
6+00	7.9'	19.0'	5.2' Lt.	13+50	15.0'	14.8'	2.0' Rt.
6+50	8.9'	20.2'	4.2' Lt.	14+00	15.5'	12.4'	2.5' Rt.
7+00	10.0'	21.4'	3.1' Lt.	14+50	16.0'	9.9'	3.0' Rt.
7+50	11.0'	22.6'	2.1' Lt.	15+00	16.5'	7.4'	4.5' Rt.
8+00	12.0'	23.8'	1.0' Lt.	15+50	17.0'	5.0'	*
8+50	13.0'	25.0'	± R/W				

* Meet Existing Pavement

Begin Work & Taper Sta. 4+30

