

LAKE COUNTY
SH 520-SEC. PAINESVILLE (PT.)
GRADE SEPARATION
LAK 283

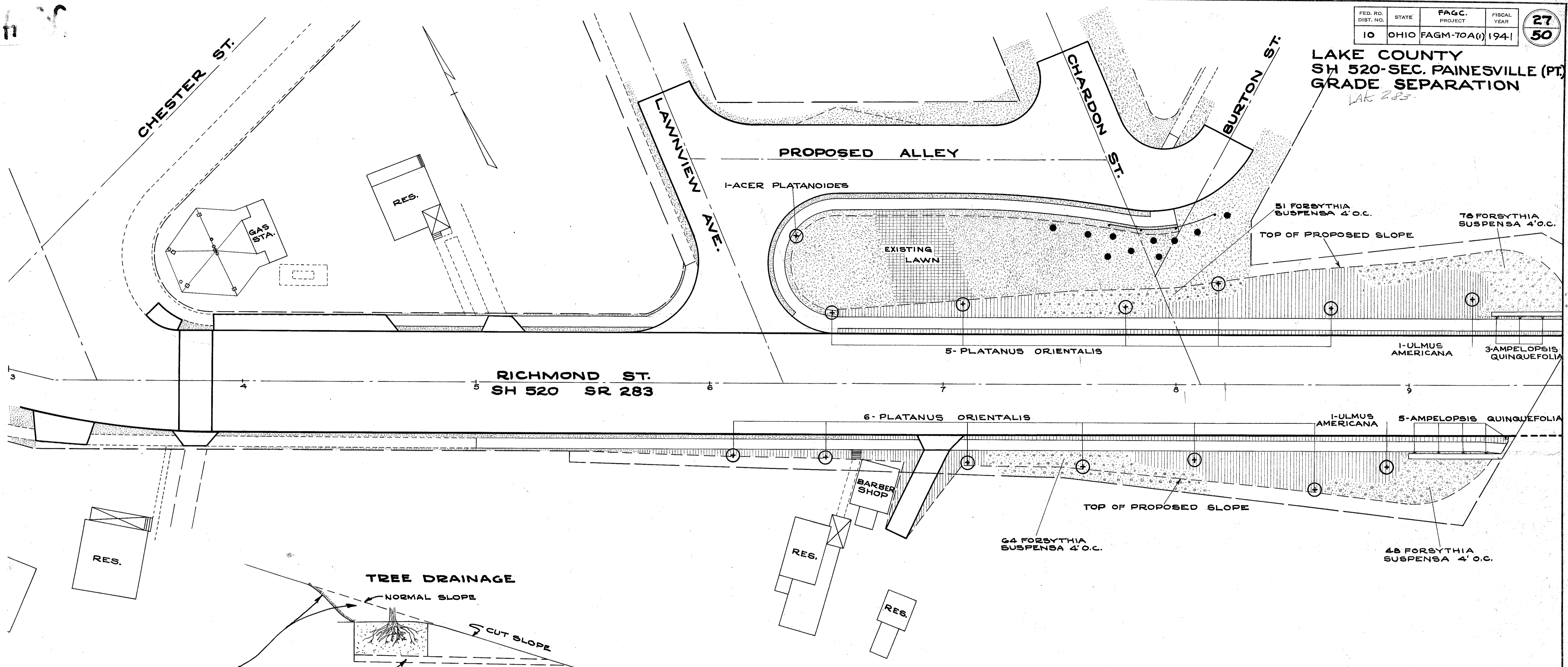

TREE DRAINAGE

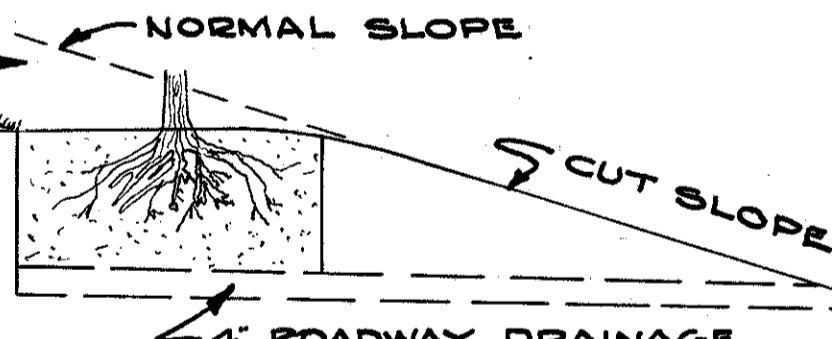

2 SQ. YDS. OF SOD TO BE PROVIDED FOR TREES PLANTED ON SEEDED SLOPE AREAS. METHOD OF GRADING AND USE OF SOD WHERE SUCH TREES ARE CONCERNED IS SHOWN IN SKETCH ABOVE.

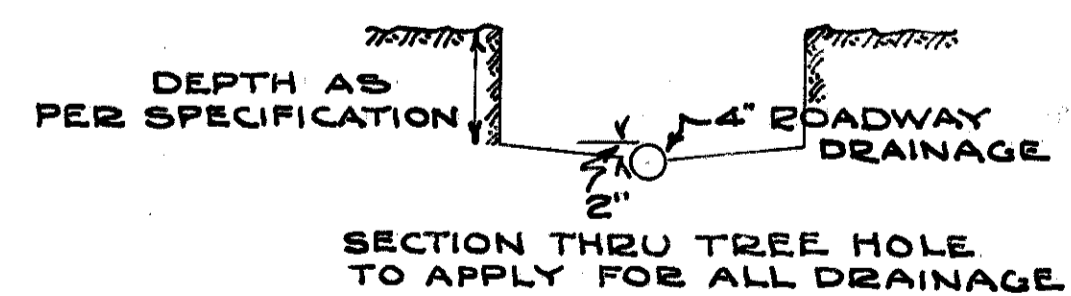

METHOD OF STRING & PEG FASTENING

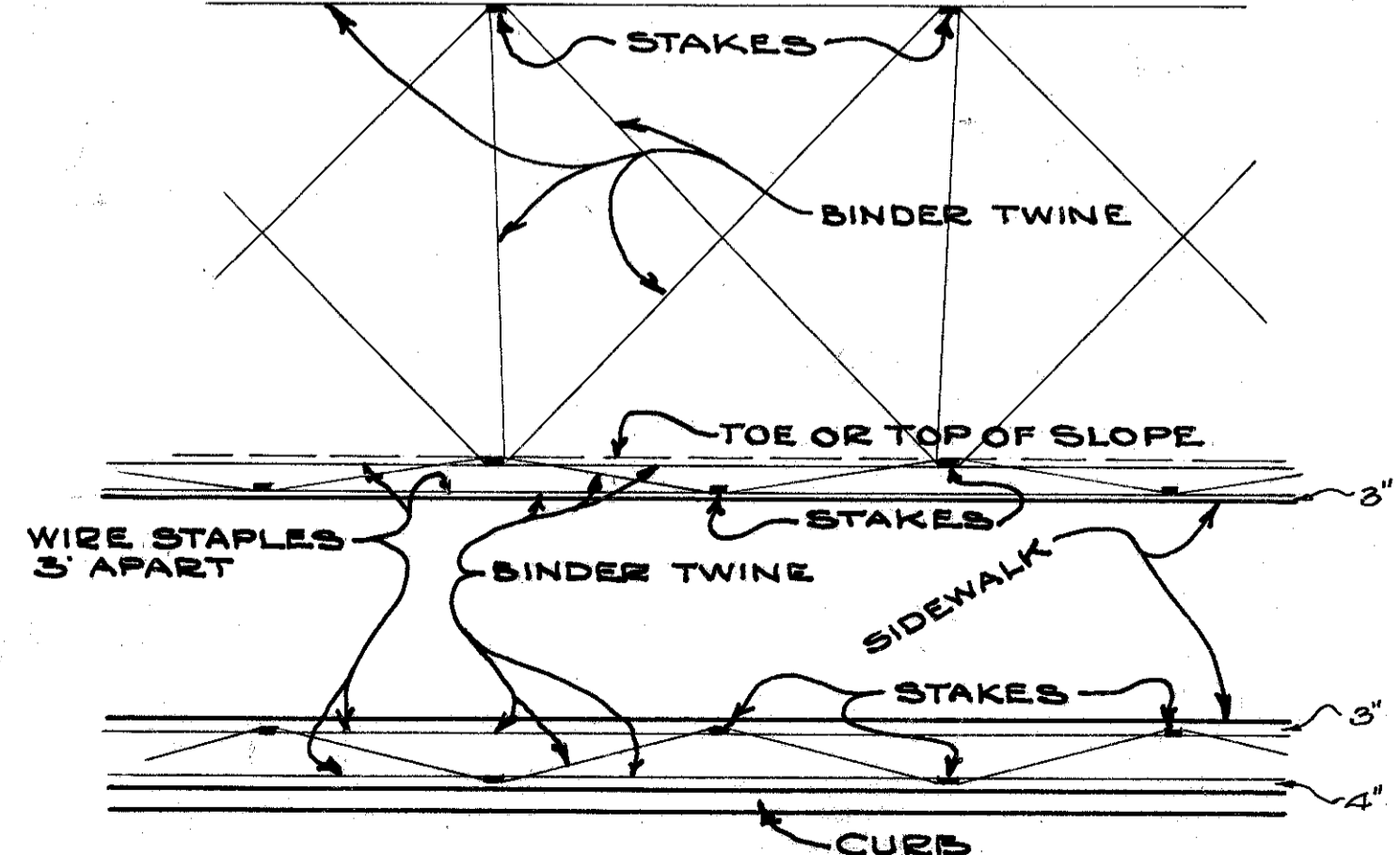

NOTES

WIRE STAPLES - 6" LONG OF NO. 9 GAUGE WIRE.
STAKES - 6" TO 8" LONG, SPACED 15" MAXIMUM AND STAGGERED AS PER SKETCH - MORE STAKES REQUIRED ON WIND SWEEP SLOPES.
BINDER TWINE - WEAP TWICE AROUND STAKES THEN DRIVE STAKE FLUSH WITH GROUND TO HOLD LOOPS FIRMLY IN PLACE.

SHEET SUMMARY		STA. 3+00 TO STA. 9+66	
SYMBOL	QUAN.	UNIT	ITEM
⊙	11	EACH	PLATANUS ORIENTALIS-ORIENTAL OR EUROPEAN PLANTREE 2-2 1/2" CAL.
⊙	2	"	ULMUS AMERICANA -WHITE OR AMERICAN ELM 2-2 1/2" CAL.
⊙	1	"	ACER PLATANOIDES-NORWAY MAPLE 2-2 1/2" CAL.
●	10	"	CRATAEGUS CORDATA-WASHINGTON HAWTHORN 5-6' B&B(20')
▨	1670	SQ.YD.	SEEDING
▨	830	"	SODDING
▨	1670	"	STRAW MULCHING
▨	22.5	M.SQ.FT.	RENOVATING EXISTING SOIL
▨	450	LBS.	10-6-4 COMMERCIAL FERTILIZER (@ 20 LBS.PER. M-S.F)
⊙	241	EACH	FORSYTHIA SUSPENS A-WEeping FORSYTHIA 3'-4'
⊙	8	"	AMPELOPSIS QUINQUEFOLIA-VIRGINIA CREEPER 3-YR.
▨	150	S.Y.	RENOVATING EXISTING SOD
▨	140	L.F.	4" ROADWAY DRAINAGE (EST.)