

91-5

MICROFILMED
SEP 6 1965

FED. RD. DIVISION	STATE	PROJECT	TYPE FUNDS
2	OHIO	I-1103(18)	385 458

3.61 MI. NORTH OF MAYFIELD HEIGHTS
CUYAHOGA & LAKE COUNTIES
LAK-1-0.00
CUY-1-15.91

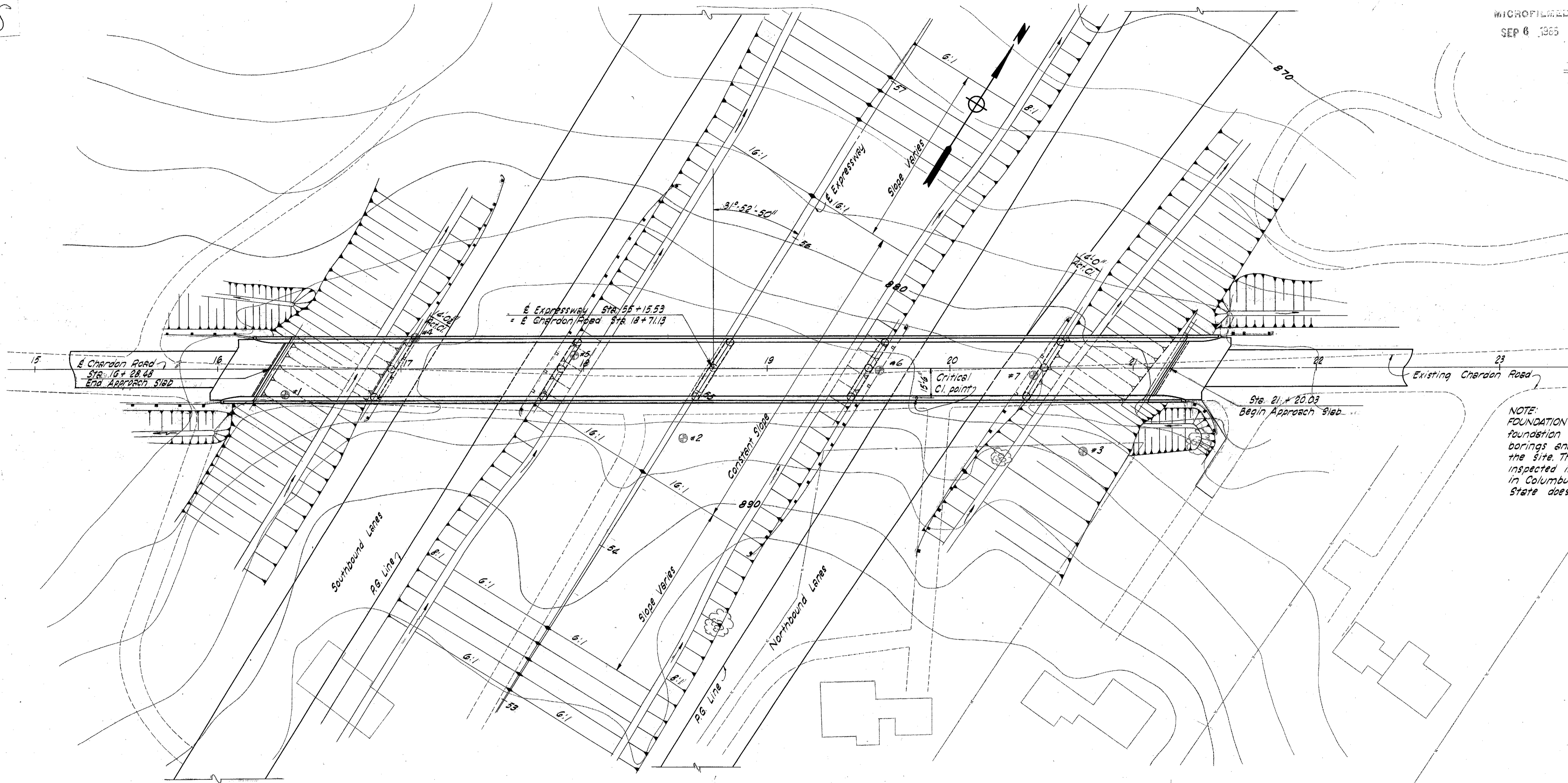

NOTE:
FOUNDATION SOUNDINGS: Foundation design and foundation quantities are based on a study of borings and soil-sampling soundings made at the site. This sounding information may be inspected in the office of the Bureau of Bridges in Columbus or in the Division Office, but the State does not guarantee the accuracy thereof.

⊙ Denotes Boring Location

CHARDON RD. A.D.T. 4,880 (1975)

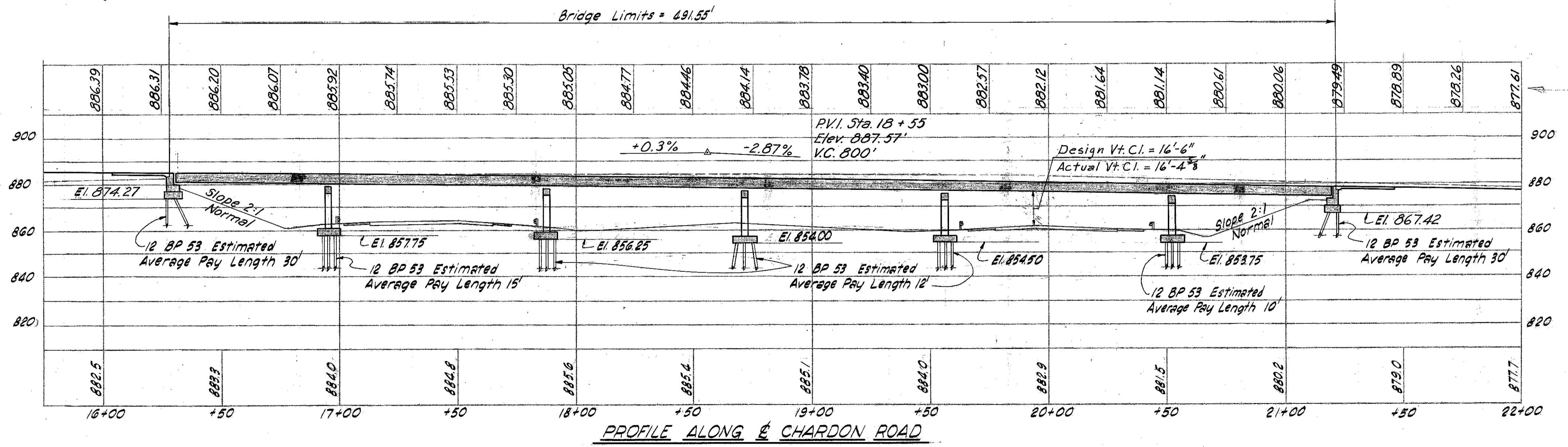

PROPOSED STRUCTURE

TYPE: Continuous welded steel plate girders with reinforced concrete deck and substructure.
 SPANS: 64'-92'-84'-84'-95'-25'-67' % Bearings
 ROADWAY: 30'-0" 4'; 2'-2" Safety Curbs
 LOAD FREQUENCY: C.F. = 400(57)
 SKEW: 31°-52'-50" (L.F.)
 WEARING SURFACE: 1" Monolithic Concrete
 APPROACH SLABS: Special Design (25' Long)
 ALIGNMENT: Tangent
 SUPERELEVATION: None

MICHAEL BAKER JR., CONSULTING ENGINEERS
ROCHESTER, PENNSYLVANIA

SITE PLAN
BRIDGE NO. LAK-1-0106
UNDER CHARDON ROAD
LAKE COUNTY
SCALE 1"=30' STA. 55+15.53

PRESENT	TOPOGRAPHY	PROPOSED	WORK
Surveyed	Drawn	Designed	Drawn
M.B., Jr.	W.A.J.	J.C.B., Jr.	P.W.F., R.E.H.
			Checked
			DE.B.
			Reviewed
			H.G.H.
			10-18-59

Sheet 1 of 8 Revised 4-19-60

59-B-167