

FED. RD. DIVISION	STATE	PROJECT	
2	OHIO	T-1103 (18)	363 458

CUYAHOGA & LAKE COUNTIES
 CUY-1-15.91
 LAK-1-0.00

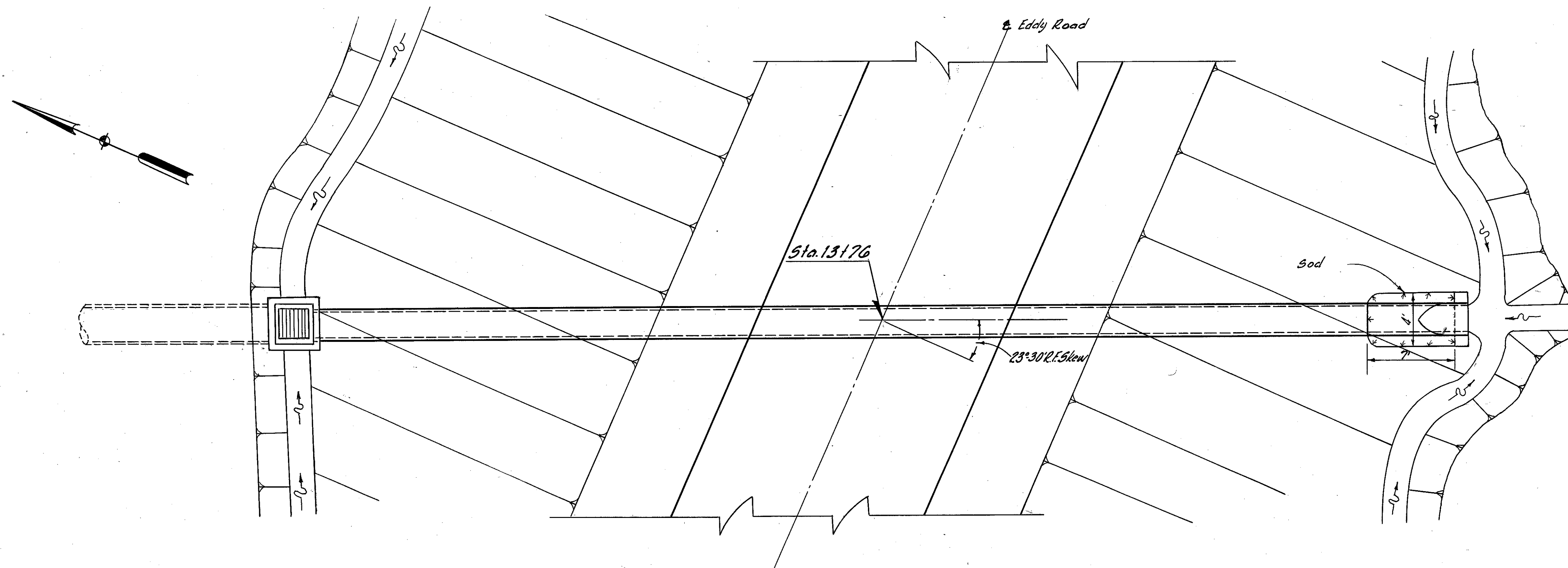

Area = 6 Acres
 Discharge = 18 C.F.S.

Headwater = 2.8'
 Outlet Velocity = 13 F.P.S.

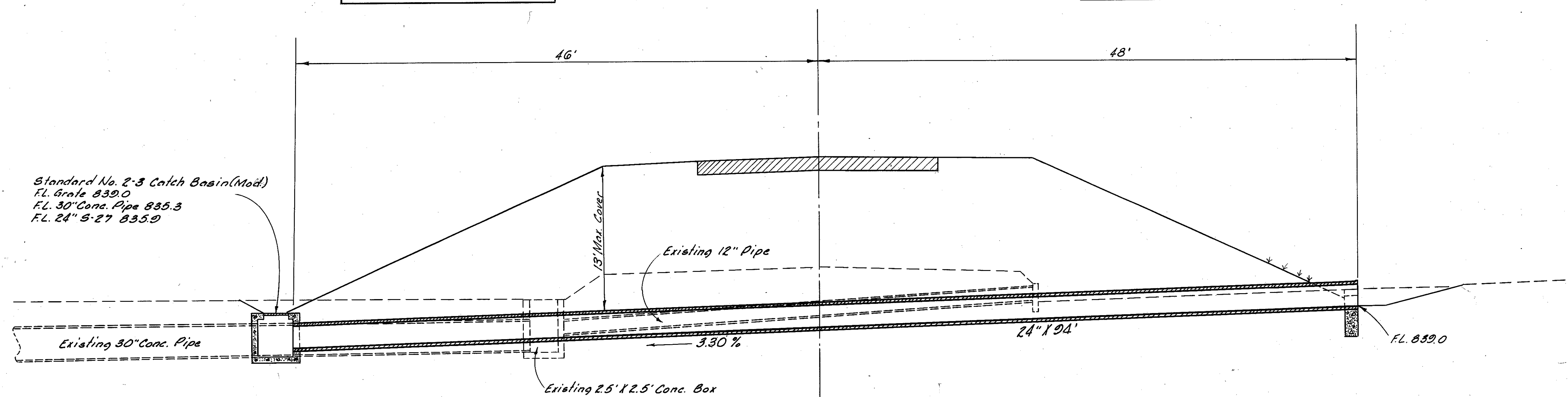

Standard No. 2-3 Catch Basin (Mod.)
 FL. Grate 839.0
 FL. 30" Conc. Pipe 835.3
 FL. 24" 5-27 835.9

ESTIMATED QUANTITIES

E-2	Excavation for Structures	47	Cu. Yds.
S-1	Concrete for Structures Class "E"	0.41	Cu. Yds.
5-27	24" Pipe for Roadway Culverts	94	Lin. Ft.
I-8	Standard No. 2-3 Catch Basin	1	Each
L-10	Sodding	3	Sq. Yds.

CULVERT DATA

TYPE: 5-27 Pipe, Culvert Sec. M-6.8 (b) or M-6.6 (b)
 Standard No. 2-3 C.B. Lt. & 5-27, PC-4 Headwall Rt.
 SIZE: 24" x 24"

REVISIONS: 3-31-60 Grade Raise for 16'-4" Br. Cl.

MICHAEL BAKER JR., CONSULTING ENGINEERS
 ROCHESTER, PENNSYLVANIA

STATE OF OHIO
 DEPARTMENT OF HIGHWAYS
 STATE HIGHWAY NO. 1
 C-42
 CULVERT SECTION
 EDDY ROAD-STA. 13+76

Designed	Drawn	Traced	Checked	Reviewed Date	Revised
L.S.I.	L.S.I.	E.P.C. K.L.G.	B.P.		

Scale: 1" = 5'