

CUYAHOGA & LAKE COUNTIES
 CUY-I-15.91
 LAK-I-0.00

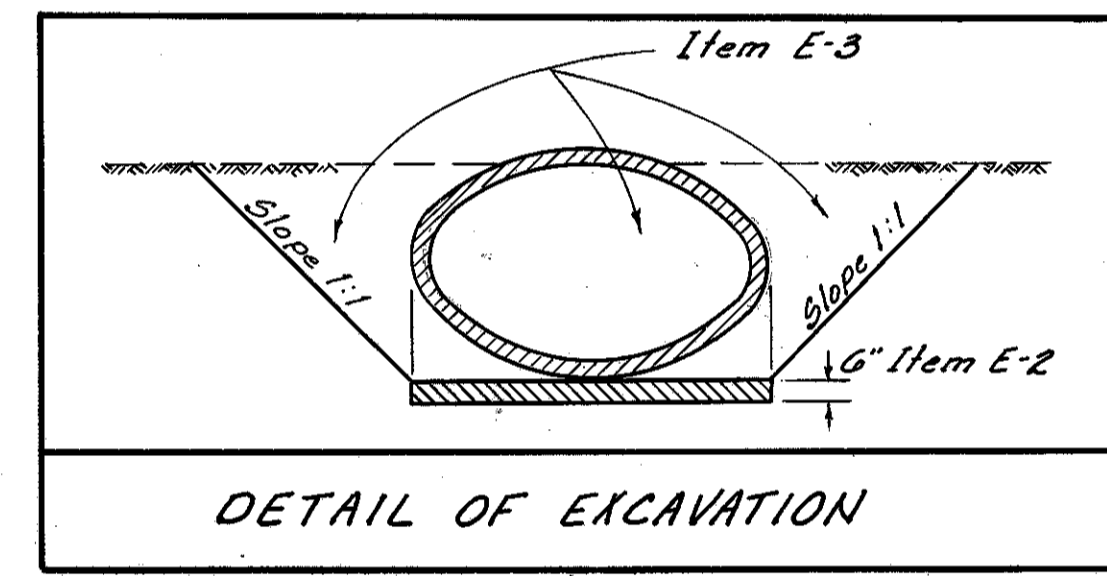

Area = 317 Acres
 Q50 = 200 C.F.S.

Headwater = 4.92'
 Outlet Velocity = 8 F.P.S.

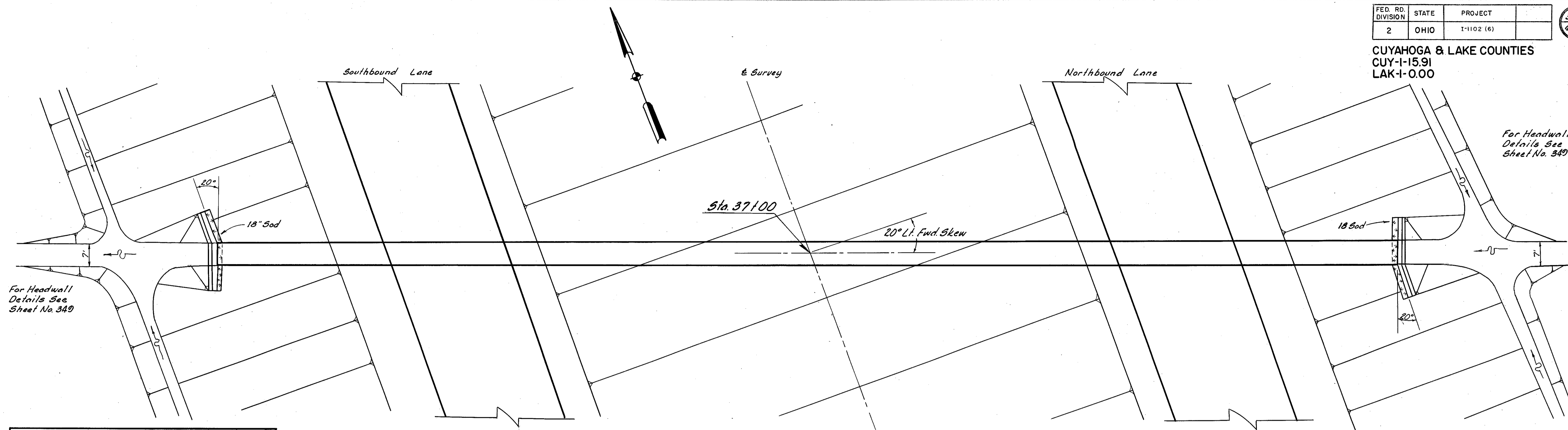
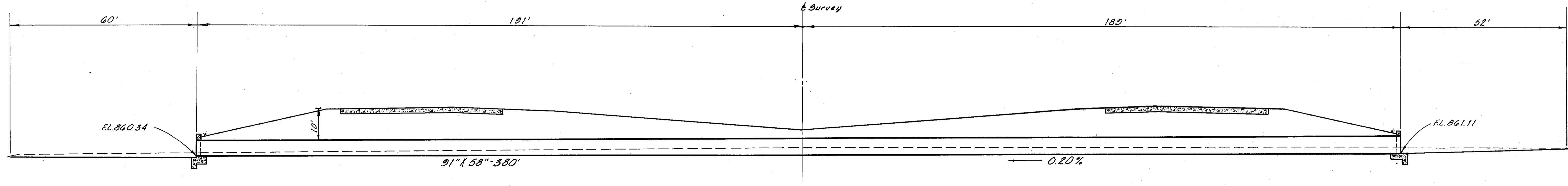

ESTIMATED QUANTITIES

* E-2	Excavation for Structures	79	Cu. Yds.
E-3	Channel Excavation	250	Cu. Yds.
S-1	Concrete for Structures Class "C"	39	Cu. Yds.
S-4	Reinforcing Steel	1498	Lbs.
S-27	91"x58" Pipe for Roadway Culverts	380	Lin. Ft.
L-10	Sodding	9	Sq. Yds.

CULVERT DATA

TYPE: Elliptical Pipe Culvert S-27 Sec. M-20G.G(b)
 Type "B-1" Headwall
 SIZE: 91" x 58" - 380'

* STRUCTURE EXCAVATION FOR HEADWALLS INCLUDED

CULVERT NO. LAK-I-0070 Scale: 1"=15'

MICHAEL BAKER JR., CONSULTING ENGINEERS
 ROCHESTER, PENNSYLVANIA

STATE OF OHIO
 DEPARTMENT OF HIGHWAYS
 STATE HIGHWAY NO. 1
 C-41
 CULVERT SECTION
 STA. 37+00

Designed	Drawn	Traced	Checked	Reviewed	Date	Revised
L.S.I.	L.S.I.	E.P.C. K.L.G.	B.P.			