

91-5 S-16

CUY-271-H.09
LAK-271-0.00

FED. RD. DIVISION	STATE	PROJECT
2	OHIO	I-1102 (6)

351
458

CUYAHOGA & LAKE COUNTIES
CUY-I-15.91
LAK-I-0.00

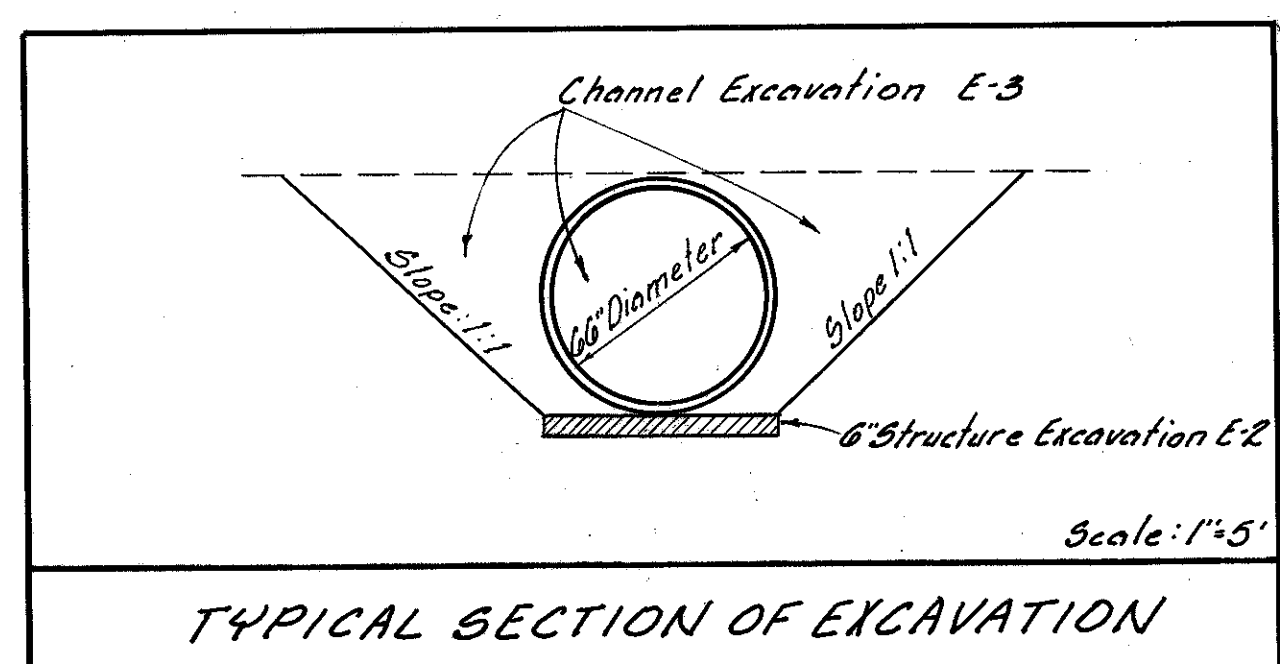
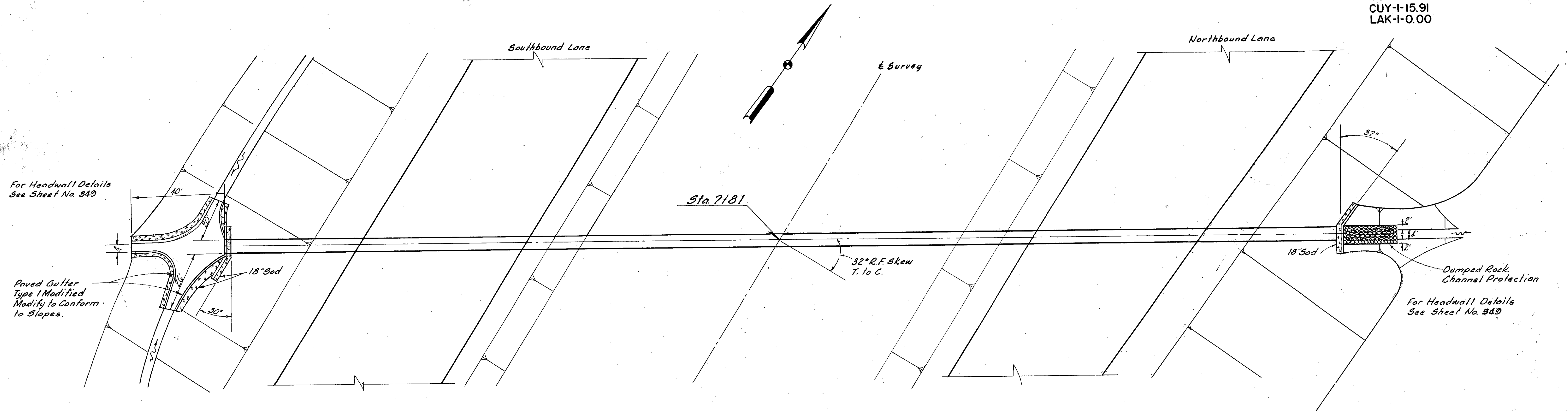

Area = 316 Acres
Q50 = 284 C.F.S.

Headwater = 7.15'
Outlet Velocity = 13.5 F.P.S.

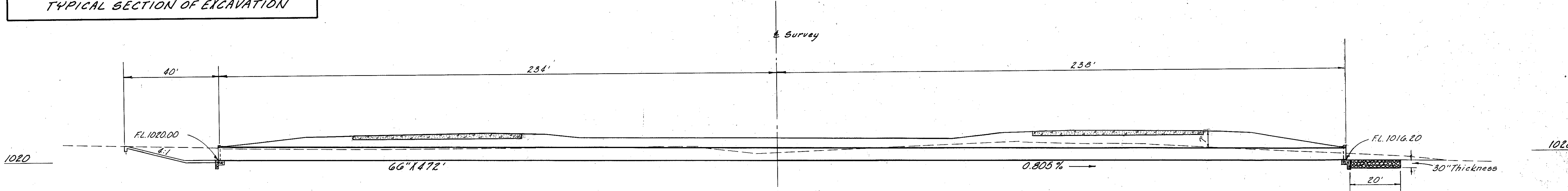

ESTIMATED QUANTITIES

* E-2 Excavation for Structures	113	Cu Yds.
E-3 Channel Excavation	1289	Cu Yds.
S-1 Concrete for Structures Class "C"	40	Cu Yds.
S-4 Reinforcing Steel	1088	Lbs.
S-27 66" Pipe for Roadway Culverts	472	Lin. Ft.
I-14 Paved Gutter, Type 1 Modified	84	Lin. Ft.
I-10 Dumped Rock Channel Protection	11	Cu Yds.
L-10 Sodding	30	Sq. Yds.

CULVERT DATA
TYPE: Pipe Culvert S-27 Sec. M-G.G (b)
"8-1" Headwall
SIZE: 66" X 472'

* EXCAVATION FOR HEADWALLS INCLUDED

CULVERT NO. CUY-I-1606 Scale: 1"=20'

MICHAEL BAKER JR., CONSULTING ENGINEERS
ROCHESTER, PENNSYLVANIA

STATE OF OHIO
DEPARTMENT OF HIGHWAYS
STATE HIGHWAY NO. 1
C-41
CULVERT SECTION
STA 7+81

Designed	Drawn	Traced	Checked	Reviewed/Date	Revised
L.S.T.	L.S.T.	E.R.C. K.L.G.	B.P.		