

CUYAHOGA & LAKE COUNTIES
CUY-I-15.91
LAK-I-0.00

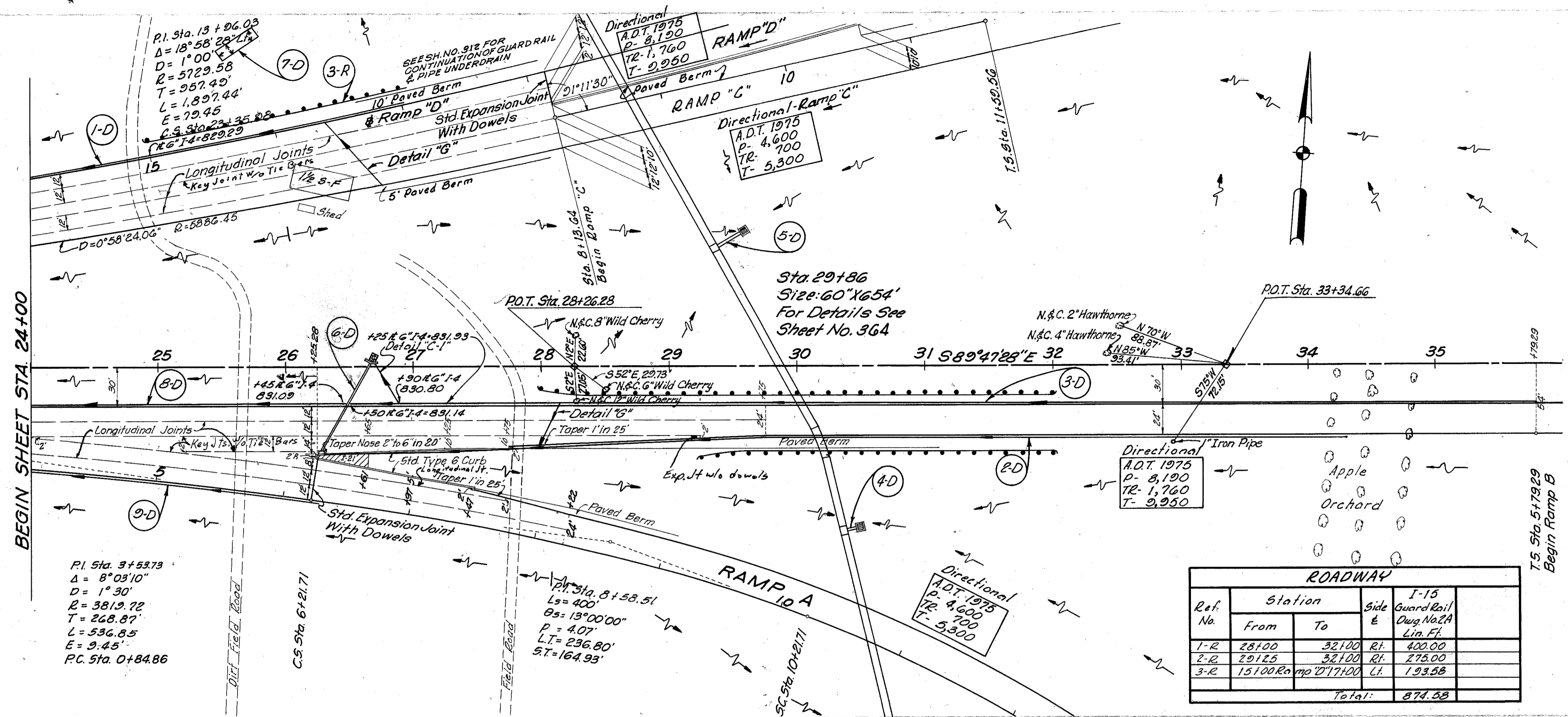

Ref. No.	Station		Side	I-15 Guard Rail Dig. No. 2A Lin. Ft.
	From	To		
1-R	28+00	32+00	RT.	400.00
2-R	29+25	32+00	RT.	275.00
3-R	15+00	Ramp D 17+00	LT.	193.58
Total:				874.58

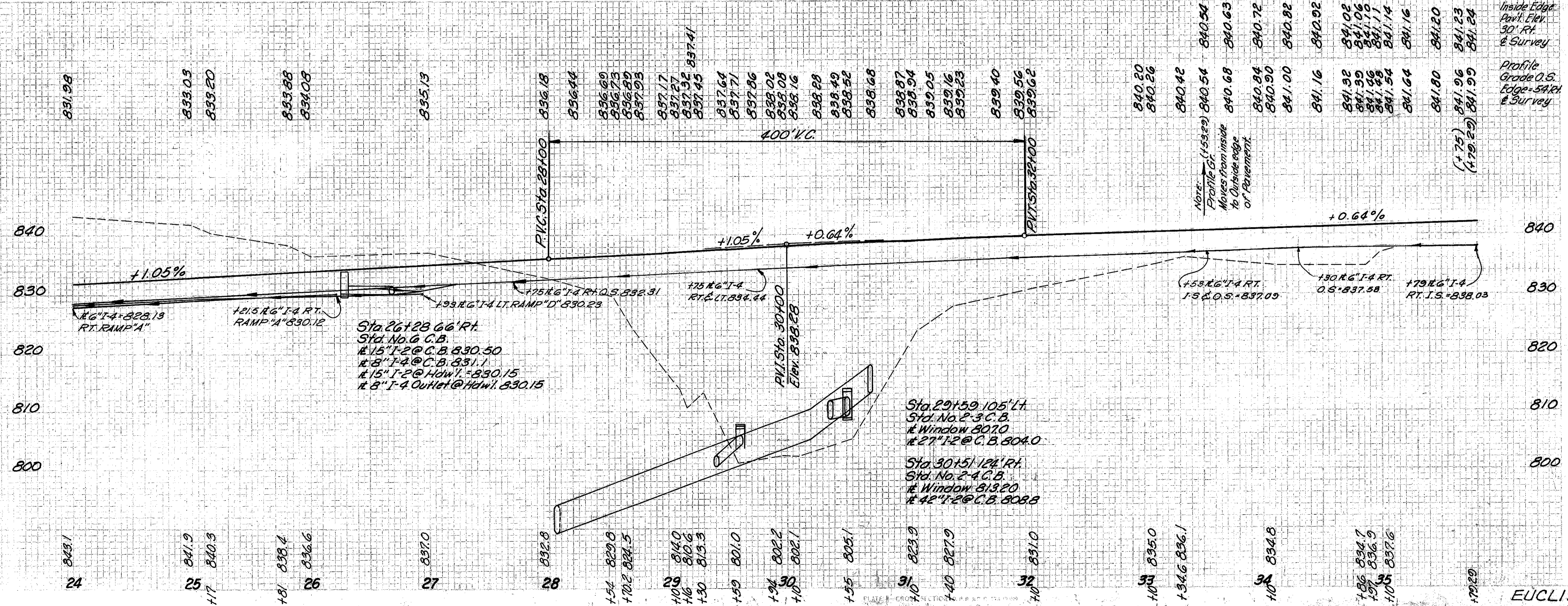

Station	Ref. No.	From		To	Side	Excavation for Structures	Storm Sewer	Underdrain	Pipe Culverts	Pipe Specials for Underdrains	Catch Basin	Standard No. 4	Catch Basin	Standard No. 6	Dumped Rock Channel Protection	Sodding	Concrete for Structures	Reinforcing Steel
		1-D	1-R															
24	344	1-D	24+00	24+10	LT.													
25	344	1-D	26+10	26+20	RT.													
26	343	3-D	26+50	26+70	RT.													
27	278	1-D	29+50	29+50	RT.													
28	274	1-D	28+25	28+25	RT.													
29	274	1-D	28+25	28+25	RT.													
30	274	1-D	28+25	28+25	RT.													
31	274	1-D	28+25	28+25	RT.													
32	274	1-D	28+25	28+25	RT.													
33	274	1-D	28+25	28+25	RT.													
34	274	1-D	28+25	28+25	RT.													
35	274	1-D	28+25	28+25	RT.													
36	274	1-D	28+25	28+25	RT.													

REVISIONS:
3-31-00 Grade Raise for 16'-4" Br. C.I.

MICHAEL BAKER JR., CONSULTING ENGINEERS
ROCHESTER, PENNSYLVANIA

STATE OF OHIO
DEPARTMENT OF HIGHWAYS
STATE HIGHWAY NO. 1
C-42
EUCLID SPUR - PLAN & PROFILE
STA. 24+00 TO STA. 36+00

Designed	Drawn	Traced	Checked	Reviewed	Date	Revised
H.V.	A.H.	A.G.	L.I.			