

Station	Offset Dist. to Lt. & Rt.
23+42	6.33
+50	6.12
+75	6.65
24+00	6.82
+25	6.94
+50	6.99
+62.00	7.00

P.I. opposite Sta. 23+24.88
 $\Delta = 1^{\circ}27'45''$
 $D = 0^{\circ}32'$
 $R = 10,742.96'$
 $T = 137.12'$
 $L = 274.22'$
 $E = 0.88'$

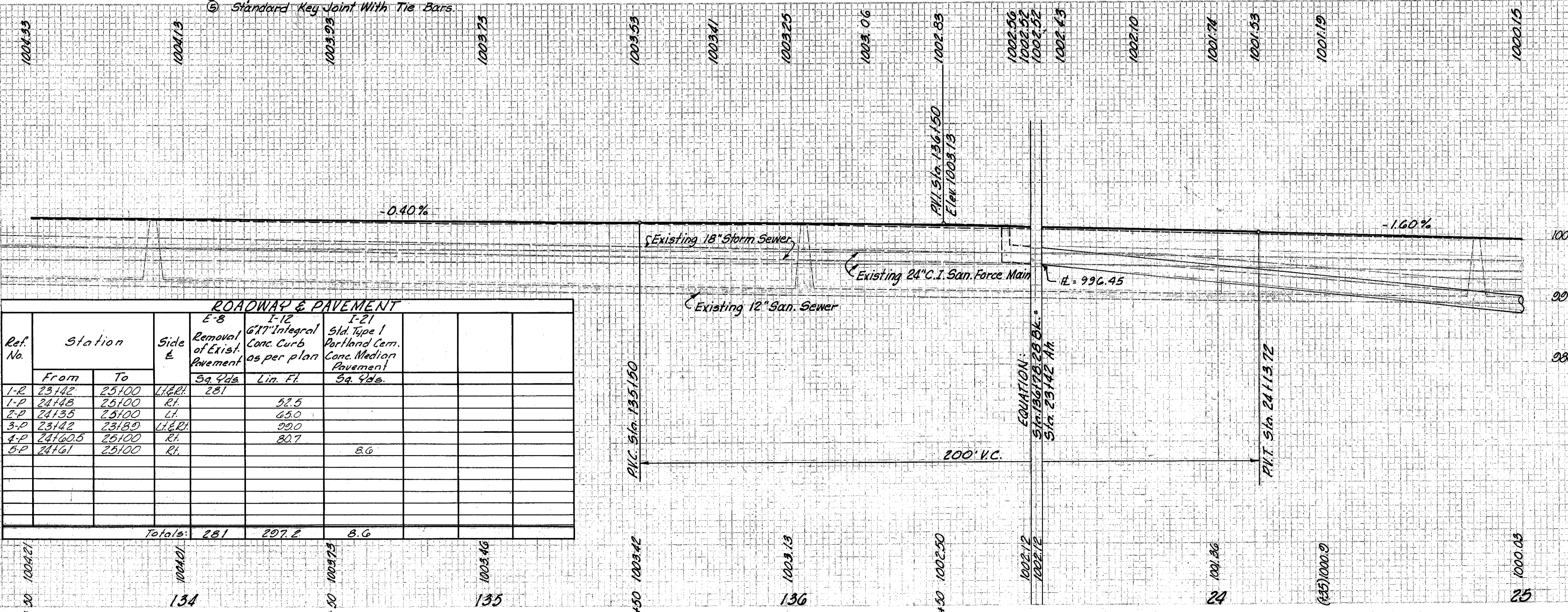
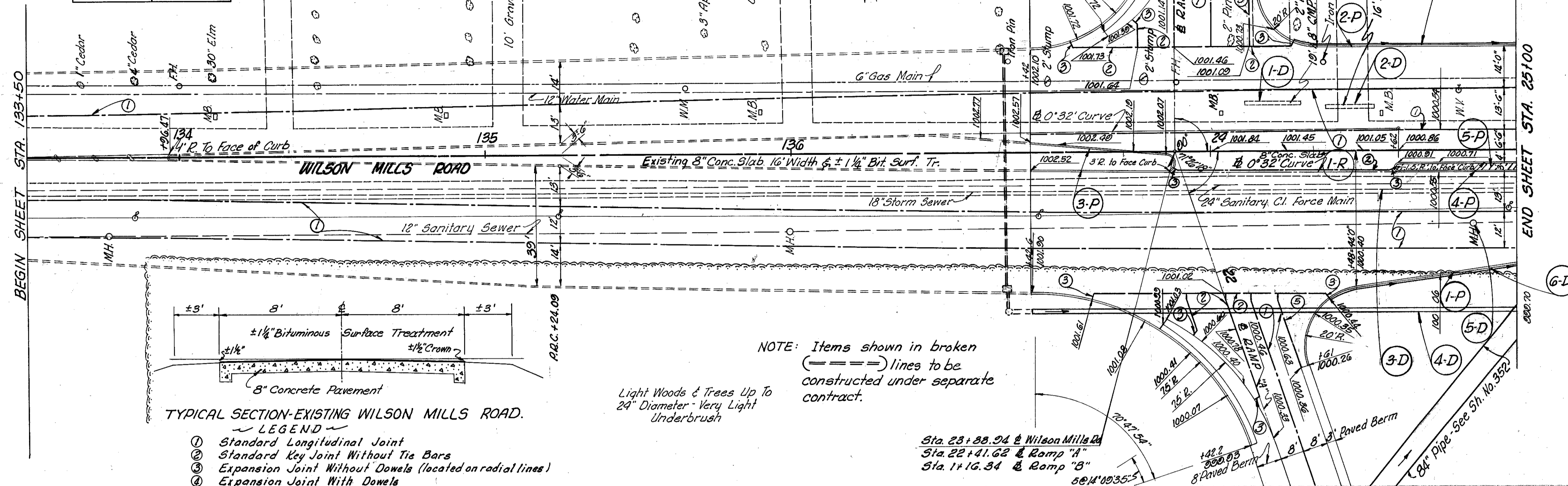

See Sheet No.	Station	Side &	12" Lin. Ft.		18" Lin. Ft.		24" Lin. Ft.		Totals
			From	To	From	To	From	To	
1-D	24+157	LI	19						
2-D	24+178	LI	10						
3-D	23+472	RT		22					
4-D	24+186	RT		24					
5-D	24+182	RT		25					
6-D	24+156	RT		25					
7-D	24+172	RT		25					
			Totals:		35		72		107

MICHAEL BAKER JR., CONSULTING ENGINEERS
ROCHESTER, PENNSYLVANIA

STATE OF OHIO
DEPARTMENT OF HIGHWAYS
STATE HIGHWAY NO. 1
C-41
WILSON MILLS ROAD, PLAN & PROFILE
STA. 133+50 TO STA. 25+00

Designed	Drawn	Traced	Checked	Reviewed Date	Revised
B.P.	K.A.	K.G.	L.I.		