

Seeding
End
Width Sq. ft.

CUYAHOGA & LAKE COUNTIES
CUY-I-15.91
LAK-I-0.00

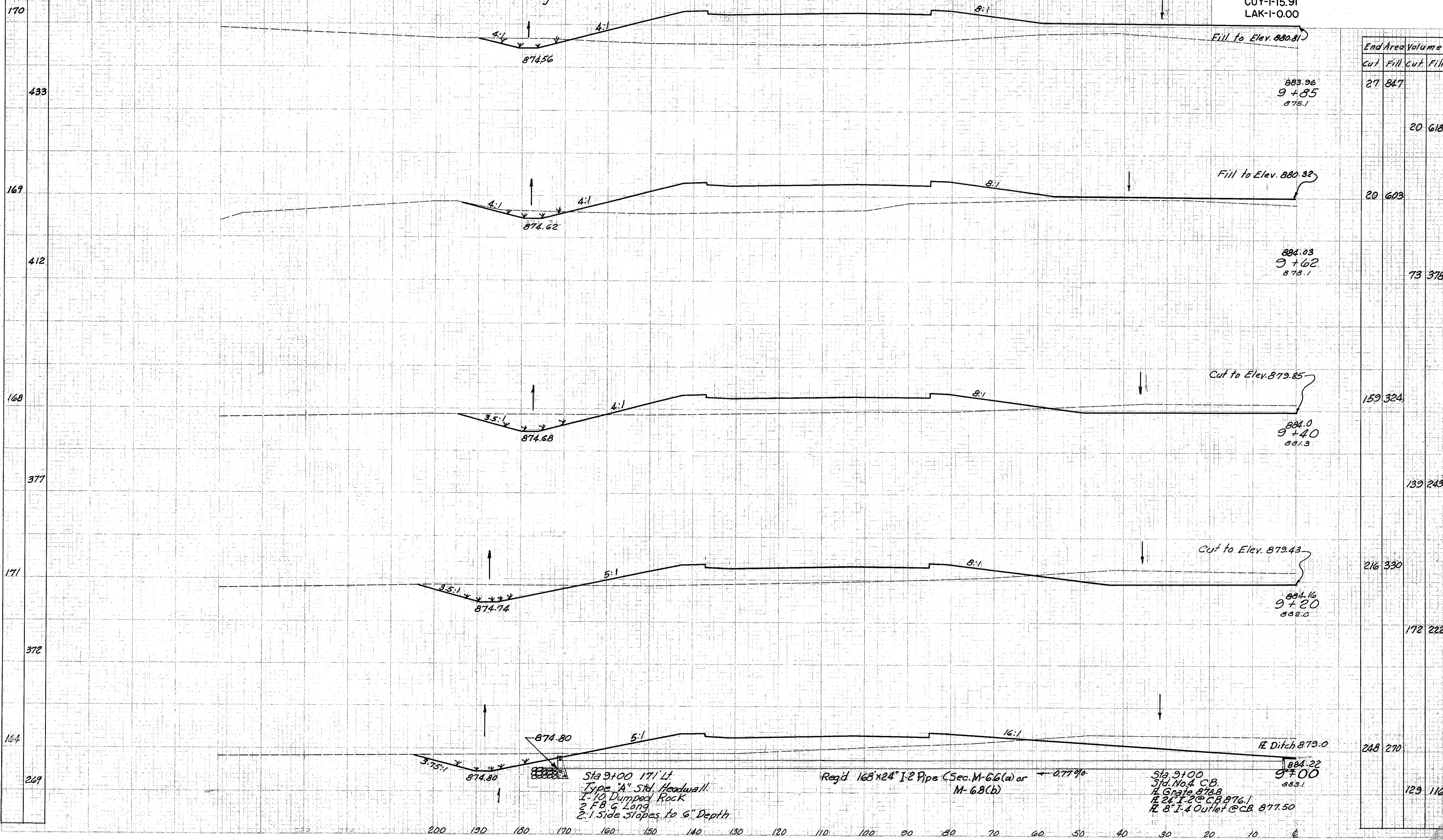

Station	End Area		Volume	
	Cut	Fill	Cut	Fill
9+85	27	847		
9+62		20	618	
9+40	159	324		
9+20	216	330		
9+00	248	270		
Total			129	116

Sta. 9+90
End Sodding

Fill to Elev. 880.81

Fill to Elev. 880.32

Cut to Elev. 879.85

Cut to Elev. 879.43

E Ditch 879.0

Sta 9+00 171' Lt.
Type "A" Std. Headwall.
1-10 Dumped Rock
2' B.G. Long
2:1 Side Slopes to 6" Depth

Req'd 168"x24" I-2 Pipe (Sec. M-6.6(a) or M-6.8(b)) ← 0.7790

Sta. 9+00
Std. No. 4 C.B.
E Grate 878.8
E 24" I-2 @ C.B. 876.1
E 8" I-4 Outlet @ C.B. 877.50

170
433
169
412
168
377
171
372
164
269

200 190 180 170 160 150 140 130 120 110 100 90 80 70 60 50 40 30 20 10 0
Sta. 9+00 To Sta. 9+85 Lt. E