

FED. RD. DIVISION	STATE	PROJECT
2	OHIO	I-1103 (8)

48  
458

GUYAHOGA & LAKE COUNTIES  
CUY-1-15.91  
LAK-1-0.00

PROPOSED STRUCTURE UNDER EUCLID SPUR (RAMP "B")  
TYPE: CONTINUOUS STEEL BEAMS & GIRDERS WITH  
REINFORCED CONCRETE DECK & SUBSTRUCTURE.  
SPANS: 163'-0", 103'-0", 97'-0" HINGED, 103'-0", 125'-0", 110'-0"  
ROADWAY: 30'-0" TOP OF 2'-2" SAFETY CURBS  
LOADING: 27'-2000 (57)  
SKEN: 44' 15' 30" L.F.  
APPR. SLABS: SPECIAL DESIGN (P5' LENGTH)  
WEARING SURFACE: 1" MONO. CONC.  
ALIGNMENT: 6'-00'-00" LT. CURVE  
SUPERELEVATION: 0.083 PER FT.

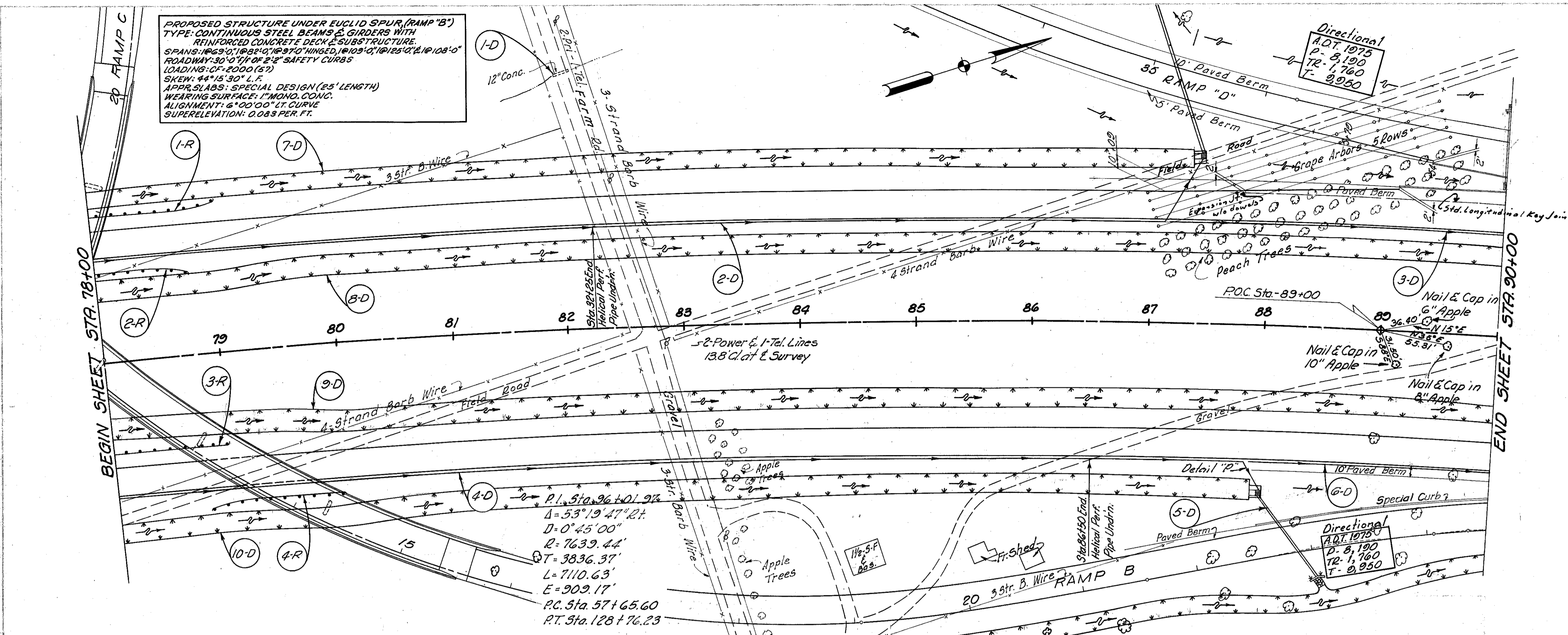

B.M. No. 21  
Spike in root twin Wild Cherry  
3' Rt. & Sta. 81+17  
Elev. 820.608

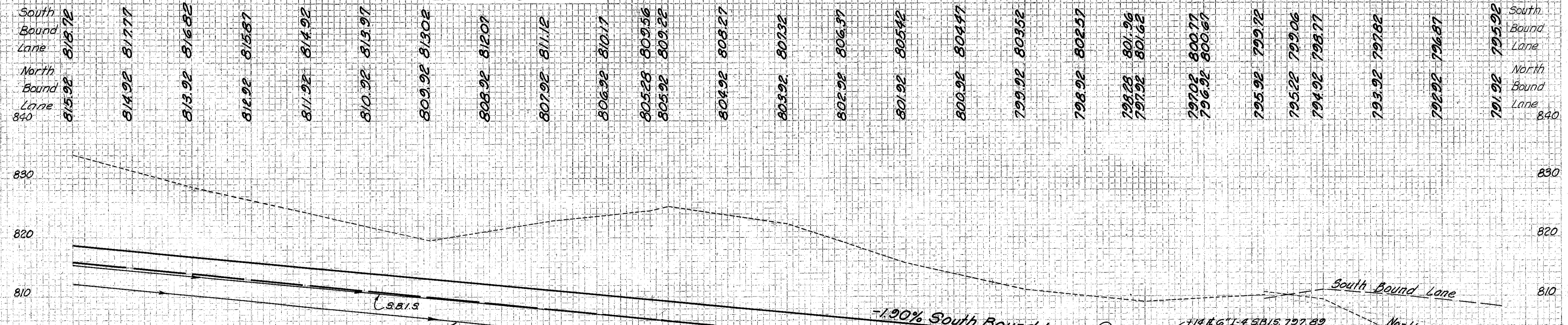

Ref. No.	Station		Side &	I-15 Guard Rail Dwg. No. 2H Lin. Ft.	Remarks
	From	To			
1-R	78100	79+03.63	LI	105.85	
2-R	78100	78+77.86	LI	78.65	No Fed. Partic.
3-R	78100	78+28.43	RI	27.43	No Fed. Partic.
4-R	78182.61	79197	RI	112.50	
Total:				393.93	

Station	From	To	Side &	Excavation for Structures	Pipe Removed	Pipe Under	Class "H" Storm Sewer under Approaches	Underdrain	Shallow	Deep	Helical	Pipe Ducts for Underdrain	Sec. M.G. (H)	Sec. M.G. (L)	Pipe Specials	Catch Basins	Standard No. 5	Dumped Rock	Sodding	Concrete for Structures	Class 2	Reinforcing Steel	
78+00	78100	78100	LI	6	15	15	8	27	6	6	6	10	10	1	1	1	1	2	2	1454	2000	1540	2.00
79+00	79100	79100	LI	6	15	15	8	27	6	6	6	10	10	1	1	1	1	2	2	1454	2000	1540	2.00
80+00	80100	80100	LI	6	15	15	8	27	6	6	6	10	10	1	1	1	1	2	2	1454	2000	1540	2.00
81+00	81100	81100	LI	6	15	15	8	27	6	6	6	10	10	1	1	1	1	2	2	1454	2000	1540	2.00
82+00	82100	82100	LI	6	15	15	8	27	6	6	6	10	10	1	1	1	1	2	2	1454	2000	1540	2.00
83+00	83100	83100	LI	6	15	15	8	27	6	6	6	10	10	1	1	1	1	2	2	1454	2000	1540	2.00
84+00	84100	84100	LI	6	15	15	8	27	6	6	6	10	10	1	1	1	1	2	2	1454	2000	1540	2.00
85+00	85100	85100	LI	6	15	15	8	27	6	6	6	10	10	1	1	1	1	2	2	1454	2000	1540	2.00
86+00	86100	86100	LI	6	15	15	8	27	6	6	6	10	10	1	1	1	1	2	2	1454	2000	1540	2.00
87+00	87100	87100	LI	6	15	15	8	27	6	6	6	10	10	1	1	1	1	2	2	1454	2000	1540	2.00
88+00	88100	88100	LI	6	15	15	8	27	6	6	6	10	10	1	1	1	1	2	2	1454	2000	1540	2.00
89+00	89100	89100	LI	6	15	15	8	27	6	6	6	10	10	1	1	1	1	2	2	1454	2000	1540	2.00
90+00	90100	90100	LI	6	15	15	8	27	6	6	6	10	10	1	1	1	1	2	2	1454	2000	1540	2.00

REVISIONS:  
3-31-00 Grade raise for I&C Ch-CI

MICHAEL BAKER, JR., CONSULTING ENGINEERS  
ROCHESTER, PENNSYLVANIA

STATE OF OHIO  
DEPARTMENT OF HIGHWAYS  
STATE HIGHWAY NO. 1  
C-42

PLAN AND PROFILE  
STA. 78+00 TO STA. 90+00

Designed	Drawn	Traced	Checked	Reviewed	Date	Revised
B.P.	A.H.	A.G.	L.I.		11-15-60	REC

PLAN & PROFILE STA 78+00-STA 90+00