

**CUYAHOGA & LAKE COUNTIES**  
**CUY-I-15.91**  
**LAK-I-0.00**

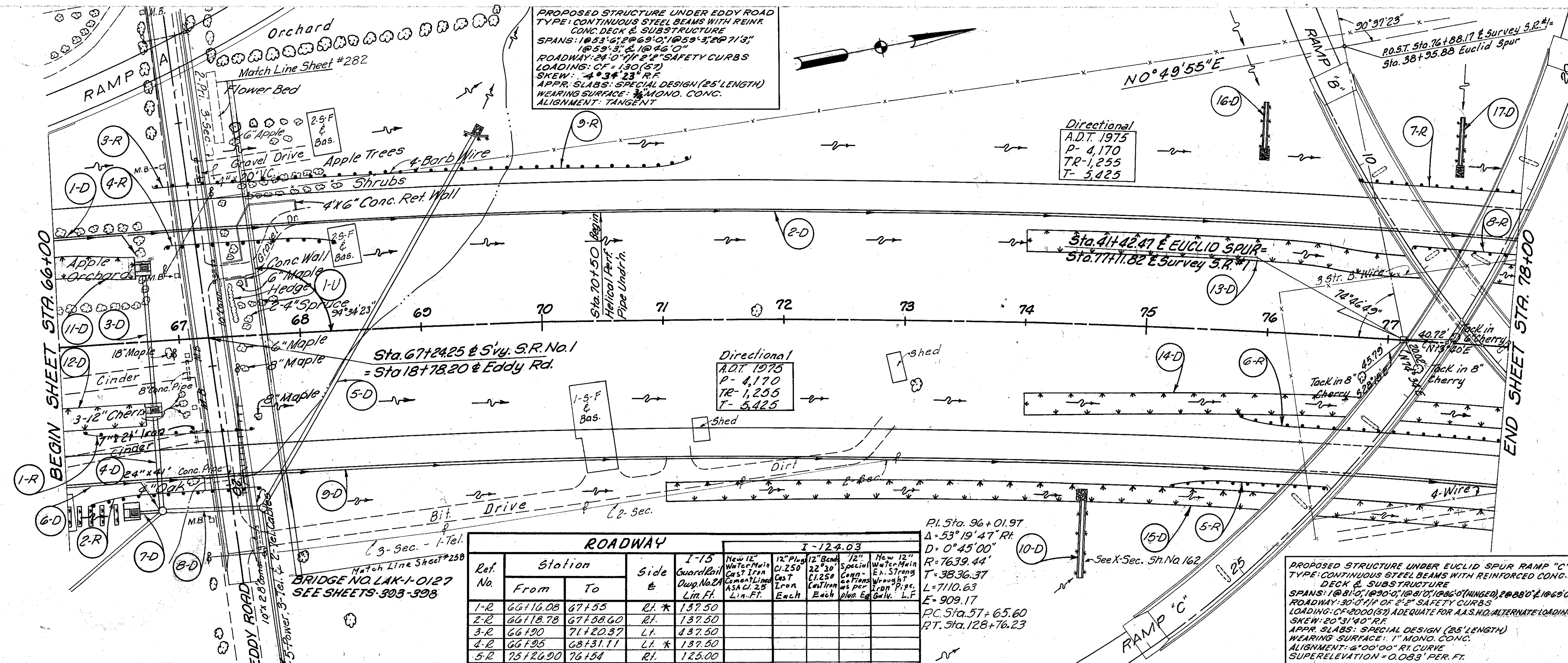

| ROADWAY  |                   | I-124.03 |           |                    |                  |                        |         |
|----------|-------------------|----------|-----------|--------------------|------------------|------------------------|---------|
| Ref. No. | Station           | Side     | I-15      | New 12" Water Main | 12" Pl. 12" Beam | 12" New 12" Water Main |         |
|          | From To           |          | Guardrail | Dwg. No. 21        | Cl. 250          | Cl. 250                | Cl. 250 |
|          |                   |          | Lin. Ft.  | Lin. Ft.           | Each             | Each                   | Each    |
| 1-R      | 66+16.08 67+55    | RT *     | 137.50    |                    |                  |                        |         |
| 2-R      | 66+18.78 67+58.60 | RT       | 137.50    |                    |                  |                        |         |
| 3-R      | 66+19.00 71+20.87 | LT       | 437.50    |                    |                  |                        |         |
| 4-R      | 66+19.50 68+31.11 | LT *     | 137.50    |                    |                  |                        |         |
| 5-R      | 75+26.90 76+54    | RT       | 125.00    |                    |                  |                        |         |
| 6-R      | 75+28.71 78+00    | RT *     | 215.07    |                    |                  |                        |         |
| 7-R      | 76+17.00 78+00    | LT       | 132.15    |                    |                  |                        |         |
| 8-R      | 77+17 78+00       | LT *     | 83.85     |                    |                  |                        |         |
| 1-U      | 67+70 ±           | RT & LT  |           | 715*               | 2*               | 4*                     | 6*      |
|          |                   |          |           |                    |                  |                        | 134*    |
| Total:   |                   |          | 1406.07   | 715                | 2                | 4                      | 6       |

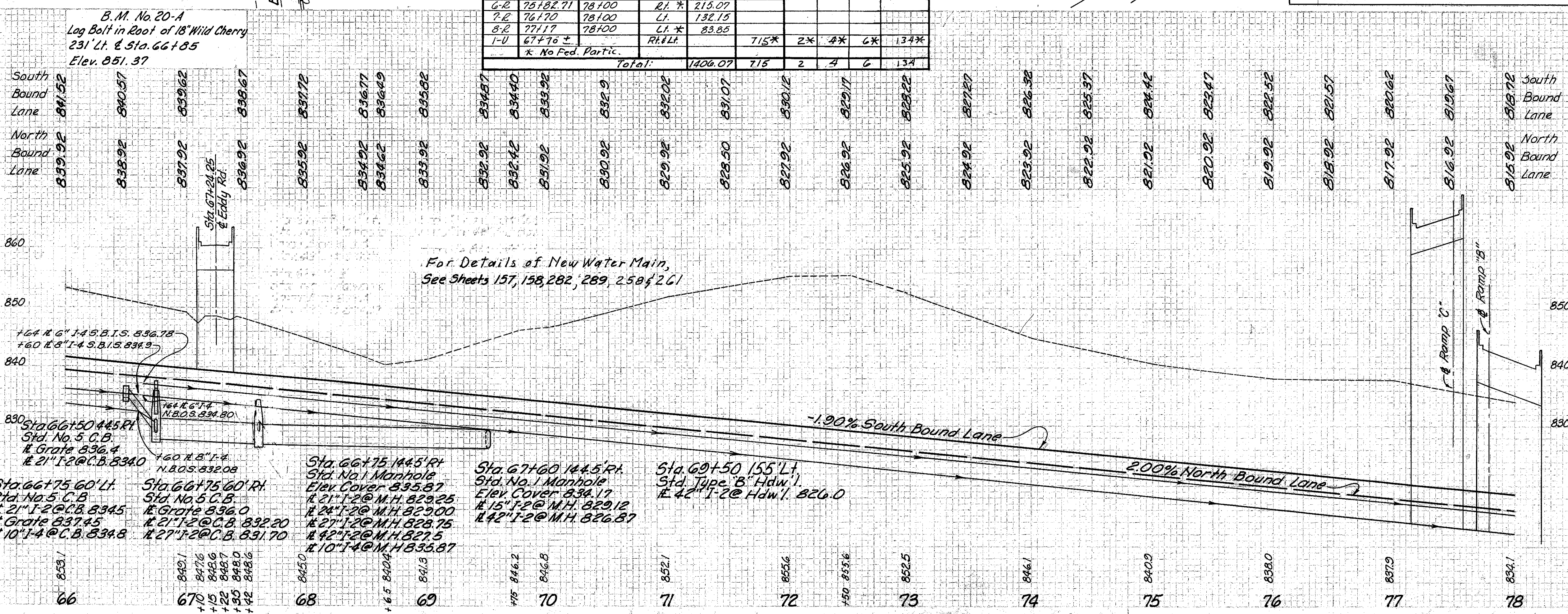

| Station | From  | To    | Side | Structure | Material | Depth | Notes |
|---------|-------|-------|------|-----------|----------|-------|-------|
| 66+00   | 66+10 | 66+20 | RT   | Manhole   | Concrete | 4'    |       |
| 66+20   | 66+30 | 66+40 | RT   | Manhole   | Concrete | 4'    |       |
| 66+40   | 66+50 | 66+60 | RT   | Manhole   | Concrete | 4'    |       |
| 66+60   | 66+70 | 66+80 | RT   | Manhole   | Concrete | 4'    |       |
| 66+80   | 66+90 | 67+00 | RT   | Manhole   | Concrete | 4'    |       |
| 67+00   | 67+10 | 67+20 | RT   | Manhole   | Concrete | 4'    |       |
| 67+20   | 67+30 | 67+40 | RT   | Manhole   | Concrete | 4'    |       |
| 67+40   | 67+50 | 67+60 | RT   | Manhole   | Concrete | 4'    |       |
| 67+60   | 67+70 | 67+80 | RT   | Manhole   | Concrete | 4'    |       |
| 67+80   | 67+90 | 68+00 | RT   | Manhole   | Concrete | 4'    |       |
| 68+00   | 68+10 | 68+20 | RT   | Manhole   | Concrete | 4'    |       |
| 68+20   | 68+30 | 68+40 | RT   | Manhole   | Concrete | 4'    |       |
| 68+40   | 68+50 | 68+60 | RT   | Manhole   | Concrete | 4'    |       |
| 68+60   | 68+70 | 68+80 | RT   | Manhole   | Concrete | 4'    |       |
| 68+80   | 68+90 | 69+00 | RT   | Manhole   | Concrete | 4'    |       |
| 69+00   | 69+10 | 69+20 | RT   | Manhole   | Concrete | 4'    |       |
| 69+20   | 69+30 | 69+40 | RT   | Manhole   | Concrete | 4'    |       |
| 69+40   | 69+50 | 69+60 | RT   | Manhole   | Concrete | 4'    |       |
| 69+60   | 69+70 | 69+80 | RT   | Manhole   | Concrete | 4'    |       |
| 69+80   | 69+90 | 70+00 | RT   | Manhole   | Concrete | 4'    |       |
| 70+00   | 70+10 | 70+20 | RT   | Manhole   | Concrete | 4'    |       |
| 70+20   | 70+30 | 70+40 | RT   | Manhole   | Concrete | 4'    |       |
| 70+40   | 70+50 | 70+60 | RT   | Manhole   | Concrete | 4'    |       |
| 70+60   | 70+70 | 70+80 | RT   | Manhole   | Concrete | 4'    |       |
| 70+80   | 70+90 | 71+00 | RT   | Manhole   | Concrete | 4'    |       |
| 71+00   | 71+10 | 71+20 | RT   | Manhole   | Concrete | 4'    |       |
| 71+20   | 71+30 | 71+40 | RT   | Manhole   | Concrete | 4'    |       |
| 71+40   | 71+50 | 71+60 | RT   | Manhole   | Concrete | 4'    |       |
| 71+60   | 71+70 | 71+80 | RT   | Manhole   | Concrete | 4'    |       |
| 71+80   | 71+90 | 72+00 | RT   | Manhole   | Concrete | 4'    |       |
| 72+00   | 72+10 | 72+20 | RT   | Manhole   | Concrete | 4'    |       |
| 72+20   | 72+30 | 72+40 | RT   | Manhole   | Concrete | 4'    |       |
| 72+40   | 72+50 | 72+60 | RT   | Manhole   | Concrete | 4'    |       |
| 72+60   | 72+70 | 72+80 | RT   | Manhole   | Concrete | 4'    |       |
| 72+80   | 72+90 | 73+00 | RT   | Manhole   | Concrete | 4'    |       |
| 73+00   | 73+10 | 73+20 | RT   | Manhole   | Concrete | 4'    |       |
| 73+20   | 73+30 | 73+40 | RT   | Manhole   | Concrete | 4'    |       |
| 73+40   | 73+50 | 73+60 | RT   | Manhole   | Concrete | 4'    |       |
| 73+60   | 73+70 | 73+80 | RT   | Manhole   | Concrete | 4'    |       |
| 73+80   | 73+90 | 74+00 | RT   | Manhole   | Concrete | 4'    |       |
| 74+00   | 74+10 | 74+20 | RT   | Manhole   | Concrete | 4'    |       |
| 74+20   | 74+30 | 74+40 | RT   | Manhole   | Concrete | 4'    |       |
| 74+40   | 74+50 | 74+60 | RT   | Manhole   | Concrete | 4'    |       |
| 74+60   | 74+70 | 74+80 | RT   | Manhole   | Concrete | 4'    |       |
| 74+80   | 74+90 | 75+00 | RT   | Manhole   | Concrete | 4'    |       |
| 75+00   | 75+10 | 75+20 | RT   | Manhole   | Concrete | 4'    |       |
| 75+20   | 75+30 | 75+40 | RT   | Manhole   | Concrete | 4'    |       |
| 75+40   | 75+50 | 75+60 | RT   | Manhole   | Concrete | 4'    |       |
| 75+60   | 75+70 | 75+80 | RT   | Manhole   | Concrete | 4'    |       |
| 75+80   | 75+90 | 76+00 | RT   | Manhole   | Concrete | 4'    |       |
| 76+00   | 76+10 | 76+20 | RT   | Manhole   | Concrete | 4'    |       |
| 76+20   | 76+30 | 76+40 | RT   | Manhole   | Concrete | 4'    |       |
| 76+40   | 76+50 | 76+60 | RT   | Manhole   | Concrete | 4'    |       |
| 76+60   | 76+70 | 76+80 | RT   | Manhole   | Concrete | 4'    |       |
| 76+80   | 76+90 | 77+00 | RT   | Manhole   | Concrete | 4'    |       |
| 77+00   | 77+10 | 77+20 | RT   | Manhole   | Concrete | 4'    |       |
| 77+20   | 77+30 | 77+40 | RT   | Manhole   | Concrete | 4'    |       |
| 77+40   | 77+50 | 77+60 | RT   | Manhole   | Concrete | 4'    |       |
| 77+60   | 77+70 | 77+80 | RT   | Manhole   | Concrete | 4'    |       |
| 77+80   | 77+90 | 78+00 | RT   | Manhole   | Concrete | 4'    |       |

REVISIONS:

| Design | Drawn | Traced | Checked | Reviewed Date | Revised                     |
|--------|-------|--------|---------|---------------|-----------------------------|
| B.P.   | L.W.  | A.G.   | L.I.    |               | 11-29-61<br>11-15-60<br>REC |

3-31-60 Grade Raise for 16" Dr. C.I.

MICHAEL BAKER, JR., CONSULTING ENGINEERS  
 ROCHESTER, PENNSYLVANIA

STATE OF OHIO  
 DEPARTMENT OF HIGHWAYS  
 STATE HIGHWAY NO. 1  
 C-42

PLAN AND PROFILE  
 STA. 66+00 TO STA. 78+00

PLAN & PROFILE STA. 66+00-STA. 78+00