

- LEGEND**
- Standard Longitudinal Joint
 - Standard Key Joint Without Tie Bars
 - Expansion Joints Without Dowels (located on radial lines.)
 - Expansion Joint With Dowels
 - Std. Contraction Joint.

Federal Marker I-271-6(5)260 will be furnished and erected on the left by the State of Ohio before acceptance of this Project.

Federal Project Marker I-90-1(20)18 will be furnished and erected on Rt. by the State of Ohio before acceptance of this Project.

PROPOSED STRUCTURE UNDER CHARDON ROAD TYPE: CONTINUOUS WELDED STEEL PLATE GIRDERS WITH REINFORCED CONCRETE DECK & SUBSTRUCTURE.
 SPANS: 106'-0" @ 10.2°-0", 20'-34'-0" @ 95'-3", 1067'-0" ROADWAY: 30'-0" RW OF 2'-2" SAFETY CURBS.
 LOADING: CF-400 (57)
 SKEW: 31°52'50" L.F.
 APPR. SLABS: SPECIAL DESIGN (25' LENGTH)
 WEARING SURFACE: 1" MONO. CONC.
 ALIGNMENT: TANGENT.

FED. RD. DIVISION	STATE	PROJECT	45 158
2	OHIO	I-1102 (6) I-1103 (8)	

CUYAHOGA & LAKE COUNTIES
 CUY-I-15.91
 LAK-I-0.00

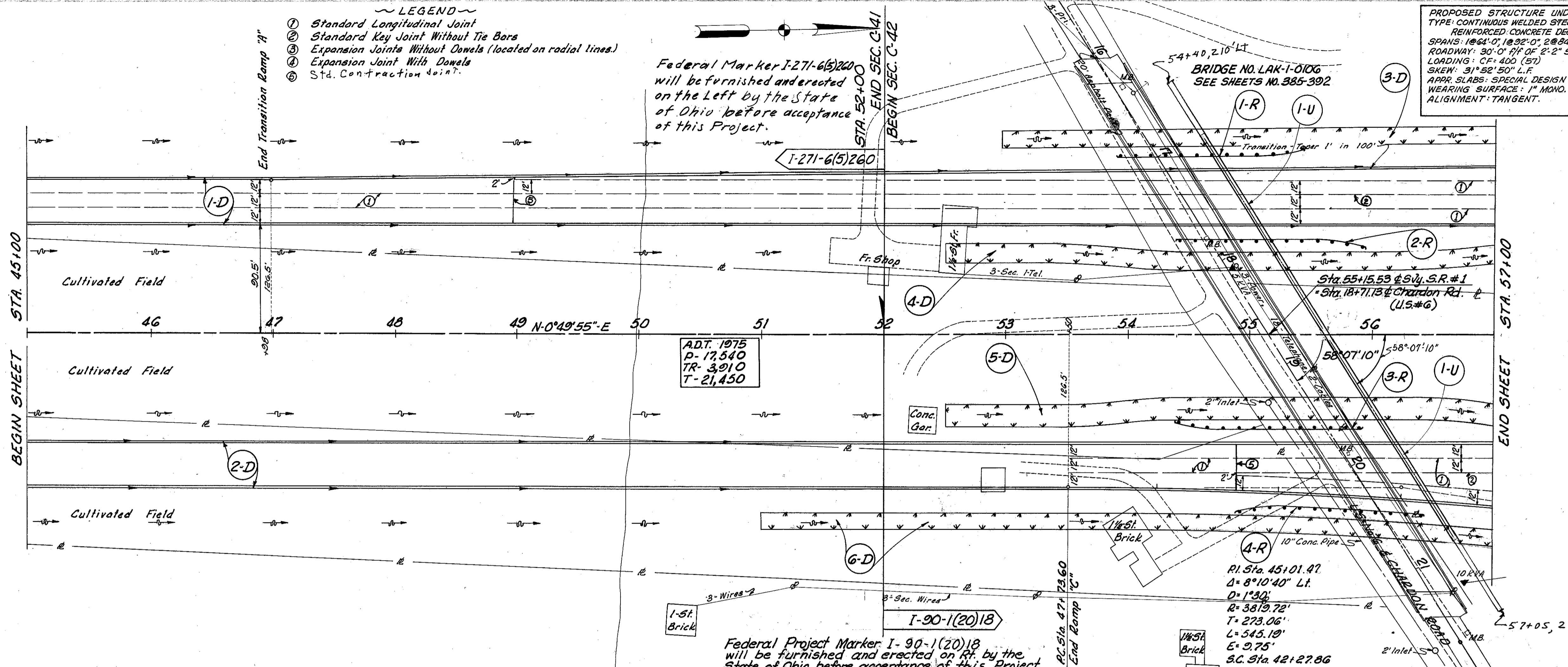

Ref. No.	Station	Side	I-15 Guard Rail Dwg. No. 2A Lin. Ft.	
1-R	53+42.41 to 55+12.41	Lt.	150.00	
2-R	54+42.00 to 55+12.00	Lt.	150.00	No Fed. Participation
3-R	54+39.06 to 55+12.00	Rt.	150.00	No Fed. Participation
4-R	54+39.37 to 55+12.37	Rt.	150.00	
C-42 I-1103 (18) Total:			600.00	

Ref. No.	Lim. Ft.	Lim. Ft.	Each	Each	Each
I-124.03					
	New 12" Water Main	New 12" Water Main	12" Plugs	12" Bands	12" Connectors
	Cast Iron	Wrought Iron	C.I. 250	22" 30"	Special
	Cement Lined	Iron Galv.	Cast Iron	C.I. 250	AS PER PLAN
	ASA C.I. 25	AS PER PLAN	Cast Iron	Cast Iron	AS PER PLAN
1-U	354*	148*	2*	4*	4*
TOTAL	354	148	2	4	4

* No Fed. Participation

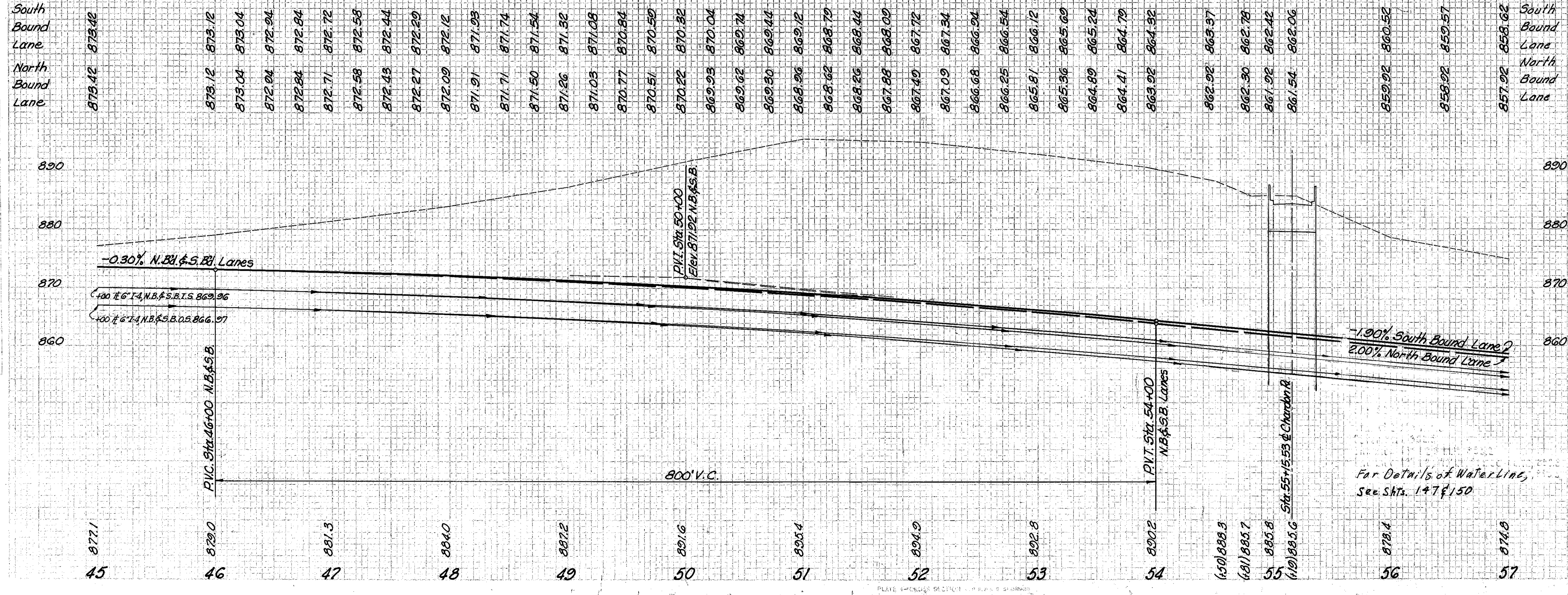

See Sheet No.	Ref. No.	Station	From		To		Totals
			From	To	From	To	
C-41 I-1102 (6)	1-0	45+00	45+00	57+00	57+00	1400	1400
	2-0	45+00	52+00	52+00	57+00	500	500
	3-0	45+00	52+00	52+00	57+00	500	500
	4-0	45+00	52+00	52+00	57+00	500	500
	5-0	45+00	52+00	52+00	57+00	500	500
	6-0	45+00	52+00	52+00	57+00	500	500
C-41 I-1102 (6) Totals:			1400	1400	1400	1400	
C-42 I-1103 (18)	1-0	45+00	57+00	57+00	57+00	500	500
	2-0	45+00	52+00	52+00	57+00	500	500
	3-0	45+00	52+00	52+00	57+00	500	500
	4-0	45+00	52+00	52+00	57+00	500	500
	5-0	45+00	52+00	52+00	57+00	500	500
	6-0	45+00	52+00	52+00	57+00	500	500
C-42 I-1103 (18) Totals:			3000	3000	3000	3000	
C-42 I-1103 (18) Totals:			4400	4400	4400	4400	

MICHAEL BAKER JR., CONSULTING ENGINEERS
 ROCHESTER, PENNSYLVANIA

STATE OF OHIO
 DEPARTMENT OF HIGHWAYS
 STATE HIGHWAY NO. 1
 C-41 & 42
 PLAN AND PROFILE
 STA. 45+00 TO STA. 57+00

Designed	Drawn	Traced	Checked	Reviewed	Date
B.P.	B.P.	K.L.G.	L.I.		

REVISIONS: 3-31-60 Grade Raise for 16'-4" B.C.I.

Far Details of Water Line, See Shts. 1-47 & 150

PLATE 4-1086 SECTION 10-10-60
 REVISION 11-24-61
 11-15-60
 REC

PLAN & PROFILE Sta. 45+00 to Sta. 57+00