

CUYAHOGA & LAKE COUNTIES  
CUI-1-15.9L  
LAK-1-0.00

FINAL SURVEY DRAWING  
DATE: \_\_\_\_\_  
BY: \_\_\_\_\_  
CHECKED BY: \_\_\_\_\_  
DATE: \_\_\_\_\_

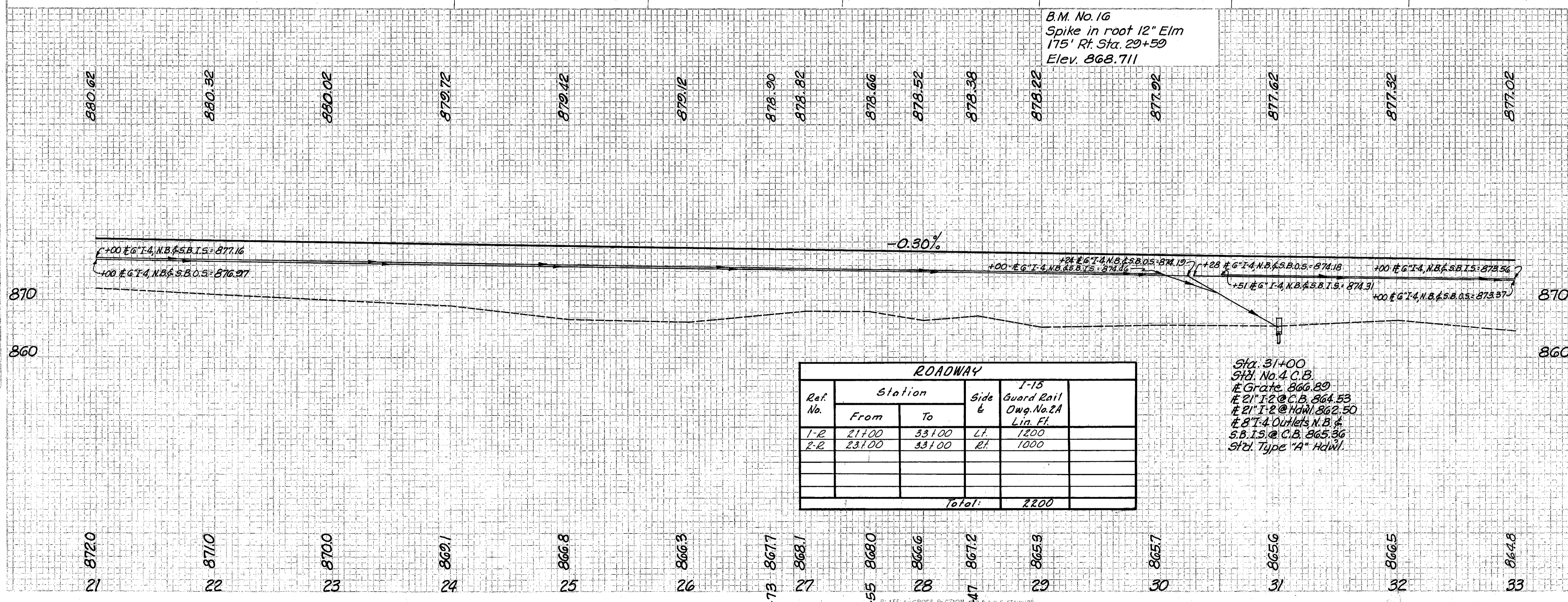
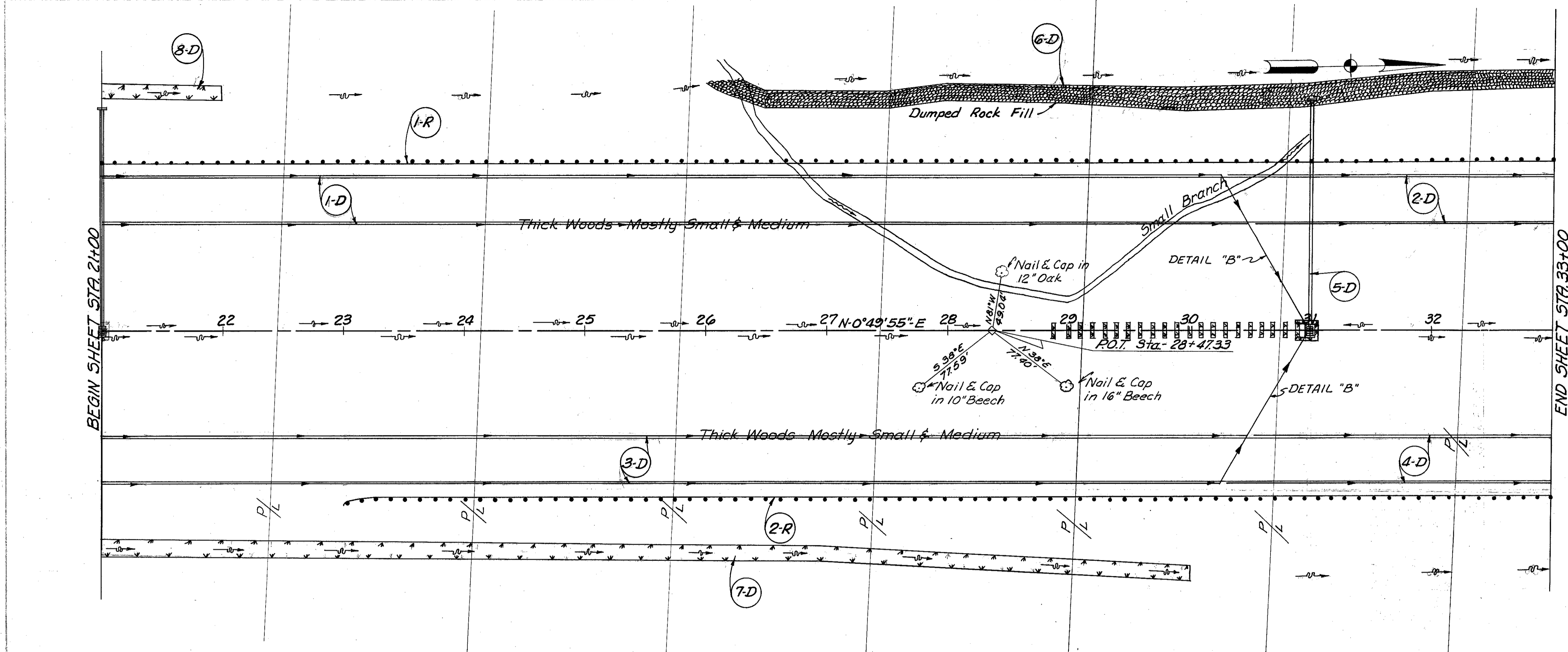

See Sheet No.	Ref. No.	From	To	Station	Side &	Culverts		Culverts Sp. 745, Cuttable, L.S.
						24' x 24'	24' x 24'	
	313	21+00	31+00	31+00	Lt.	1	1	
	2-0	30+25	31+00	31+00	Lt.	1	1	
	3-0	21+00	31+00	31+00	Rt.	1	1	
	4-0	30+25	31+00	31+00	Rt.	1	1	
	5-0	31+00	33+00	33+00	Lt.	1	1	
	6-0	21+00	31+00	31+00	Rt.	1	1	
	8-0	21+00	22+00	22+00	Lt.	1	1	
Totals:						6	6	

MICHAEL BAKER, JR., CONSULTING ENGINEERS  
ROCHESTER, PENNSYLVANIA  
**STATE OF OHIO**  
**DEPARTMENT OF HIGHWAYS**  
STATE HIGHWAY NO. 1  
C-41  
PLAN AND PROFILE  
STA. 21+00 TO STA. 33+00

Designed	Drawn	Traced	Checked	Reviewed Date	Revised
B.P.	B.P.	K.G.	L.I.		