

FED. RD. DIVISION	STATE	PROJECT
2	OHIO	I-1102 (6)

35
158

CUYAHOGA & LAKE COUNTIES
CUY-I-15.91
LAK-I-0.00

PROPOSED STRUCTURE UNDER HIGHLAND RD.
TYPE: CONTINUOUS STEEL BEAMS WITH REINFORCED
CONCRETE DECK AND SUBSTRUCTURE
SPANS: 1 @ 49'-0" & 1 @ 31'-0" & 1 @ 49'-0"
ROADWAY: 28'-1/4" OF 43' SIDEWALKS
LOADINGS: CF = 130 (57)
SKEW: 3° 15' 53" L.F.
APPR. SLABS: SPECIAL DESIGN, (25' LENGTH)
WEARING SURFACE: 3/4" MOND. CONC.
ALIGNMENT: TANGENT

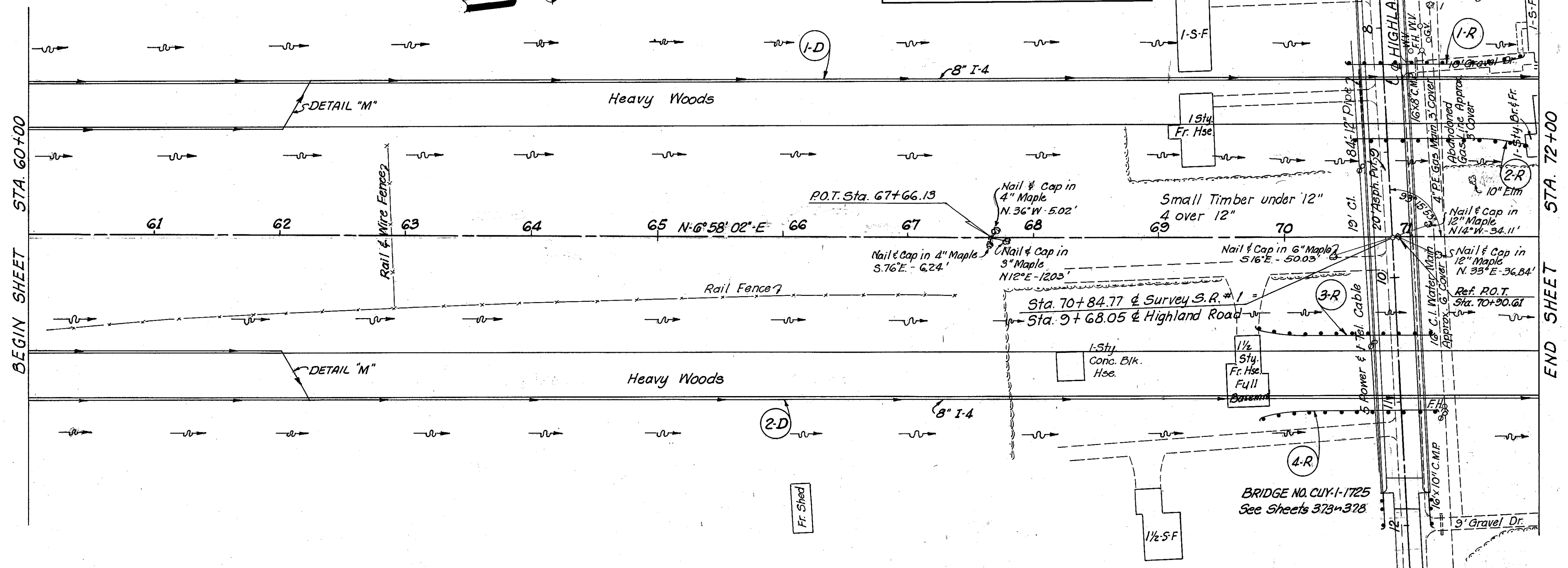

Ref. No.	Station		Side &	I-15 Guard Rail Dwg. No. 2A	Tot. Ft.
	From	To			
1-R	70+49.40	71+18.90	L.I.		137.50
2-R	70+53.45	71+20.95	L.I.		137.50
3-R	71+16.00	69+78.50	R.I.		137.50
4-R	71+20.14	69+82.64	R.I.		137.50
Total:					550.00

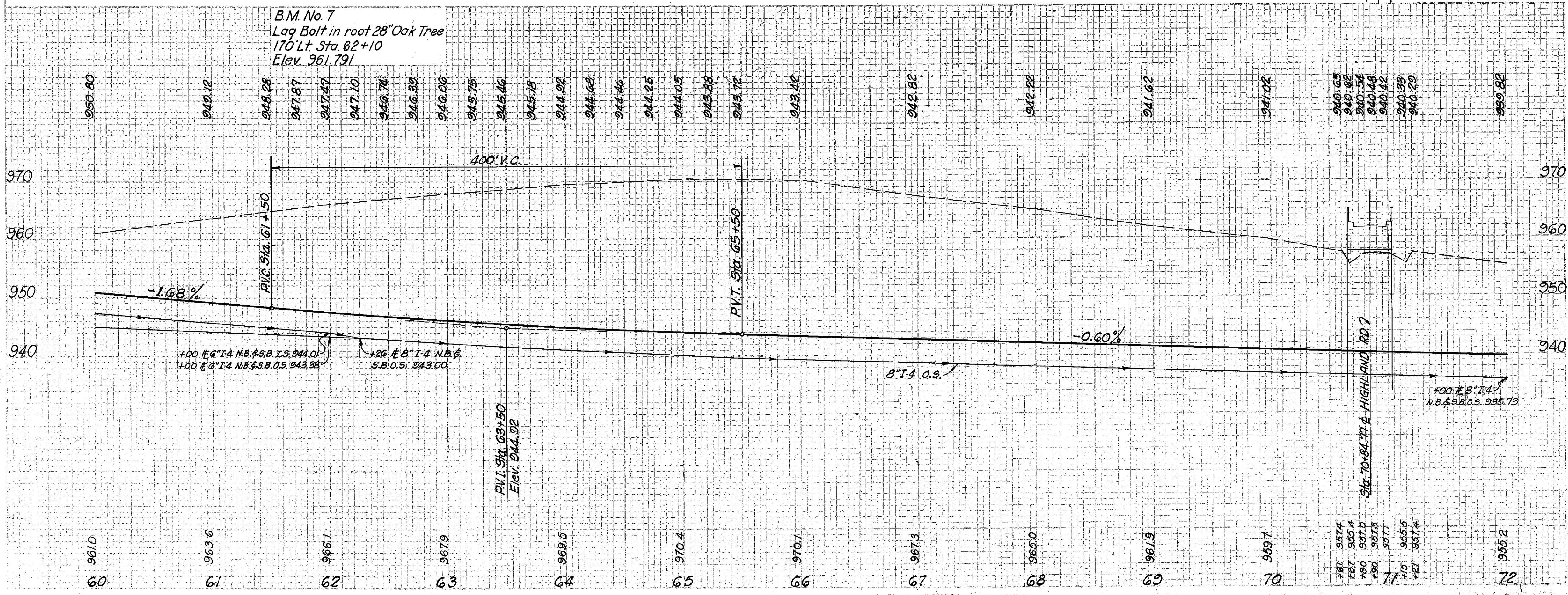

See Sheet No.	Ref. No.	Station	Side &	I-2		I-4		I-5	
				Under P.V. or H.P.P.	Under P.V. or H.P.P.	Under P.V. or H.P.P.	Under P.V. or H.P.P.	Under P.V. or H.P.P.	Under P.V. or H.P.P.
343	1-0	60+00	L.I.	46	46	8"	8"	1	1
345	2-0	60+00	R.I.	46	46	8"	8"	1	1
Totals:				92	92	160	160	2	2

REVISIONS:
9-31-60 Grade Raise for 16" Dr. C.I.

MICHAEL BAKER JR., CONSULTING ENGINEERS
ROCHESTER, PENNSYLVANIA

STATE OF OHIO
DEPARTMENT OF HIGHWAYS
STATE HIGHWAY NO. 1
C-41
PLAN AND PROFILE
STA. 60+00 TO STA. 72+00

Designed	Drawn	Traced	Checked	Reviewed Date	Revised
B.P.	A.H.	K.G.	L.S.I.		11-15-60 REC.

PLAN & PROFILE STA. 60+00 TO STA. 72+00