

Station	Structure	Material	Quantity	Notes
12+00 to 12+50	Underdrain	6" x 6" x 12"	10	
12+50 to 13+00	Underdrain	6" x 6" x 12"	10	
13+00 to 13+50	Underdrain	6" x 6" x 12"	10	
13+50 to 14+00	Underdrain	6" x 6" x 12"	10	
14+00 to 14+50	Underdrain	6" x 6" x 12"	10	
14+50 to 15+00	Underdrain	6" x 6" x 12"	10	
15+00 to 15+50	Underdrain	6" x 6" x 12"	10	
15+50 to 16+00	Underdrain	6" x 6" x 12"	10	
16+00 to 16+50	Underdrain	6" x 6" x 12"	10	
16+50 to 17+00	Underdrain	6" x 6" x 12"	10	
17+00 to 17+50	Underdrain	6" x 6" x 12"	10	
17+50 to 18+00	Underdrain	6" x 6" x 12"	10	
18+00 to 18+50	Underdrain	6" x 6" x 12"	10	
18+50 to 19+00	Underdrain	6" x 6" x 12"	10	
19+00 to 19+50	Underdrain	6" x 6" x 12"	10	
19+50 to 20+00	Underdrain	6" x 6" x 12"	10	
20+00 to 20+50	Underdrain	6" x 6" x 12"	10	
20+50 to 21+00	Underdrain	6" x 6" x 12"	10	
21+00 to 21+50	Underdrain	6" x 6" x 12"	10	
21+50 to 22+00	Underdrain	6" x 6" x 12"	10	
22+00 to 22+50	Underdrain	6" x 6" x 12"	10	
22+50 to 23+00	Underdrain	6" x 6" x 12"	10	
23+00 to 23+50	Underdrain	6" x 6" x 12"	10	
23+50 to 24+00	Underdrain	6" x 6" x 12"	10	
Totals:			600	

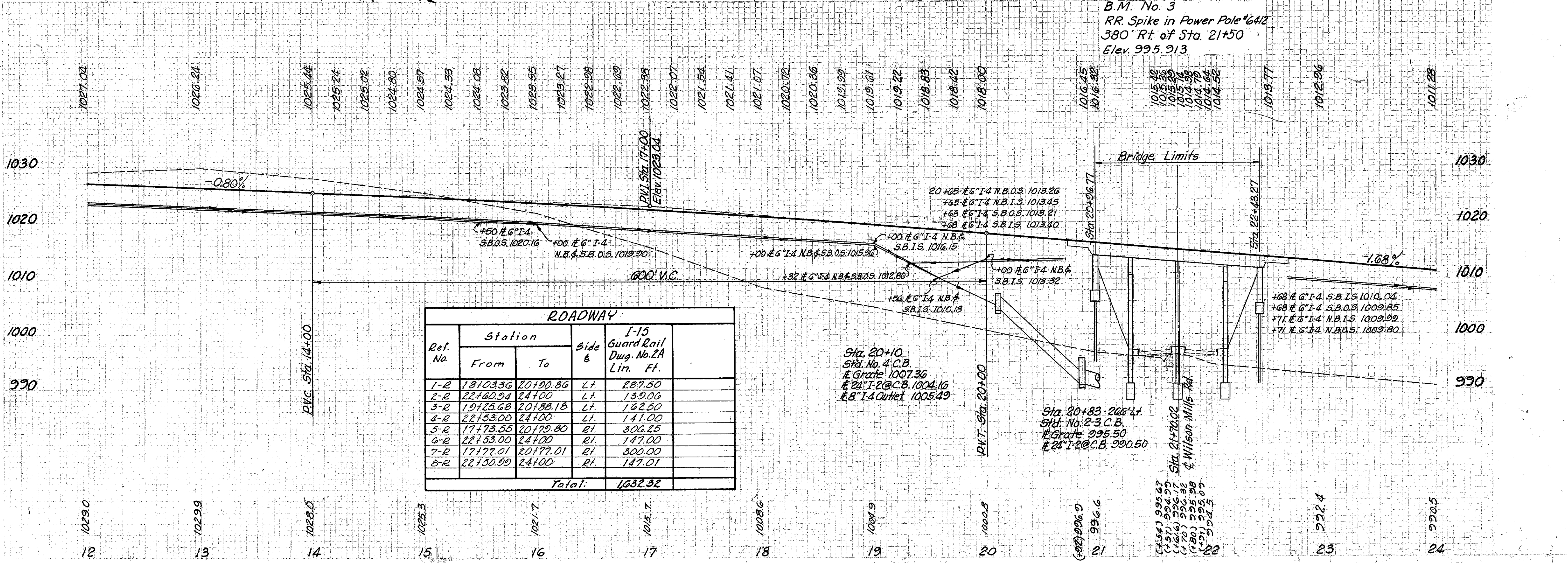

ROADWAY				
Ref. No.	Station		Side & Dug. No. 2A	Lim. Ft.
	From	To		
1-R	181033.6	20190.86	Lt.	287.50
2-R	22160.94	24100	Lt.	139.06
3-R	19125.68	20188.18	Lt.	162.50
4-R	22153.00	24100	Lt.	141.00
5-R	17173.55	20179.80	Rt.	306.25
6-R	22153.00	24100	Rt.	147.00
7-R	17177.01	20177.01	Rt.	300.00
8-R	22150.99	24100	Rt.	147.01
Total:				1632.32

MICHAEL BAKER JR., CONSULTING ENGINEERS
 ROCHESTER, PENNSYLVANIA

STATE OF OHIO
 DEPARTMENT OF HIGHWAYS
 STATE HIGHWAY NO. 1
 C-41
 PLAN AND PROFILE
 STA. 12+00 TO STA. 24+00

Designed	Drawn	Traced	Checked	Reviewed	Date	Revised
B.R.	A.H.	K.G.	L.S.I.			