

- LEGEND
- ① Standard Longitudinal Joint
 - ② Standard Key Joint Without Tie Bars
 - ③ Expansion Joint Without Dowels (located on radial lines)
 - ④ Expansion Joint With Dowels

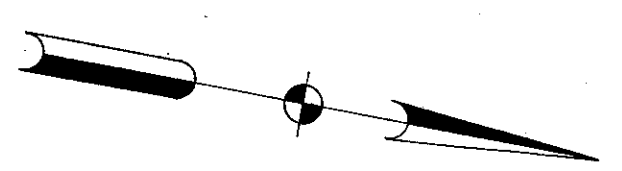

CUY-271-14.09
LAK-271-0.00

FED. RD. DIVISION	STATE	PROJECT	
2	OHIO	I-1102 (6)	29 158

CUYAHOGA & LAKE COUNTIES
CUY-1-15.91
LAK-1-0.00

CUY-1-9.49 BACK= CUY-1-15.91 AHEAD

NOTE: ~
Prop. Typical Section for adjoining Project is identical to the Typical Section on Sheet 5.

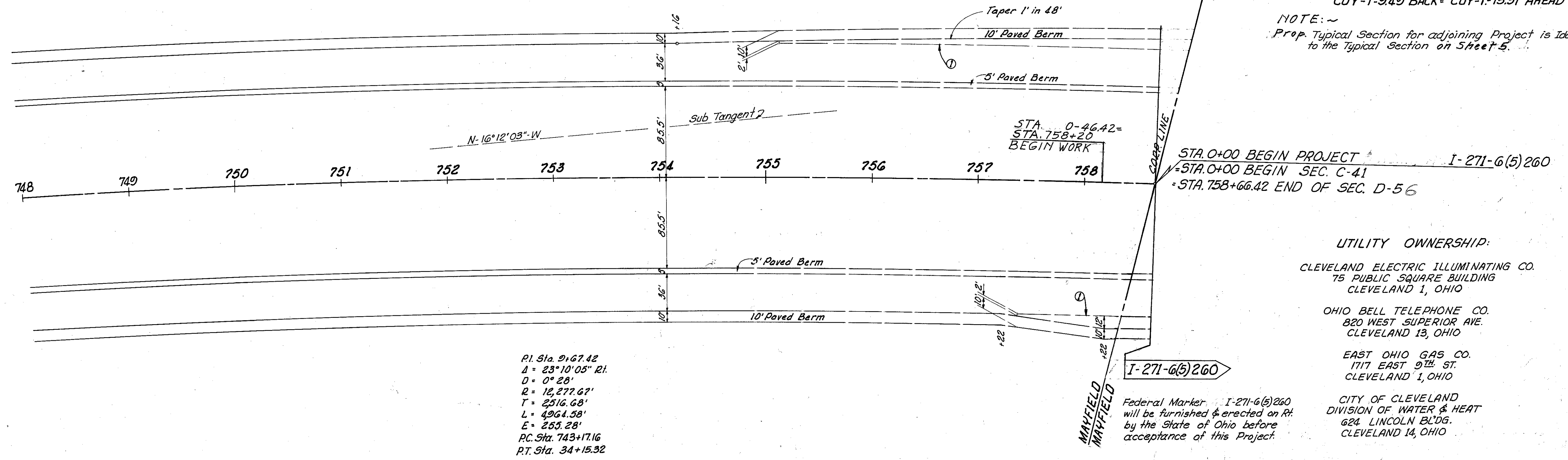

- UTILITY OWNERSHIP:
- CLEVELAND ELECTRIC ILLUMINATING CO.
75 PUBLIC SQUARE BUILDING
CLEVELAND 1, OHIO
 - OHIO BELL TELEPHONE CO.
820 WEST SUPERIOR AVE.
CLEVELAND 13, OHIO
 - EAST OHIO GAS CO.
1717 EAST 9TH ST.
CLEVELAND 1, OHIO
 - CITY OF CLEVELAND
DIVISION OF WATER & HEAT
624 LINCOLN BLDG.
CLEVELAND 14, OHIO

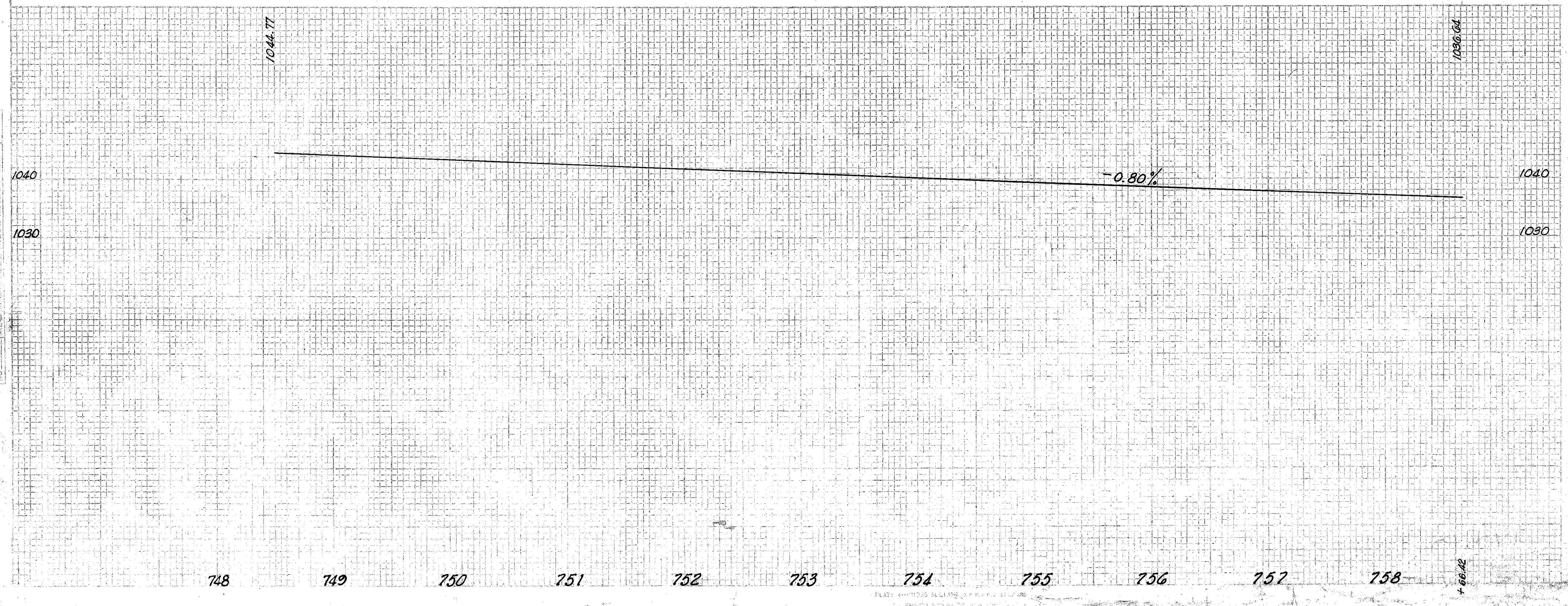

MICHAEL BAKER JR., CONSULTING ENGINEERS
ROCHESTER, PENNSYLVANIA

STATE OF OHIO
DEPARTMENT OF HIGHWAYS
STATE HIGHWAY NO. 1
C-41
PLAN AND PROFILE
STA. 750+00 TO STA. 758+66.42

Designed	Drawn	Traced	Checked	Reviewed	Date	Revised
B.P.	B.P.	KLG	L.S.I.			

PLAN & PROFILE STA. 750+00 TO STA. 758+66.42