

### ROADWAY

REF.	LOCATION	202				604	
		P.V.T. REMOVED	SIDEWALK REMOVED	CURB REMOVED	GUTTER REMOVED	MANUMENT_BOX ADJUSTED TO GRADE	EA
R-1	128+32 TO 129+90			158			
R-2	128+77.5 TO 130+11 - 27' RT.		667				
R-3	128+00 TO 132+00				400		
R-5	131+60 TO 132+00	18					
R-6	129+77.15						1
R-11	128+50 -LT.	17					
R-12	130+07 -LT.	19					
TOTAL		54	667	158	400		1

FOR DRIVE DETAILS SEE SHT. No. 27  
FOR INLET DETAIL SEE SHEET No. 23-24

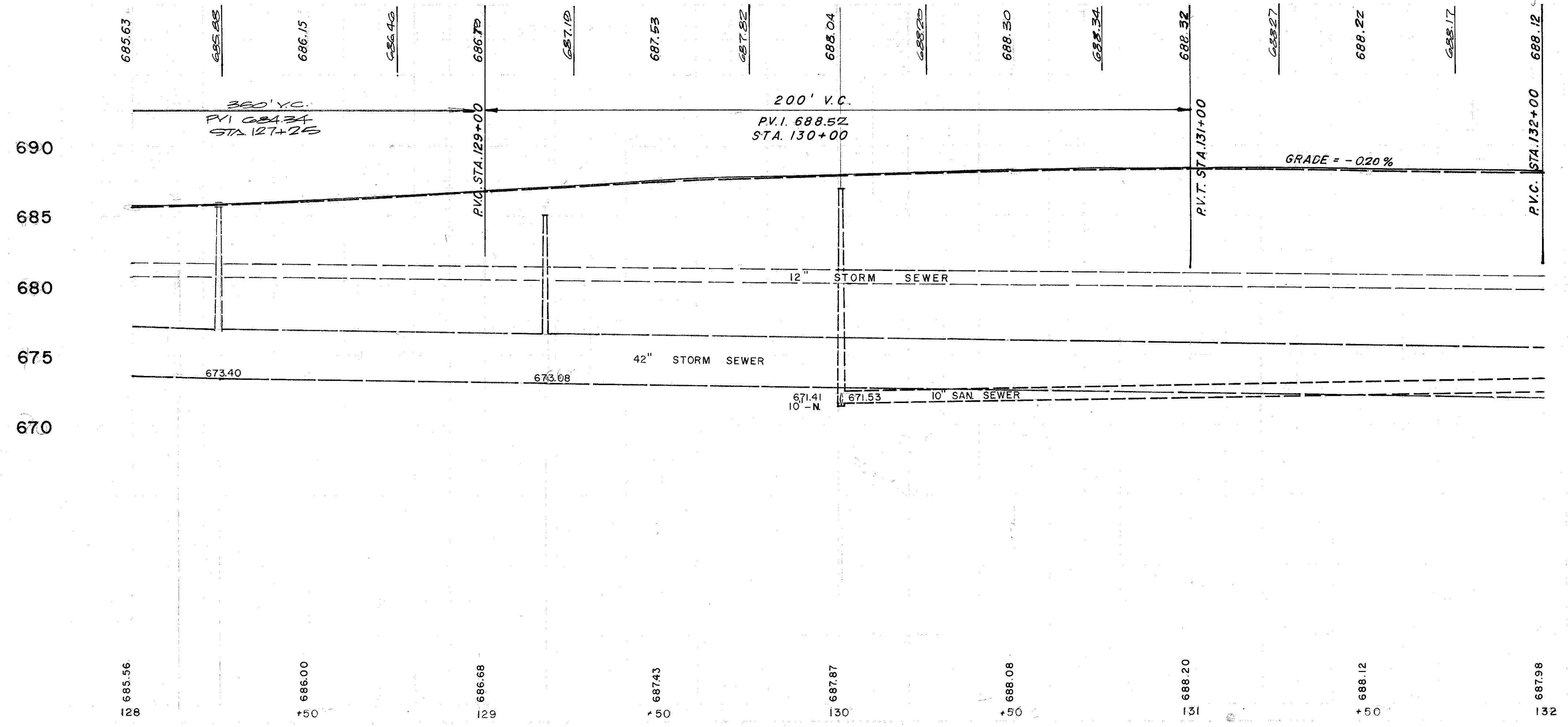

### DRAINAGE

\* 706.01 CL-3, 706.02, 706.08 E.S. OR 707.13

REF.	LOCATION	603		604	
		CONDUIT 12" TYPE C	CONDUIT 24" TYPE C	DUAL INLET DETAIL B	M.H. ADJUST TO GRADE
D-500	128+00 TO 128+24.5 - 43' RT.	24			
D-501	128+24.5 - 43' RT.			1	
D-502	128+24.5 - 37' RT. TO 43' RT.	8			
D-503	129+17 - 50' RT.				1
TOTAL		8	24	1	2

QUANTITY CALCULATIONS  
BY ASS DATE 11/3/72  
CHKD JRP DATE 11/10/72

DEBEVEC. SALCO & ASSOCIATES, INC.