

STATE OF OHIO  
DEPARTMENT OF TRANSPORTATION

# LAK 20-7.92

LAKE COUNTY  
CITY of MENTOR

FED. RD. DIVISION	STATE	PROJECT	
5	OHIO	STATE	

1  
62

LAKE COUNTY  
LAK-20-7.92  
ISSUE 1

DESIGN DESIGNATION

A. D. T.	1971	14,000
A. D. T.	1990	31,500
D. H. V.		1,200
DIRECTIONAL DISTRIBUTION		60-40
PERCENT B&C TRUCKS		4%
DESIGN SPEED		35 MPH

ISSUE No 1 FUNDS  
1973 SPECIFICATIONS

THE STANDARD SPECIFICATIONS OF THE STATE OF OHIO, DEPARTMENT OF TRANSPORTATION, INCLUDING CHANGES AND SUPPLEMENTAL SPECIFICATIONS LISTED IN THE PROPOSAL SHALL GOVERN THIS IMPROVEMENT.

THE RIGHT OF WAY FOR THIS IMPROVEMENT WILL BE PROVIDED BY THE STATE OF OHIO.

I HEREBY APPROVE THESE PLANS AND DECLARE THAT THE MAKING OF THIS IMPROVEMENT WILL NOT REQUIRE THE CLOSING TO TRAFFIC OF THE HIGHWAY AND THAT PROVISIONS FOR THE MAINTENANCE AND SAFETY OF TRAFFIC WILL BE AS SET FORTH IN THE PLANS AND ESTIMATES.

APPROVED  
DATE 4-11-73 *Arthur M. Richard*  
MENTOR CITY MANAGER

APPROVED  
DATE 4-11-73 *Persephone A. Eden*  
MENTOR CITY SERVICE DIRECTOR AND CITY ENGINEER

APPROVED  
DATE 4-13-73 *Thomas P. Miller, Jr.*  
LAKE COUNTY ENGINEER

APPROVED  
DATE 4-14-73 *Robert E. Martin*  
*John J. Platz*  
BOARD OF COUNTY COMMISSIONERS, LAKE COUNTY

APPROVED  
DATE 4-19-73 *Joseph J. Powell*  
DISTRICT DEPUTY DIRECTOR OF TRANSPORTATION

APPROVED  
DATE 7-2-73 *E. J. Schaefer*  
ENGINEER, BUREAU OF BRIDGES

APPROVED  
DATE 7-2-73 *William E. Skell*  
ENGINEER, BUREAU OF ROADWAY DESIGN

APPROVED  
DATE 7-2-73 *William E. Skell*  
ASSISTANT DEPUTY DIRECTOR FOR HIGHWAY DESIGN

APPROVED  
DATE 7-2-73 *William E. Skell*  
ASSISTANT DEPUTY DIRECTOR FOR REAL ESTATE

APPROVED  
DATE 7-2-73 *William E. Skell*  
ASSISTANT DEPUTY DIRECTOR FOR PROGRAM DEVELOPMENT

APPROVED  
DATE 7-2-73 *W. W. Baker*  
DEPUTY DIRECTOR, DIVISION OF HIGHWAYS

APPROVED  
DATE 7-2-73 *William E. Skell*  
ASSISTANT DIRECTOR, DEPARTMENT OF TRANSPORTATION

APPROVED  
DATE 7-2-73 *William E. Skell*  
DIRECTOR, DEPARTMENT OF TRANSPORTATION

CONVENTIONAL SIGNS

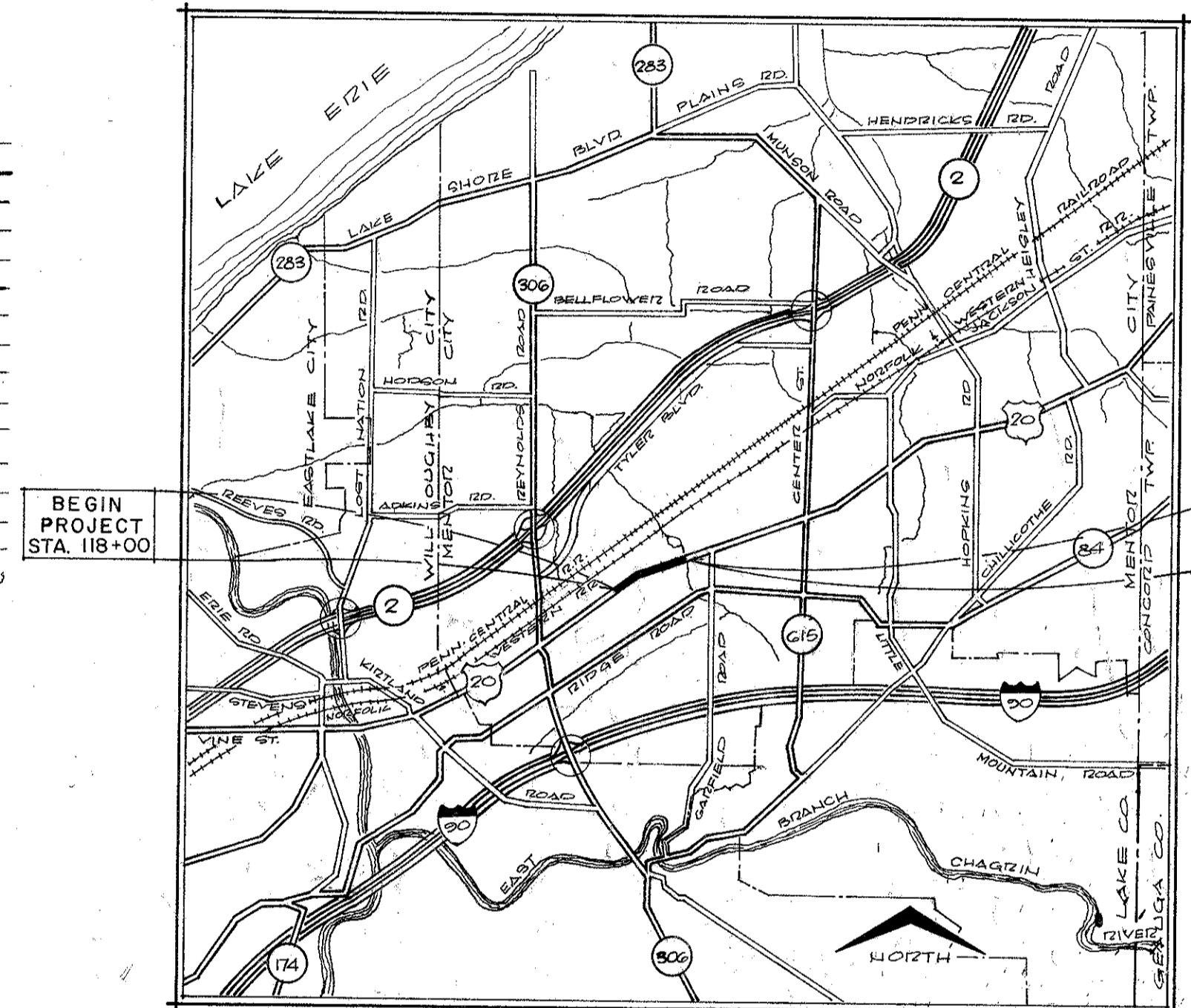

LOCATION MAP

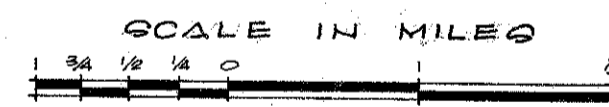

PORTION TO BE IMPROVED  
STATE ROADS  
OTHER ROADS

SCALES

SCALE IN FEET

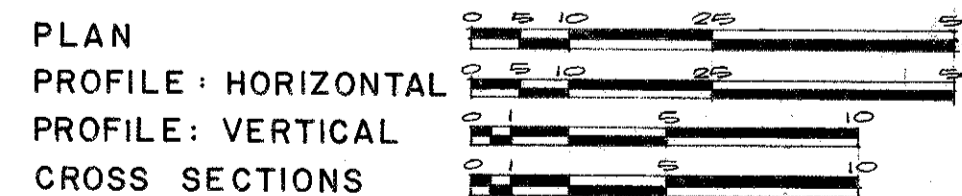

INDEX OF SHEETS

TITLE SHEET	1
SCHEMATIC PLAN	2
TYPICAL SECTION	3
GENERAL NOTES	4, 5
GENERAL SUMMARY	6, 7
PLAN AND PROFILE	8-17
STORM SEWER PROFILE	18, 19
SEWER PROFILES	20-22
DRAINAGE DETAILS	23-25
CULVERT DETAILS	26
MISCELLANEOUS DETAILS & SUMMARY OF QUANTITIES	27
EXTRA AREA, DRIVEWAY AND SIDEWALK DETAILS	28-35
CROSS SECTIONS	36-32

LINE DATA

BEGIN PROJECT	118+00
END PROJECT	139+25
TOTAL LENGTH OF PROJECT	2125 FT. (0.402 mi.)
BEGIN WORK	112+60
END WORK	144+40.45
TOTAL LENGTH OF WORK	3180.45 FT. (0.602 mi.)

SUPPLEMENTAL PRINTS OF STANDARD CONST. DRAWINGS

GR-2A	1-1-71	MC-1	1-1-70
BP-5	6-1-72	MC-3	6-1-73
BP-6	6-1-65	MC-4	6-13-68
BP-7	1-1-66	MH-1	10-1-68
GR-2B	11-9-71	MH-1A	10-1-68
GR-4	11-9-71	SP-53	6-30-61

SUPPLEMENTAL SPECIFICATIONS

834	1-1-68
1001	9-20-72
941	11-25-70

FILE No.	LAKE COUNTY
DATE OF LETTING	
CONTRACT No.	

PLANS PREPARED BY  
DEBEVEC SALO & ASSOCIATES INC.  
CIVIL ENGINEERS & SURVEYORS  
PAINESVILLE, OHIO