

TYPICAL CROSS-SECTIONS

NO 1 & NO 2 FOR
10'-8"-8'-10" CONCRETE ITEM T-71
2 1/2" ASPHALTIC CONCRETE T-50

FED AID DIST.	STATE	FED. AID PROJECT	FISCAL YEAR	2/39
10	OHIO	66-1(4) 5(3)	1938	
ASHTABULA COUNTY		LAKE COUNTY		
S.H. 2 SEC.		M.P.T.		
LAKE COUNTY		S.H. 2 SEC. Q.(PT.)		

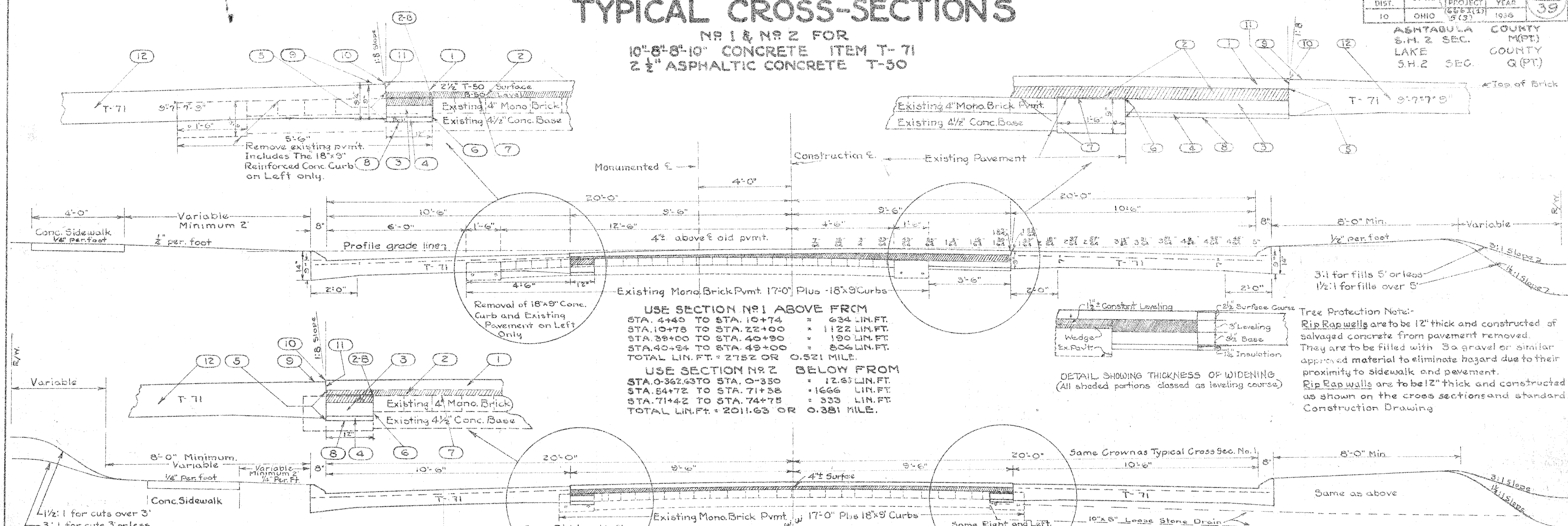

USE SECTION NO 1 ABOVE FROM
 STA. 4+49 TO STA. 19+74 = 634 LIN. FT.
 STA. 10+78 TO STA. 22+00 = 1122 LIN. FT.
 STA. 39+00 TO STA. 40+90 = 190 LIN. FT.
 STA. 40+94 TO STA. 49+00 = 806 LIN. FT.
 TOTAL LIN. FT. = 2752 OR 0.521 MILE.

USE SECTION NO 2 BELOW FROM
 STA. 0+362.63 TO STA. 0+350 = 12.63 LIN. FT.
 STA. 54+72 TO STA. 71+38 = 1666 LIN. FT.
 STA. 71+42 TO STA. 74+78 = 333 LIN. FT.
 TOTAL LIN. FT. = 2011.63 OR 0.381 MILE.

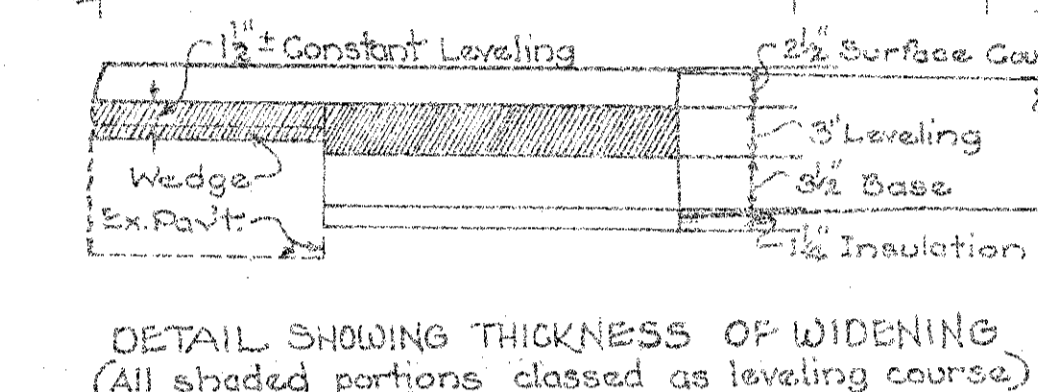

Tree Protection Note:
 Rip Rap walls are to be 12" thick and constructed of salvaged concrete from pavement removed. They are to be filled with 30 gravel or similar approved material to eliminate hazard due to their proximity to sidewalk and pavement.
 Rip Rap walls are to be 12" thick and constructed as shown on the cross sections and standard Construction Drawing.

- 1 2 1/2" Asphaltic Concrete Surface Course Item T-50 1" Type B wearing Course, 1/2" Binder Course.
- 2 Asphaltic Concrete Leveling Course, Item B-50 using "Binder" Composition. Base widening and all depressions in old pavement shall be spread by strike off or raked by hand, setting joints by rakes along edges of curb or projecting brick as shown at (Z-B) and finished 1/2" above all projections when Compaction is completed.
- 3 3/2" Asphaltic Concrete Base Course, Item B-50 to be struck off by hand template and compacted by power tamper or approved compression strips and roller or special trench roller designed for trench compaction.
- 4 1 1/4" Insulation Course, Item B-11 to be struck off by hand and tamped with hand tamps.
- 5 Sealing only, 7/8" of vertical face of new Concrete Surface Course using emulsion Section M-5.7 A.E.3 applied at the rate of 0.25 gal. per sq. yd. in two applications. Item E:10
- 6 Sealing only, exposed face of old curb and pavement with the same material and at the same rate as under note 5
- 7 Bituminous Prime Coat, Item T-30, of bituminous material M. 5.7 A.E.3 applied by distributor or by brooms at the rate of 0.2 gallons per sq. yd. and sand cover. Section M-2.1 uniformly spread at the rate of from 4 to 7 pounds per sq. yd. After bituminous material is applied, all material not required to give a uniform coating to the base shall be swept in to all cracks and open joints before sand cover is placed (Payment for sand cover included in Bituminous Material).
- 8 Subgrade for bituminous base widening sections, shall be prepared and compacted at the time the subgrade is constructed for the concrete widening Lane
- 9 For that portion of the concrete pavement within 9' of the bituminous surface, the limiting smoothness requirements shall be 1/8" in a 10' length
- 10 Finish Yearing Course 1/2" above edge of concrete
- 11 Bituminous Seal applied by brush, or poured as directed, payment included in price bid for Item T-50 Surface Course.
- 12 9'-7'-9" Reinforced Concrete Surface Course Item T-71

CONSTRUCTION NOTES

The Contractor shall complete the South Side concrete and B-50 Base widening before excavating for the North Side widening or as the Engineer may direct

Sewer Crossovers: Where openings are made across the highway for culverts and sewers connections, same shall be backfilled as soon as provisions of par. 527.04 of the specifications have been complied with in order to provide a minimum of inconvenience for two way traffic.

The contractor shall maintain two-way traffic on this project and protect his work and traffic at all times with at least two Watchmen. He shall also maintain lights not to exceed 200 ft. apart along the work and all other necessary lights, signs, and barricades required to insure proper protection at all times, and provide for laying dust at the direction of the Engineer.

Superelevated curves shall be built without crown. The crown shall be worked out of the pavement in that portion between the beginning of the transition and the point where the superelevation equals twice the crown.

Note: Attention is directed to the 4" dimension representing the height of the new grade line above the old pavement. The dimension is based on the new profile grade line shown on the plans. This grade line shall be adjusted during construction in order that leveling course quantities do not exceed the amount set up in the summary.

DETAIL OF NO 2 LOOSE STONE DRAIN

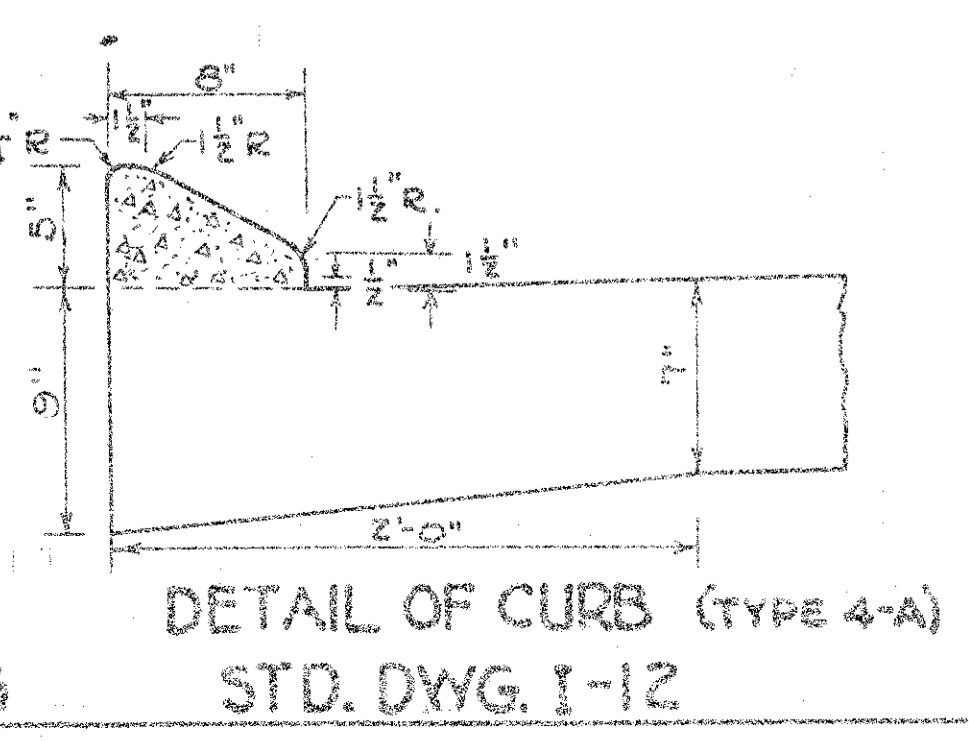
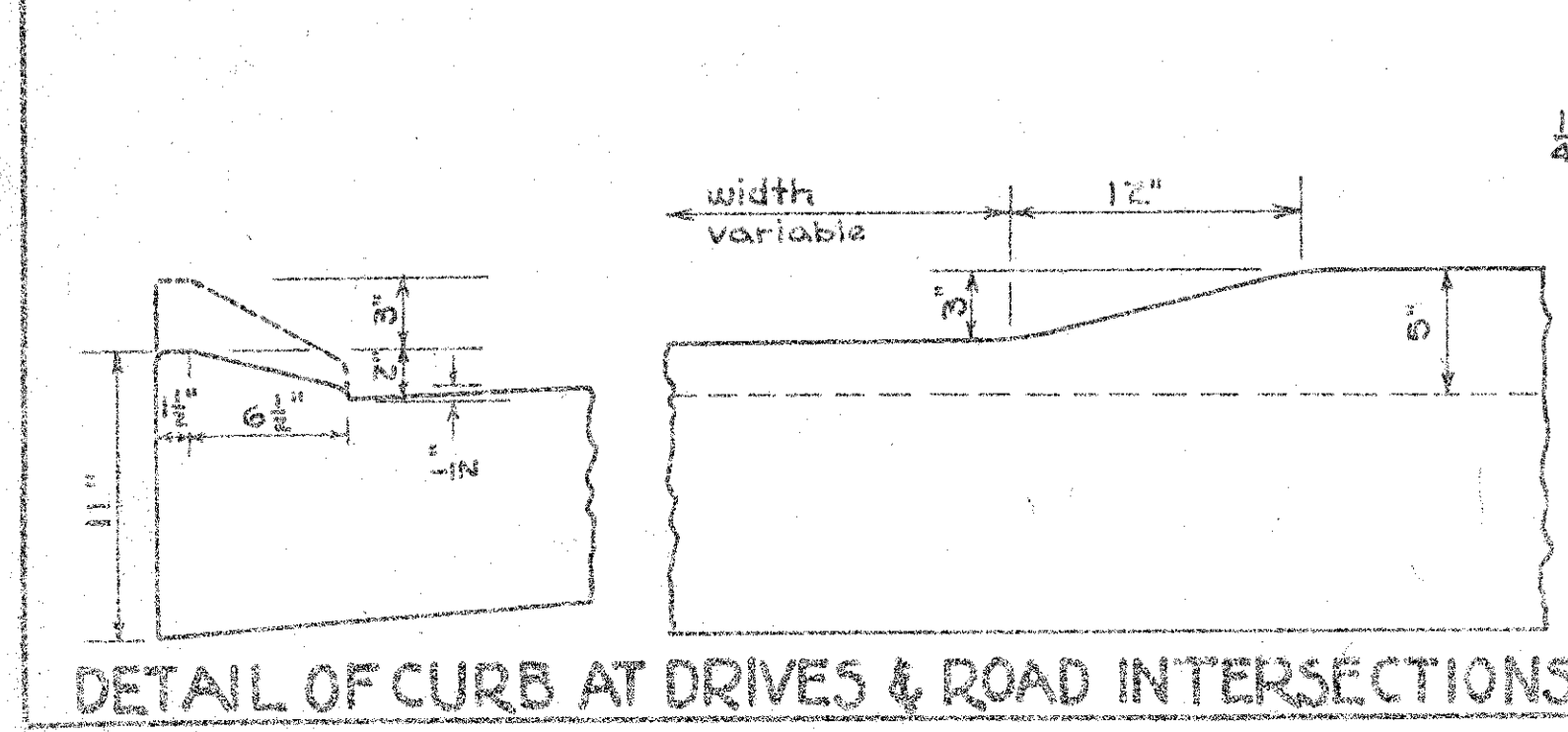
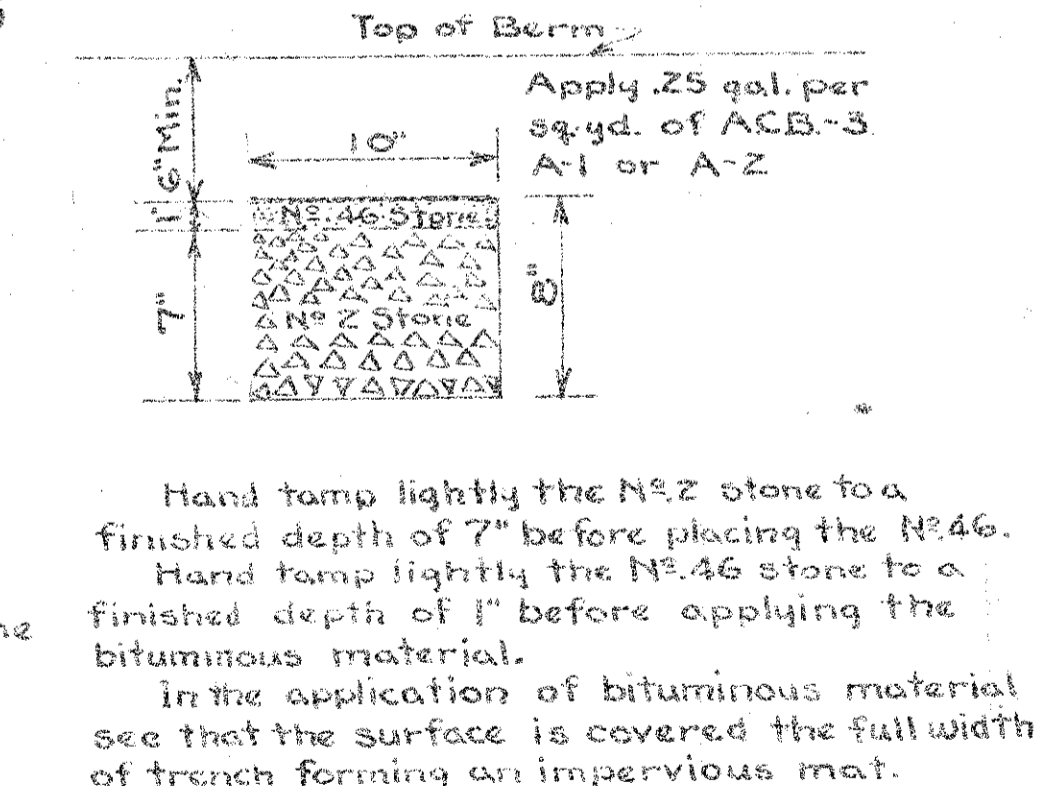

SEE SHEET NO. 3
FOR TYPICAL - SECTION OF
FULL WIDTH NEW BASE

