

LAK-20-9.47

PART OF ORIGINAL CHURCH
LOT AND PARKS LOT
CONNECTICUT WESTERN RESERVE
CITY OF MENTOR, LAKE COUNTY, OHIO

SMITH & HART ADDITION
VOL. A, PG. 113

LOT #2

COMMERCIAL
(21)

MCGLONE PROPERTIES LTD
8529 MENTOR AVE
MENTOR, OH 44060
INST. NO. 2004R000679
P.N. 16B042000030
0.640 ACRES

SMITH & HART ADDITION
VOL. A, PG. 113
LOT #36

COMMERCIAL
(27)
THE STATE BANK & TRUST
COMPANY OF LAKE COUNTY
MENTOR AVE
MENTOR, OH 44060
VOL. 776, PG. 1363
P.N. 16B0460000180
0.510 ACRES

COMMERCIAL
(29)
BACOR LTD., AN OHIO
LIMITED LIABILITY COMPANY
8565 MENTOR AVE
MENTOR, OH 44060
INST. NO. 2007R037075
P.N. 16B0460000200
0.640 ACRES

EXEMPT
(26)
CITY OF MENTOR, AN OHIO
MUNICIPAL CORPORATION
MENTOR AVE
MENTOR, OH 44060
INST. NO. 2001R030267
P.N. 16B0460000370
0.701 ACRES (deed acres)

LOT #34

LOT #35

COMMERCIAL
(22)
JESSE L. ANDREWS
VOL. 37, PG. 585
0.228 (c) ACRES

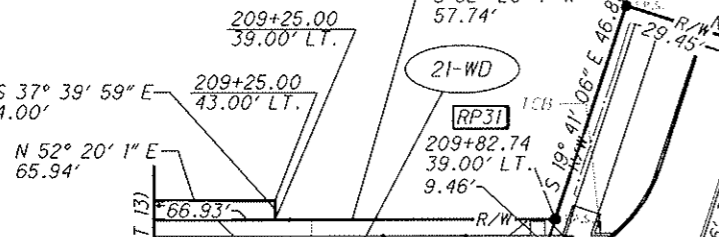

COMMERCIAL
(23)
WILLIAM W. KERR
VOL. 30, PG. 406
0.075 (c) ACRES

COMMERCIAL
(24)
OHIO REAL ESTATE BUILDING LLC
8532 MENTOR AVE
MENTOR, OH 44060
INST. NO. 2005R036567
P.N. 16A012J000010
0.680 ACRES

COMMERCIAL
(25)
THE MOST REVEREND
ANTHONY M. PILLA, BISHOP,
CATHOLIC DIOCESE OF
CLEVELAND, OHIO
8540 MENTOR AVE
MENTOR, OH 44060
INST. NO. 2002R027263
P.N. 16A0120000030
10.949 ACRES

COMMERCIAL
(28)
ELIZABETH A VENTO &
JOSEPH P. VENTO, HUSBAND & WIFE
8558 MENTOR AVE
MENTOR, OH 44060
INST. NO. 2011R013878
P.N. 16A012B000010
0.780 ACRES

COMMERCIAL
(30)
JOSEPH P. VENTO &
ELIZABETH A VENTO
8570 MENTOR AVE
MENTOR, OH 44060
INST. NO. 2011R012921
P.N. 16A012B000020
0.280 ACRES

BLOCK "A"
MURRAY ESTATES
SUBDIVISION
VOL. J, P.G. 1

* STA. 210+01.62 @ CONSTRUCTION & R/W U.S.R. 20 =
STA. 25+00.00 @ CONSTRUCTION HART ST. (S.R. 615)

- A - N 37° 39' 59" W, 7.00'
- B - S 52° 20' 1" W, 29.89'
- C - N 38° 26' 42" W, 5.00'
- D - S 37° 39' 59" E, 5.00'

| REV. BY | DATE | DESCRIPTION |
|---------------------------|------|-------------|
| | | |
| | | |
| | | |
| | | |
| DATE COMPLETED 11/13/2015 | | |

15 / 15

146 / 146

RIGHT OF WAY BOUNDARY SHEET
STA. 209+00.00 TO STA. 214+00.00

LAK-20-9.47

PID NO. 98679

SCALE: 1" = 20'

DESIGNED: CSW
CHECKED: RFM