

LAKE COUNTY
LAK-20-G.65

CALC: P.G.B. 9-83
CHK: R.O.B. 9-83

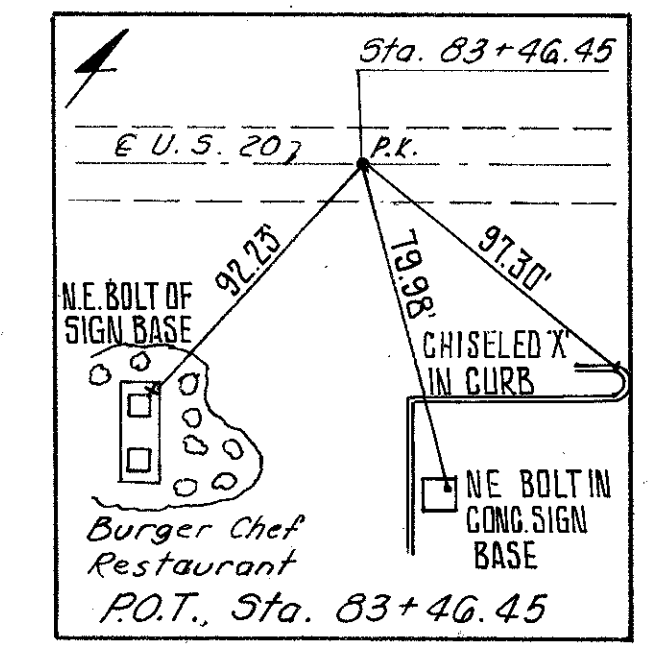

LEGEND

- 8" ITEM 462
- 1" ITEM 404 ON 5" ITEM 301
- 10" ITEM 304
- ITEM 202 - PAVEMENT REMOVED
- ITEM 202 - WALK REMOVED

CALCULATIONS

- R-1 (25x16) ÷ 9 = 44.4 S.Y.
- R-4 [(24.5 x 4.5) + (21.5 x 20)] ÷ 9 = 60.0 S.Y.
- R-5 (18.5 x 5.5) = 101.8 S.F.
- R-6 (30.5 x 5.5) = 167.8 S.F.
- R-7 (29.0 x 5.5) = 159.5 S.F.
- R-10 (41 x 5.5) ÷ 9 = 25.0 S.Y.
- R-11 (18.5 x 5.5) ÷ 9 = 11.3 S.Y.
- R-13 (5.0 x 14.5) = 72.5 S.F.
- R-15 (25 x 4.5) = 112.5 S.F.

NOTES:

1. FOR STORM SEWER PROFILES SEE SHEET NO. 18.
2. FOR PAVEMENT DETAILS SEE SHEET NO. 14.
3. FOR PAVEMENT, DRIVE, SIDEWALK, CURB + GUTTER QUANTITIES SEE CALCULATIONS SHEET NO. 15.
4. FOR CROSS SECTIONS SEE SHEET NO. 51-52.
5. FOR DRIVE DETAIL SEE SHEET NO. 22.
6. * TO BE REMOVED UNDER ITEM 201 CLEARING AND GRUBBING.
7. R-8 REMOVE CONC. BLOCK WALL TO 1' BELOW PROPOSED GRADE.

* W/706.11 JOINTS; USING ECCENTRIC CONE TO AVOID CURB AND GUTTER.

REF.	STATION TO STATION	SIDE	202					604		604 SANITARY MANHOLE ADJUSTED TO GRADE
			DRAIN + GUTTER REMOVED	CURB REMOVED	PAVEMENT REMOVED	TALK REMOVED	CATCH BASIN REMOVED	MANHOLE REMOVED	PORTION OF STRUCTURE REMOVED	
			L.F.	L.F.	S.Y.	S.F.	EA.	EA.	LUMP	EA.
D-1	85+07.6	LT.								
D-2	85+06	RT.								
R-1	84+00 TO 84+25	RT.			44.4					
R-2	84+30	LT.								
R-3	84+24	RT.								
R-4	84+37 TO 84+64	LT.			60.0					
R-5	82+00 TO 82+21	LT.				101.8				
R-6	82+57 TO 82+93	LT.				167.8				
R-7	83+07 TO 86+00	LT.				159.5				
R-8	85+47 TO 85+90	LT.						LUMP		
R-9	82+00 TO 83+68	LT.	16.8							
R-10	82+16 TO 82+62	LT.			25.0					
R-11	82+88 TO 83+11	LT.			11.3					
R-12	83+77 TO 84+00	RT.		30						
R-13	84+55 TO 86+00	RT.				725.0				
R-14	85+43 TO 85+74	RT.		31						
R-15	82+25 TO 82+50	RT.				112.5				
TOTALS			116.8	61	141	2702			LUMP	

