

TYPICAL SECTIONS

TYPE 404

FHWA REGION	STATE	PROJECT	
5	OHIO		

3
114

LAKE COUNTY
LAK-20-G.05

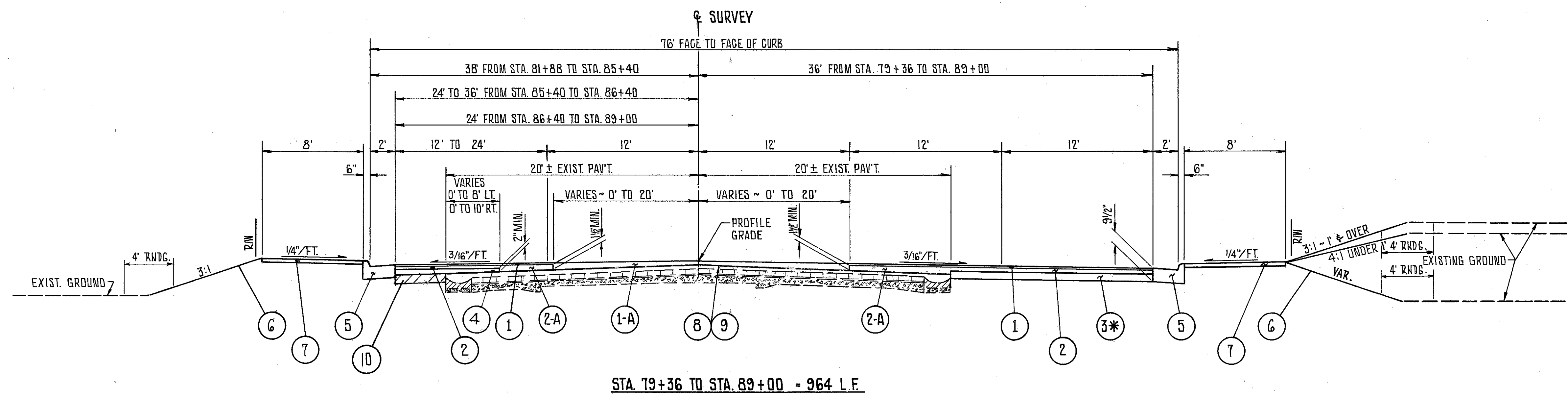
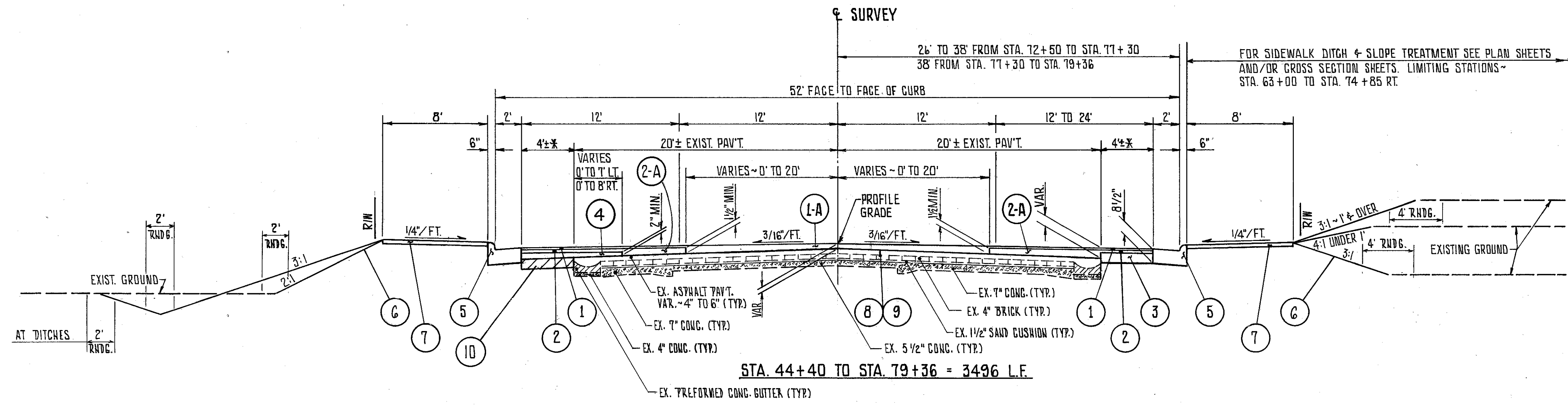

REF.	ITEM	DESCRIPTION
①	404	1/4" ASPHALT CONCRETE, AC-20.
②	402	1 3/4" ASPHALT CONCRETE AC-20.
③	301	5 1/2" BITUMINOUS AGGREGATE BASE, AC-20, RT-11 OR RT-12.
③*	301	6 1/2" BITUMINOUS AGGREGATE BASE, AC-20, RT-11 OR RT-12.
④	301	VAR. T. BITUMINOUS AGGREGATE BASE, AC-20, RT-11 OR RT-12.
⑩		TEMPORARY PAVEMENT, CLASS 'B'. (SEE MAINTENANCE OF TRAFFIC PLANS)

REF.	ITEM	DESCRIPTION
⑤	609	COMBINATION CURB AND GUTTER, TYPE 2 (MODIFIED AS PER PLAN).
⑥	660	SODDING.
⑦	608	4" CONCRETE WALK.
⑧	407	TACK COAT
⑨	407	COVER AGGREGATE
①-A	404	VARIABLE THICKNESS ASPHALT CONCRETE AC-20 (1/4" TO 2 3/4").
②-A	402	VARIABLE THICKNESS ASPHALT CONCRETE AC-20 (1/2" TO 3 3/4").

- NOTES**
1. * TAPER PROPOSED PAVEMENT 2' TO 4" IN 80' FROM STA. 44+40.00 TO STA. 45+20.00 AND 2' TO 4" IN 80' FROM STA. 45+20.00 TO STA. 46+00.00
 2. TYPICAL SECTIONS ARE INTENDED TO SHOW GENERAL ROADWAY AND PAVEMENT FEATURES ONLY. FOR FURTHER DETAILS SEE REMAINING PLAN AND PROFILES, PAVEMENT DETAILS, AND CROSS SECTIONS.
 3. MODIFIED THE ⑤ THICKNESS ON THE TYPE 2 CURB AND GUTTER TO MEET THE PROPOSED PAVEMENT BUILD-UP OF EITHER 8 1/2" OR 9 1/2".
 4. FINISHED GRADE ON ITEM 404 TO BE 1/4" ABOVE GUTTER PLATE.
 5. TYPICALS NOT DRAWN TO SCALE.