

COLOR SEQUENCE CHART

SIGNAL NO	LENS	DIAL SETTINGS (Seconds)				
		57	3	2	15	3
		INTERVAL				
		1	2	3	4	5
1	R					
	Y					
	G					
2	R					
	Y					
	G					
3	R					
	Y					
	G					

Offset 1 = Average
 Offset 2 = Inbound
 Offset 3 = Outbound

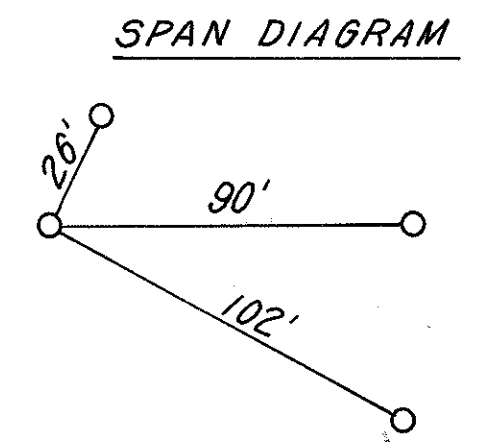
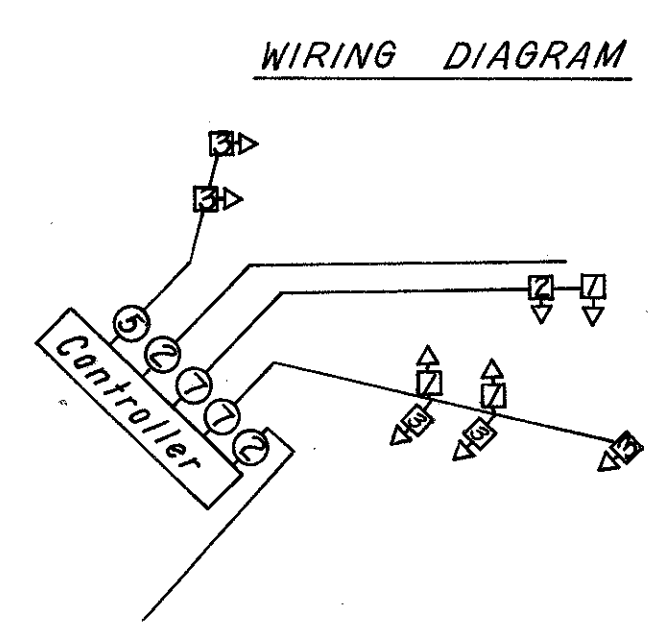

NOTE: Power to be supplied underground from existing sign

NOTE: **SECTION TO BE MADE INOPERATIVE AFTER CONNECTION

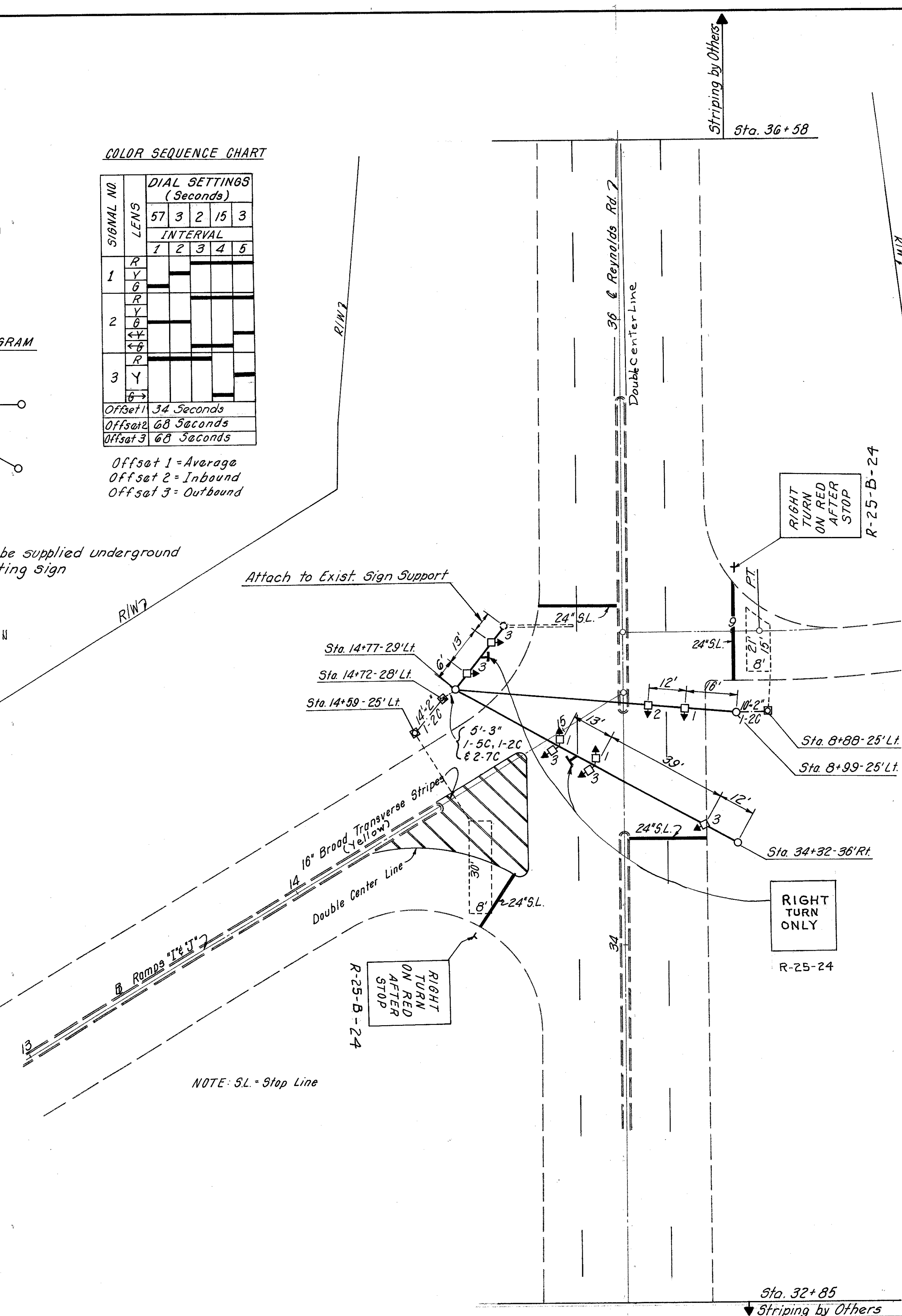

CALC: *[Signature]* 4-73
 CHK: *[Signature]* 4-73

2

QUAN.	UNIT	ITEM	DESCRIPTION
3	EA.	816	SIGNAL STRAIN POLE 3 GA., 12" x 30'
218	L.F.	816	MESSENGER WIRE 7 STRAND 3/8" WITH ACCESSORIES
6.5	C.Y.	816	CONCRETE FOR SIGNAL SUPPORT FOUNDATIONS
0.8	C.Y.	816	CONCRETE FOR CONTROLLER AND PEDESTAL FOUNDATIONS
4	EA.	G25	TRAFFIC SIGNAL HEAD, 3 SECTION, 12" LENS, ONE-WAY
1	EA.	G25	TRAFFIC SIGNAL HEAD, 5 SECTION, 12" LENS, ONE-WAY
2	EA.	G25	TRAFFIC SIGNAL HEAD, 3 SECTION, 12" LENS, TWO-WAY
1	EA.	G25	SIGNAL CONTROLLER (2 PHASE DIGITAL SOLID STATE TRAFFIC TIMER)
1	EA.	G25	SIGNAL CONTROL CABINET, 7.7 C.F.
1	EA.	G25	10 CHANNEL DECODER
2	EA.	G25	LOOP DETECTOR AMPLIFIER
1	EA.	G25	POWER SERVICE
72	L.F.	G25	SIGNAL CABLE 5/8 NO. 14 AWG IMSA 19-1-67
275	L.F.	G25	SIGNAL CABLE 7/8 NO. 14 AWG IMSA 19-1-67
370	L.F.	G25	LOOP DETECTOR WIRE, NO. 14 AWG, RHW OR RHW TYPE
192	L.F.	G25	LOOP DETECTOR LEAD-IN CABLE, 2/C NO. 14 AWG, TWISTED PAIR, SHIELDED
50	L.F.	G25	POWER CABLE 3/8 NO. 8 AWG STRANDED RHW OR RHW TYPE
5	EA.	G25	CABLE SUPPORT ASSEMBLY
161	L.F.	G25	LOOP DETECTOR PAVEMENT CUTTING
4	EA.	G25	GROUND ROD
2	EA.	G25	PULL BOX 18" CIRCULAR 713.03, AS PER PLAN
24	L.F.	G25	CONDUIT 2" 713.04, TYPE III
5	L.F.	G25	CONDUIT 3" 713.04, TYPE III
29	L.F.	G25	TRENCH
9	EA.	G25	COVERING OF TRAFFIC SIGNAL HEADS
20	S.F.	815	SIGNS FLAT SHEET TYPE, AS PER PLAN
27	L.F.	816	STRUCTURAL SUPPORT, 6 LB. BEAM, DRIVEN
0.14	MI.	G21	4" LANE LINES, THERMOPLASTIC
0.04	MI.	G21	CENTER LINES, DOUBLE, THERMOPLASTIC (SOLID)
100	L.F.	G21	24" STOP LINES, THERMOPLASTIC AS PER PLAN
123	L.F.	G21	16" BROAD TRANSVERSE STRIPES,
2	EA.	816	SPAN WIRE MOUNTED SIGN ATTACHMENT, AS PER PLAN