

MICROFILMED
DEC 11 1984

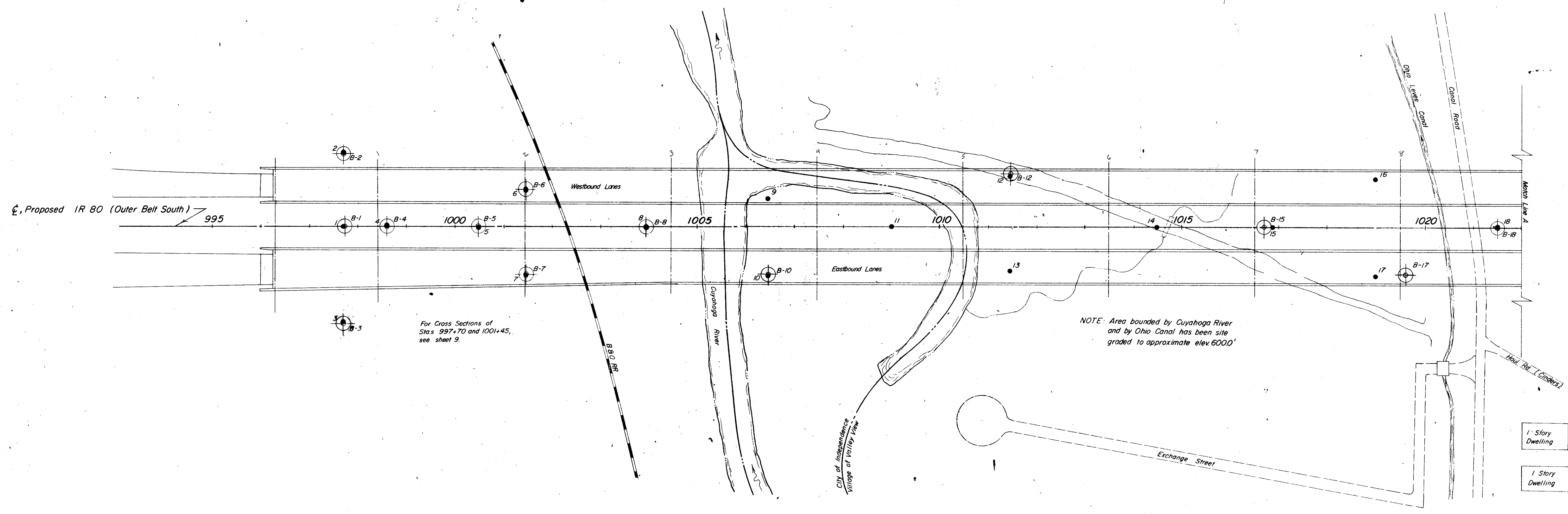

For Cross Sections of
Stas. 997+70 and 1001+45,
see sheet 9.

NOTE: Area bounded by Cuyahoga River
and by Ohio Canal has been site
graded to approximate elev. 6000'

Revised 8/23/68

OHIO DEPARTMENT OF HIGHWAYS TESTING LABORATORY 1620 WEST BROAD STREET, COLUMBUS 23, OHIO			
STRUCTURE FOUNDATION INVESTIGATION			
BRIDGE NO. CUY-IR 80-1843 L/R			
OVER CUYAHOGA RIVER VALLEY			
SEC. CUY-IR 80-18.43			
BORING PLAN			
DRAWN BY	CHECKED BY	REVIEWED BY	DATE
L. N. L.	R. D. R.	G. P. H.	10/27/65