

LAKE COUNTY
LAK-20-5.60

CALC: 208 7/77
CHK: W.O.K. 8/77

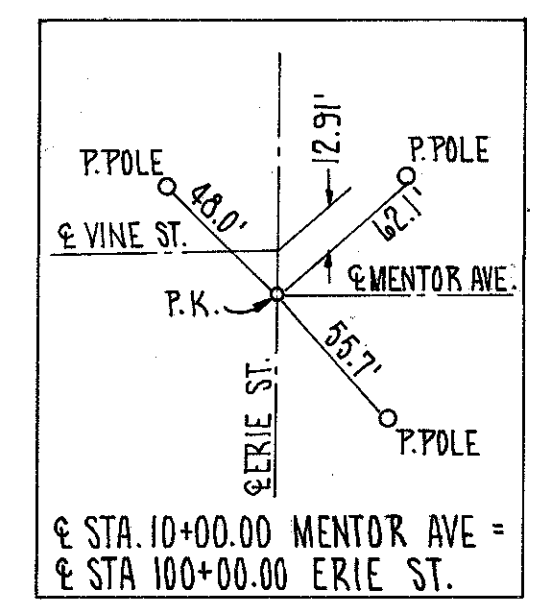

- LEGEND**
- 1" ITEM 404 ASPHALT CONCRETE ON 5" ITEM 301 BITUMINOUS AGGREGATE BASE
 - 8" ITEM 452 PLAIN PORTLAND CEMENT CONCRETE PAVEMENT
- NOTES**
- FOR PAVEMENT DETAILS SEE SHEET 43
 - FOR DRIVE PROFILES SEE SHEET 31 & 32
 - FOR DRIVE DETAILS SEE SHEET 6.7 & 43
 - FOR STORM SEWER PROFILES SEE SHEET 21 & 32
 - FOR EXISTING UNDERGROUND UTILITIES SEE SHEET 31 & 32

* INCLUDES ALL CONCRETE DRIVE APPROACHES
** 706.01, 706.02, 706.08 WITH JOINTS AS PER 706.11 OR 706.12 + AS PER PLAN

REF.	STATION TO STATION	SIDE	ITEMS TO BE REMOVED																	
			202 CURB REMOVED	202 SIDEWALK REMOVED	202 PAVEMENT REMOVED	202 MANHOLE ABANDONED	6" TYPE 'B' * * *	8" TYPE 'B' * * *	12" TYPE 'B' * * *	MANHOLE TYPE 1 +	MANHOLE TYPE 3	No. 3 CATCH BASIN	No. 3A CATCH BASIN	MANHOLE ADJUSTED TO GRADE						
22-R	98+00 TO 99+92	LT.	320																	
23-R	98+37 TO 98+68	LT.	36																	
24-R	98+00 TO 99+80	RT.	238																	
25-R	98+75 TO 99+10	RT.	41																	
26-R	100+29 TO 102+00	LT.	241																	
27-R	100+24 TO 102+00	RT.	242																	
28-R	98+68 TO 98+73	LT.		50																
29-R	98+00 TO 99+91 *	LT.		2857																
30-R	98+00 TO 99+79 *	RT.		2805																
31-R	10+37 TO 10+81 U.S. 20	RT.	61																	
32-R	100+30 TO 102+00 *	LT.		1874																
33-R	100+25 TO 102+00 *	RT.		1200																
38-R	10+25 TO 11+00	L & R			300															
39-R	101+35	RT.				1														
1-D	101+35.2	RT.					16	16												
2-D	99+14	L & R							62											
3-D	99+14 TO 99+71	RT.							56											
4-D	99+23	RT.																		
5-D	100+13	RT.																		
6-D	101+31	LT.																		
7-D	99+71 ERIE ST. TO 10+82 U.S. 20	RT.								71										
TOTALS			1179	8786	300	1	16	16	189	1	1	1	1	1	1	1	1	1	1	3

REF.	STATION TO STATION	SIDE	202 STEEL POSTS REMOVED			202 CONC. FND. REMOVED			202 STRUCTURE REMOVED			REF.	STATION TO STATION	SIDE	202 CONC. FND. REMOVED			202 STRUCTURE REMOVED			301 BITUMINOUS AGGR. BASE			
			EA.	EA.	LUMP	EA.	EA.	LUMP	EA.	EA.	LUMP				EA.	EA.	LUMP	EA.	EA.	LUMP	C.Y.			
1-R	98+34	RT.			1							16-R	100+74	LT.										
2-R	98+43	LT.			1							17-R	101+95	LT.										
3-R	98+70	LT.						LUMP				18-R	99+46	RT.										
4-R	98+72	RT.						LUMP				19-R	99+66	RT.										
5-R	98+76 TO 99+12	LT.						LUMP				20-R	99+79	RT.										
6-R	98+90	RT.			1			LUMP				21-R	99+71	LT.										
7-R	99+58 TO 99+65	RT.			2																			
8-R	99+70 TO 99+78	LT.			1							34-R	101+09	LT.										
9-R	9+32 TO 9+37 VINE ST.	RT.						LUMP				35-R	101+63	LT.										
10-R	100+40	RT.						LUMP				36-R	99+49	RT.										
11-R	100+48	LT.						LUMP				37-R	99+80	LT.										
12-R	100+52 TO 100+59	LT.			2																			
13-R	100+60	RT.			1																			
14-R	100+69	RT.			2			LUMP				1-P	99+14	L & R										10
15-R	100+73	RT.						LUMP																
TOTALS			3	8	LUMP							TOTALS			1	4	LUMP	10						

