

LAKE S.H. N^o 2 COUNTY SEC. Q (Pt.)
1 1/2 Mi. E. of N. Madison

PROFILE ON PROPOSED CENTER LINE

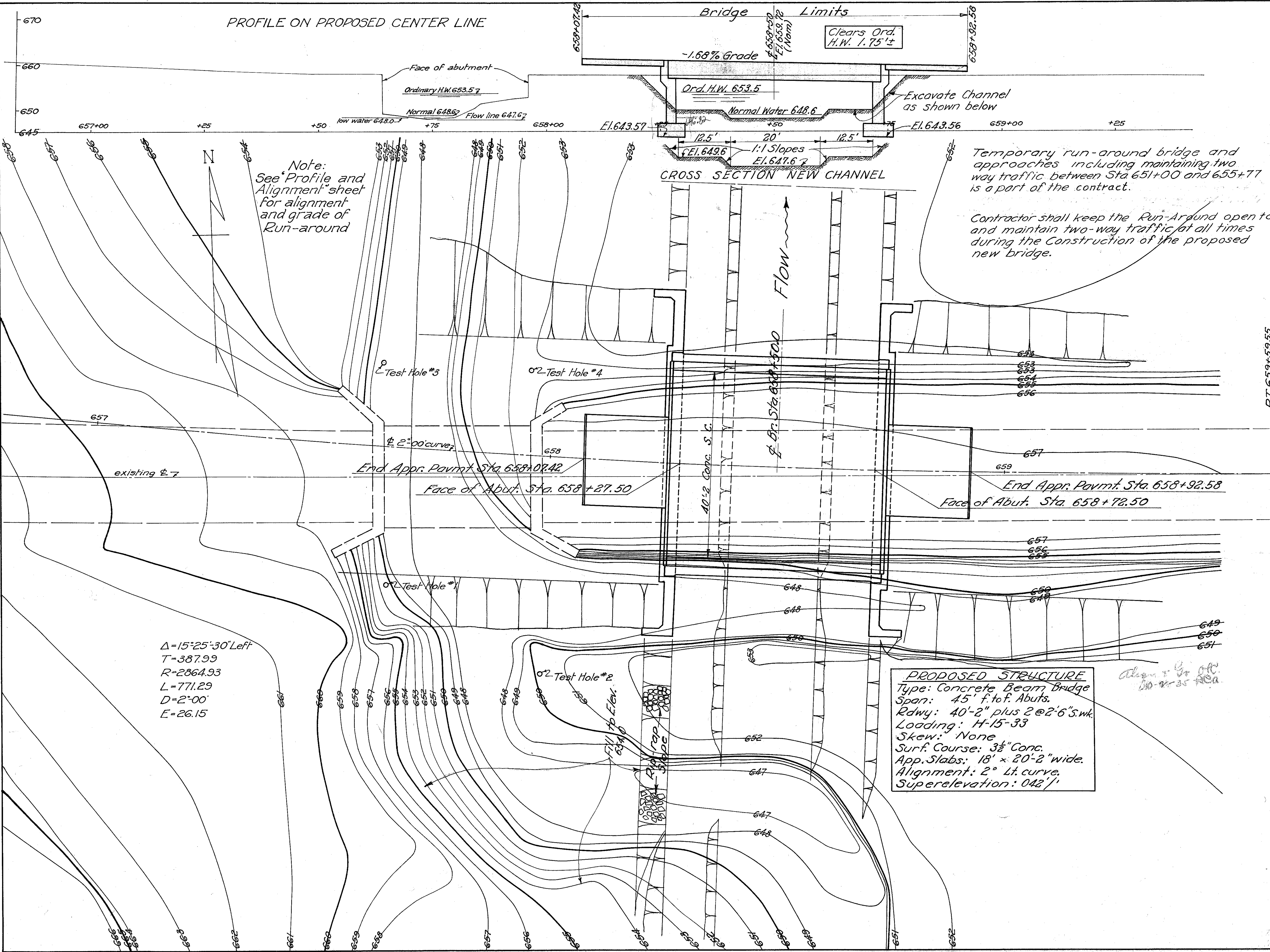

Note:
See 'Profile and Alignment' sheet for alignment and grade of Run-around

CROSS SECTION NEW CHANNEL

Temporary run-around bridge and approaches including maintaining two way traffic between Sta 651+00 and 655+77 is a part of the contract.

Contractor shall keep the Run-Around open to and maintain two-way traffic at all times during the construction of the proposed new bridge.

PRESENT STRUCTURE (TO BE REMOVED)
Type-Concrete Beam
Span 32' Roadway 20'
Surface Course 4' brick
Sandstone abutments,
faced with concrete.

DRAINAGE AREA 17.75 SQ. MI.

This test hole information was obtained by diligent effort and is believed to correctly represent the character and location of the subsoil materials; but the State of Ohio does not guarantee its accuracy

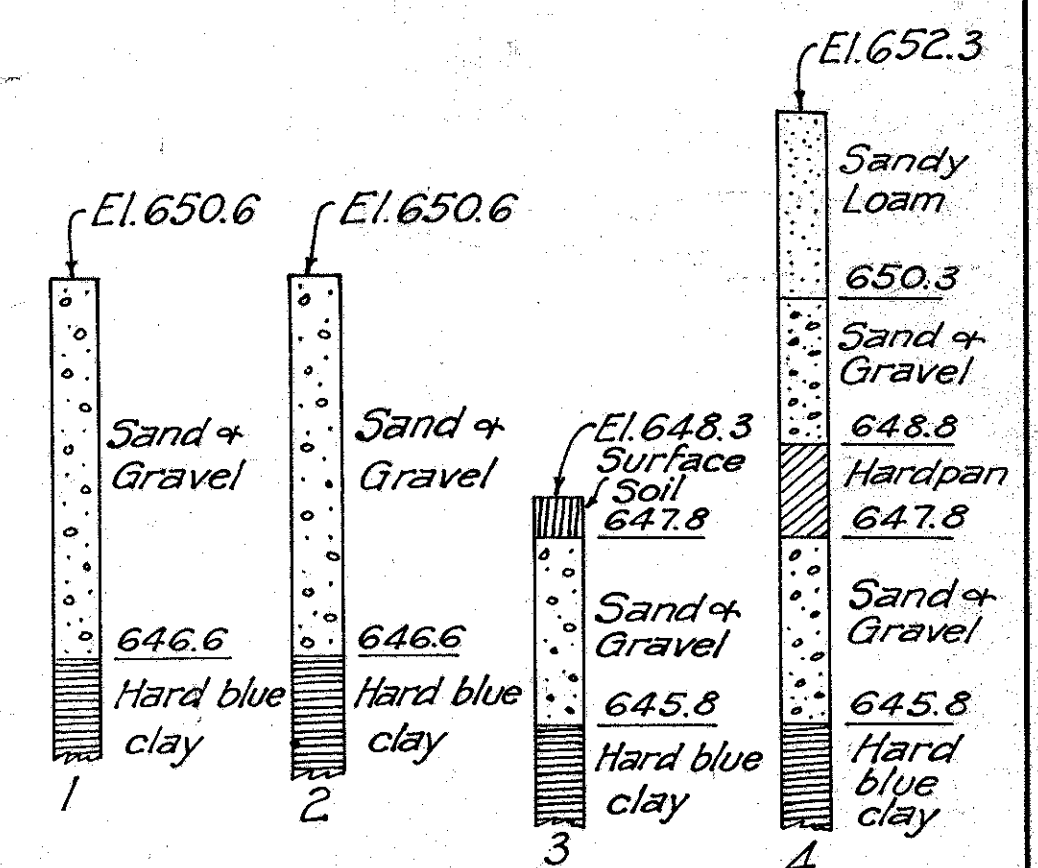

TEST HOLE DATA
6" Hand auger used in making test holes.

PROPOSED STRUCTURE
Type: Concrete Beam Bridge
Span: 45' f. to f. Abuts.
Rdwy: 40'-2" plus 2 @ 2'-6" S.W.
Loading: H-15-33
Skew: None
Surf. Course: 3 1/2" Conc.
App. Slabs: 18' x 20'-2" wide.
Alignment: 2° Lt. curve.
Superelevation: 0.42/1'

$\Delta = 15^\circ 25' 30''$ Left
T = 387.99
R = 2864.93
L = 771.29
D = 2'-00'
E = 26.15

SITE PLAN AND TEST HOLE DATA
S.H. (I.C.H.) N^o 2 SEC. Q (Pt.)
ARCOLE CREEK
N^o LA-20-298
LAKE COUNTY
STATE OF OHIO

SCALE 1" = 10'		STA. 658+50	
PRES. TOPOGRAPHY		PROPOSED WORK	
Surveyed	Drawn	Des.	Drn.
Ckd.	Rev.	Ckd.	Rev.
R.B.L.	A.H.C.	C.H.A.	C.H.A.