

REINFORCING STEEL LIST

MARK	TOTAL	LENGTH	WEIGHT	TYPE	A	B	C	D	E
SUPERSTRUCTURE									
S 501	54	4'-10"	272	1	1'-11"	1'-3"	1'-11"		
S 502	54	5'-10"	329	1	3'-2"	11"	2'-0"		
S 503	32	22'-2"	740	STR.					
S 504	8	6'-1"	51	3	1'-10"	10"	1'-0"	2'-2"	1'-2"
S 505	4	8'-8"	36	1	4'-0"	11"	4'-0"		
S 601	24	23'-3"	838	STR.					
S 602	8	24'-5"	293	STR.					
S 603	4	23'-11"	144	STR.					
S 801	54	4'-10"	696	2	1'-4"	3'-8"			
			3399						
#5X29" DOWEL-IN	16	2'-5"	40	STR.					
#6X29" DB-SAE	16	2'-5"	58	STR.					
#6X34" DOWEL-IN	18	2'-10"	77	STR.					
#7X34" DB-SAE	18	2'-10"	104	STR.					
			279						

MICROFIL
OCT 8 1986

F. PATCHING: THE MIXING, PROPORTIONING, PLACING AND CURING PROCEDURES AND THE TOOLS, EQUIPMENT, LABOR AND MATERIALS USED SHALL BE ACCORDING TO THE MANUFACTURER'S SPECIFICATIONS AND RECOMMENDATIONS EXCEPT THAT NO AGGREGATE SHALL BE ADDED TO THE MAGNESIUM PHOSPHATE MATERIALS. WHEN FORMS ARE USED MATERIAL SHALL BE PLACED THROUGH AT LEAST ONE HOLE AT THE HIGHEST POINT OF THE AREA TO BE PATCHED. THE FORMS SHALL BE TAPPED TO VIBRATE THE MATERIAL AND INSURE THAT IT REACHES THE LOWEST REGIONS OF THE PATCH AREA. THE SURFACE OF THE REPAIR AREA SHALL BE FLUSH WITH THE SURROUNDING AREA.

G. CURING: PATCHES SHALL BE CURED IN ACCORDANCE WITH THE MANUFACTURER'S RECOMMENDATIONS.

H. METHOD OF MEASUREMENT: THE QUANTITY SHALL BE THE ACTUAL AREA IN SQUARE FEET OF THE EXPOSED SURFACE OF ALL COMPLETED PATCHES, IRRESPECTIVE OF DEPTH OR THICKNESS OF THE PATCH COMPLETE, IN PLACE AND ACCEPTED. IF THE PATCH INCLUDES CORNERS OR EDGES OF MEMBERS ALL OF THE EXPOSED SURFACES SHALL BE INCLUDED, OR IF A PATCH EXTENDS COMPLETELY THROUGH A MEMBER BOTH EXPOSED SURFACES SHALL BE INCLUDED.

I. BASIS OF PAYMENT: PAYMENT WILL BE MADE AT CONTRACT PRICE BID FOR:

ITEM	UNIT	DESCRIPTION
SPECIAL	SQ. FT.	PATCHING CONCRETE STRUCTURES WITH SUPERIOR BONDING MATERIALS

BAR SIZE IS INDICATED IN THE BAR MARK. THE FIRST DIGIT OF THE BAR MARK INDICATES THE BAR SIZE NUMBER. FOR EXAMPLE, A700 IS A NO. 7 SIZE BAR.

BAR DIMENSIONS SHOWN ARE OUT TO OUT, UNLESS OTHERWISE NOTED.

"STR." INDICATES A STRAIGHT BAR.

THE DOWEL BAR SUBSTITUTION SHALL BE THE DB-SAE SPLICER SYSTEM AS MANUFACTURED BY THE RICHMOND SCREW ANCHOR CO., INC.; 7214 BURNS STREET; RICHLAND HILLS; FORT WORTH, TEXAS 76118; TELEPHONE (817)-284-4981. WEIGHT OF THESE SPLICER SYSTEMS HAS BEEN INCLUDED ITEM 509-DOWEL-BAR SUBSTITUTION FOR PAYMENT.

REFER TO CMS SECTIONS 106.03, 700, 709.01 THROUGH 709.05, AND 709.08. SUFFICIENT ADDITIONAL REINFORCING STEEL SHALL BE PROVIDED FOR SAMPLING. RANDOM SAMPLES SHALL BE REPLACED IN THE STRUCTURES BY THE ADDITIONAL STEEL, SPLICED IN ACCORDANCE WITH 509.08.

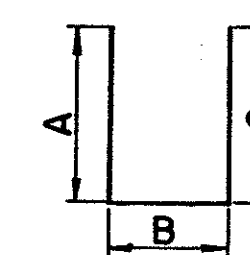

TYPE 1

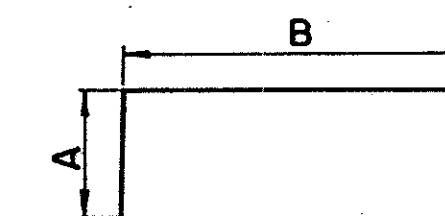

TYPE 2

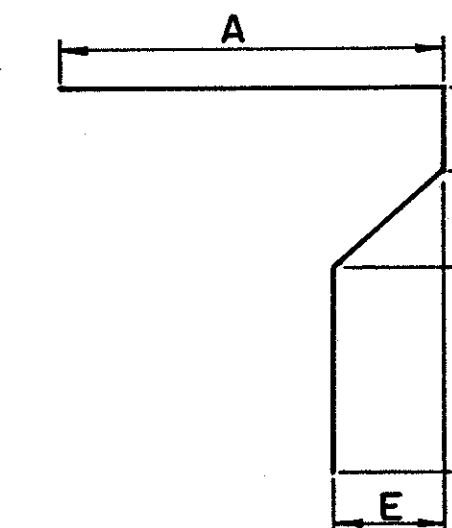

TYPE 3

STATE OF OHIO						4 / 10
DEPARTMENT OF TRANSPORTATION						
DISTRICT 12 BRIDGE DEPARTMENT						
STRUCTURE REPAIR NOTES						
AND						
REINFORCING STEEL LIST						
BRIDGE LAK-20-2976						
OVER ARCOLA CREEK						
DESIGNED	DRAWN	TRACED	CHECKED	REVIEWED	DATE	REVISED
EJA	PJM	PJM	DWL	GWM	7-2-84	