

I.C.H. No. 2 SEC. Q
LAKE COUNTY

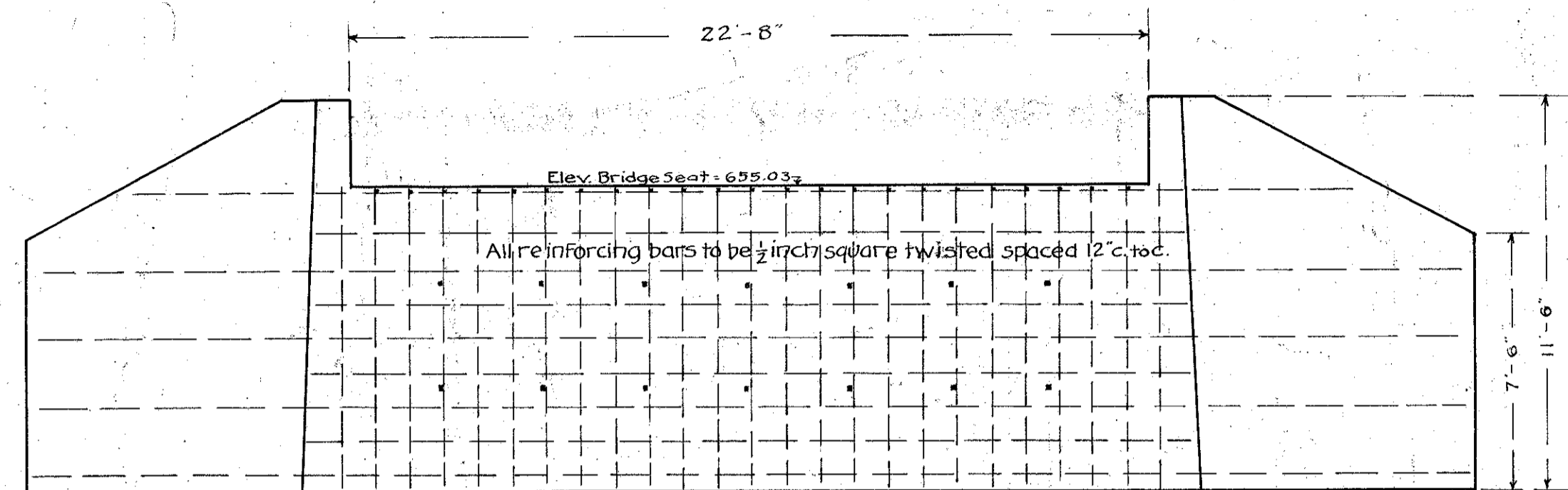

Elevation of West Abutment.
Scale $\frac{1}{4}$ " = 1ft.

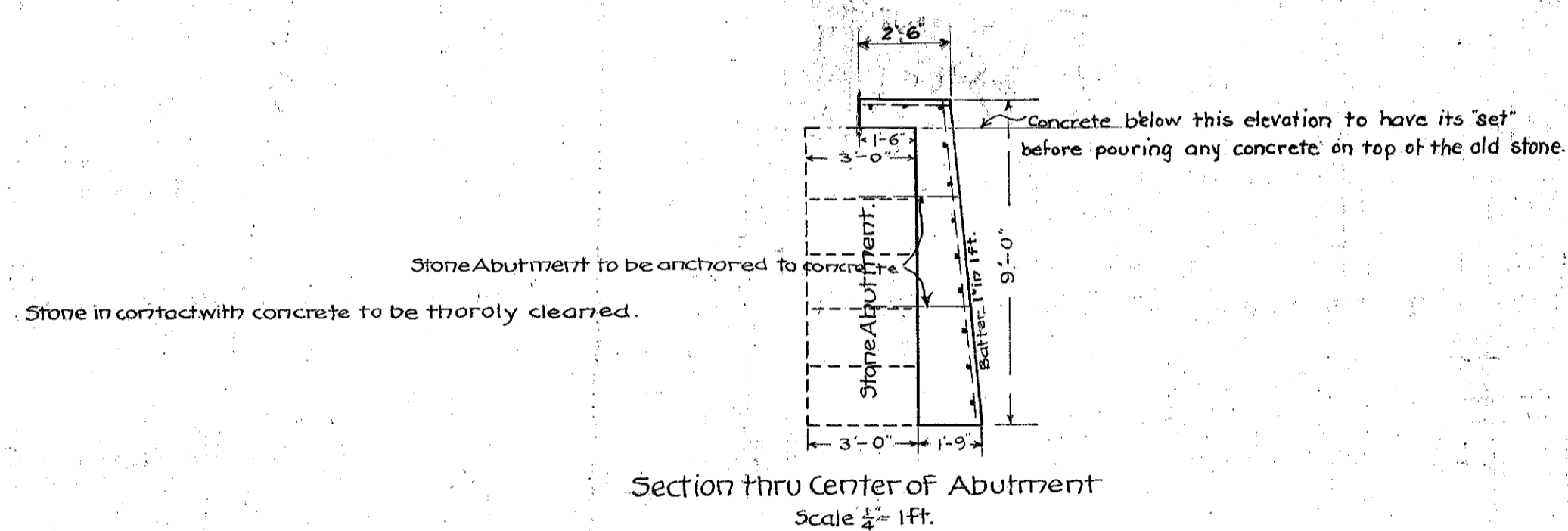

Section thru Center of Abutment
Scale $\frac{1}{4}$ " = 1ft.

Quantities:-

Excavation	60.0 Cu.Yds
Concrete	.0
Steel reinforcing bars	12.00 lbs

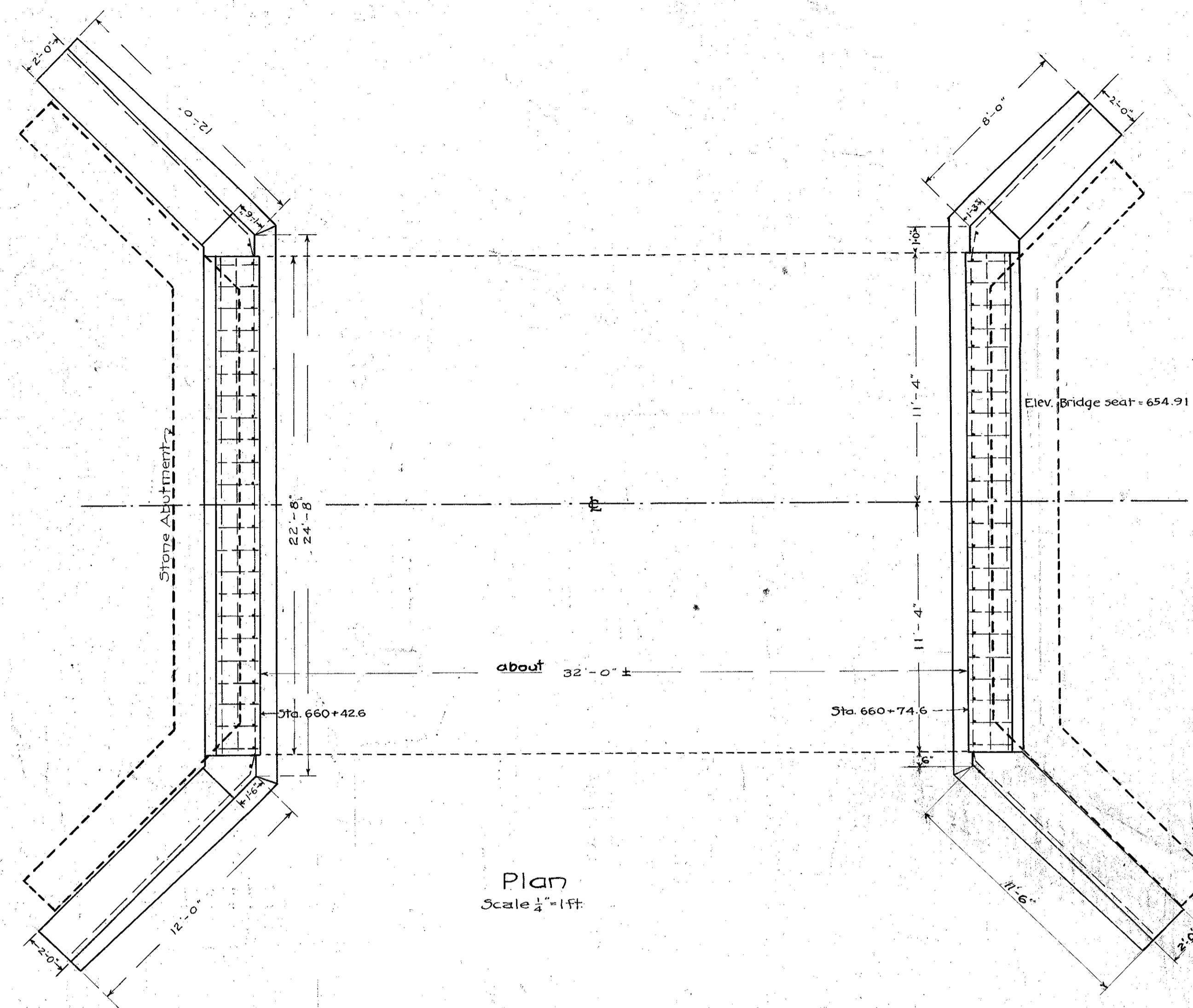

Plan
Scale $\frac{1}{4}$ " = 1ft.

For Superstructure, use Standard Concrete Beam Bridge 32' x 20'.
See separate sheet.