

LAKE COUNTY
S.H. 2 SEC. Q (PT.)

INTERSECTION DETAILS
GREEN RD. NORTH
STA. 494+74.32

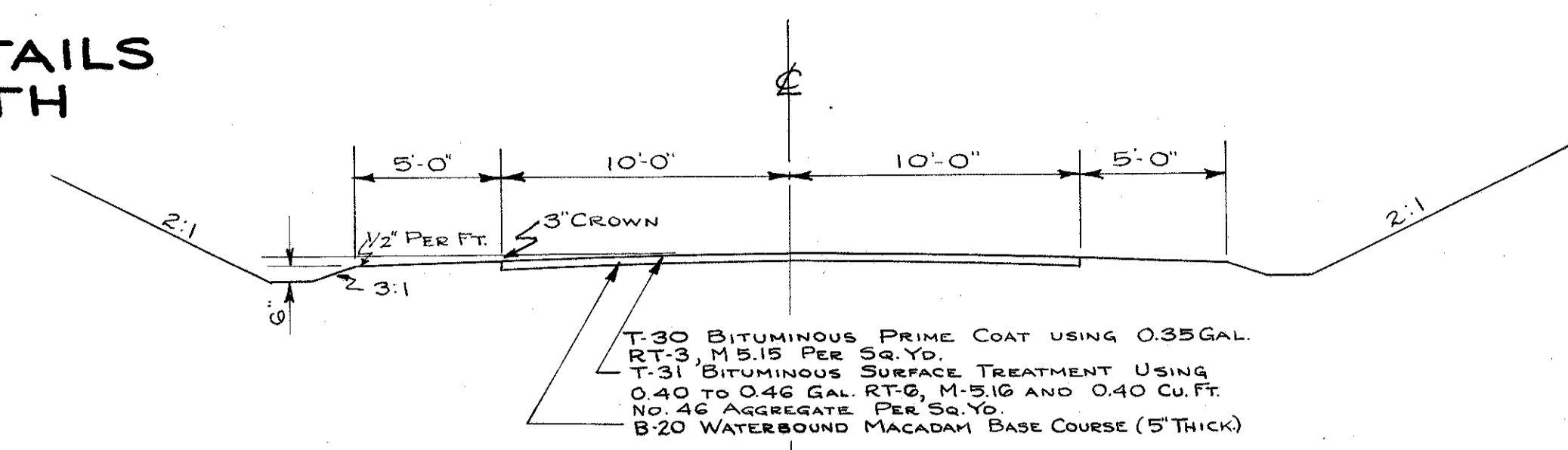

TYPICAL SECTION
GREEN RD. NORTH

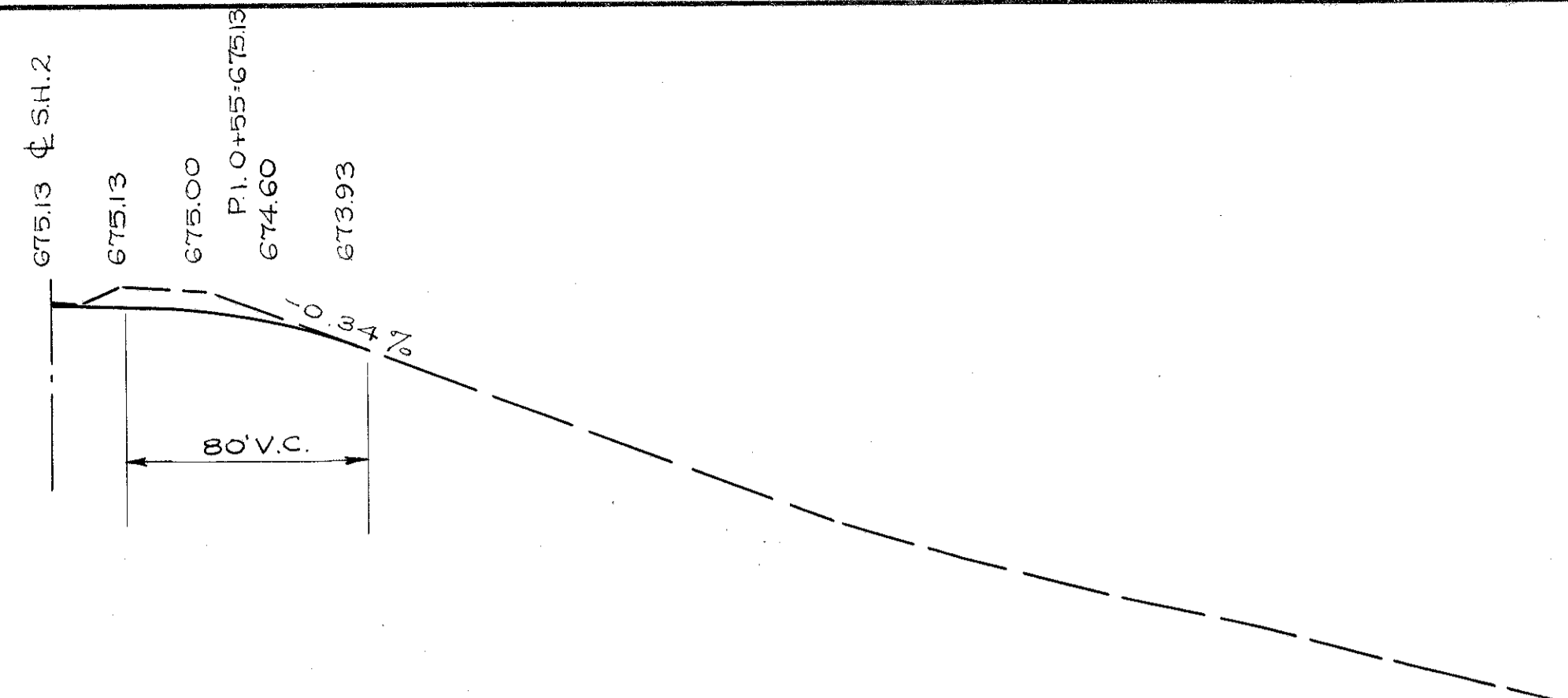
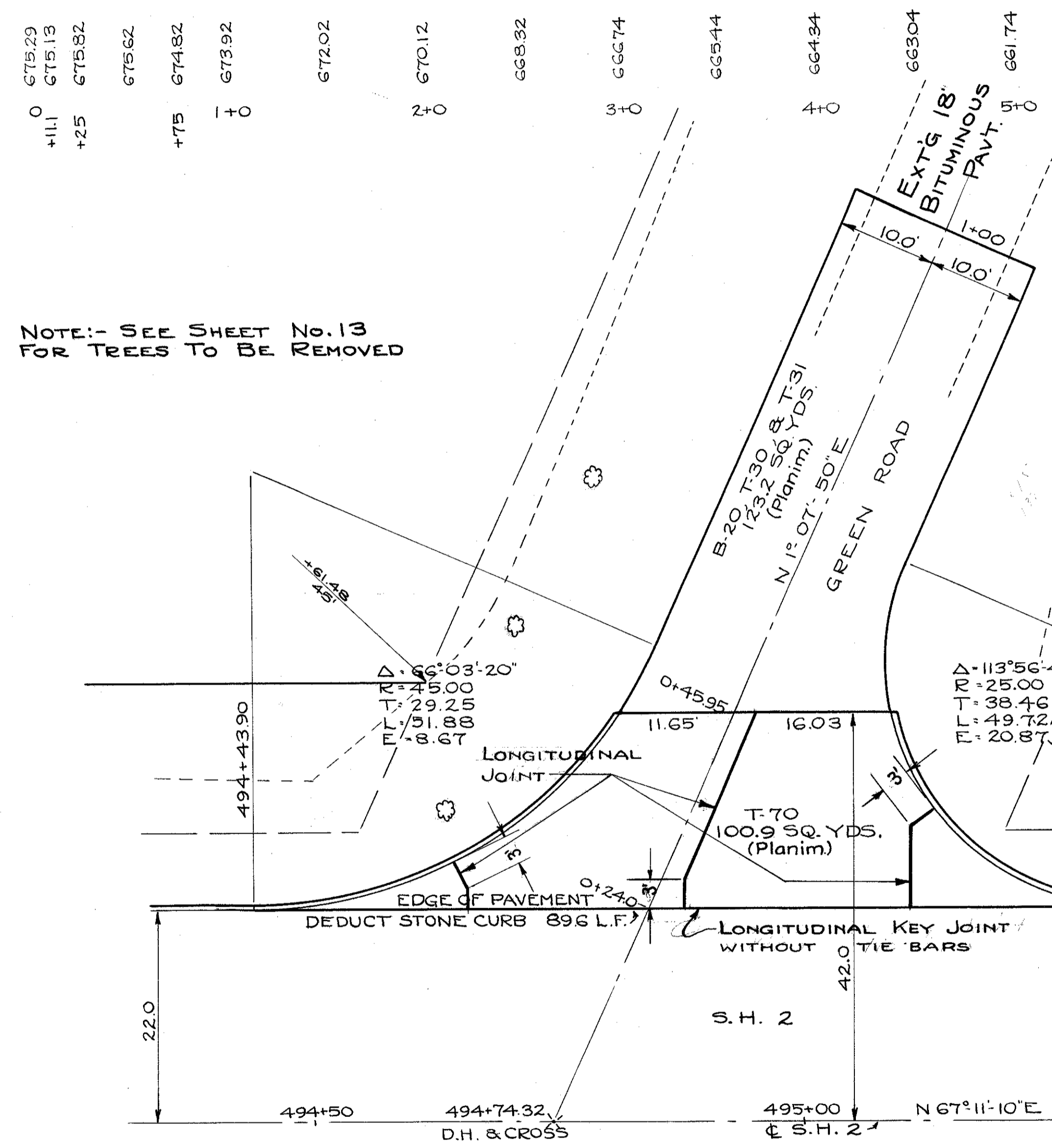

NOTE: - SEE SHEET No. 13
FOR TREES TO BE REMOVED

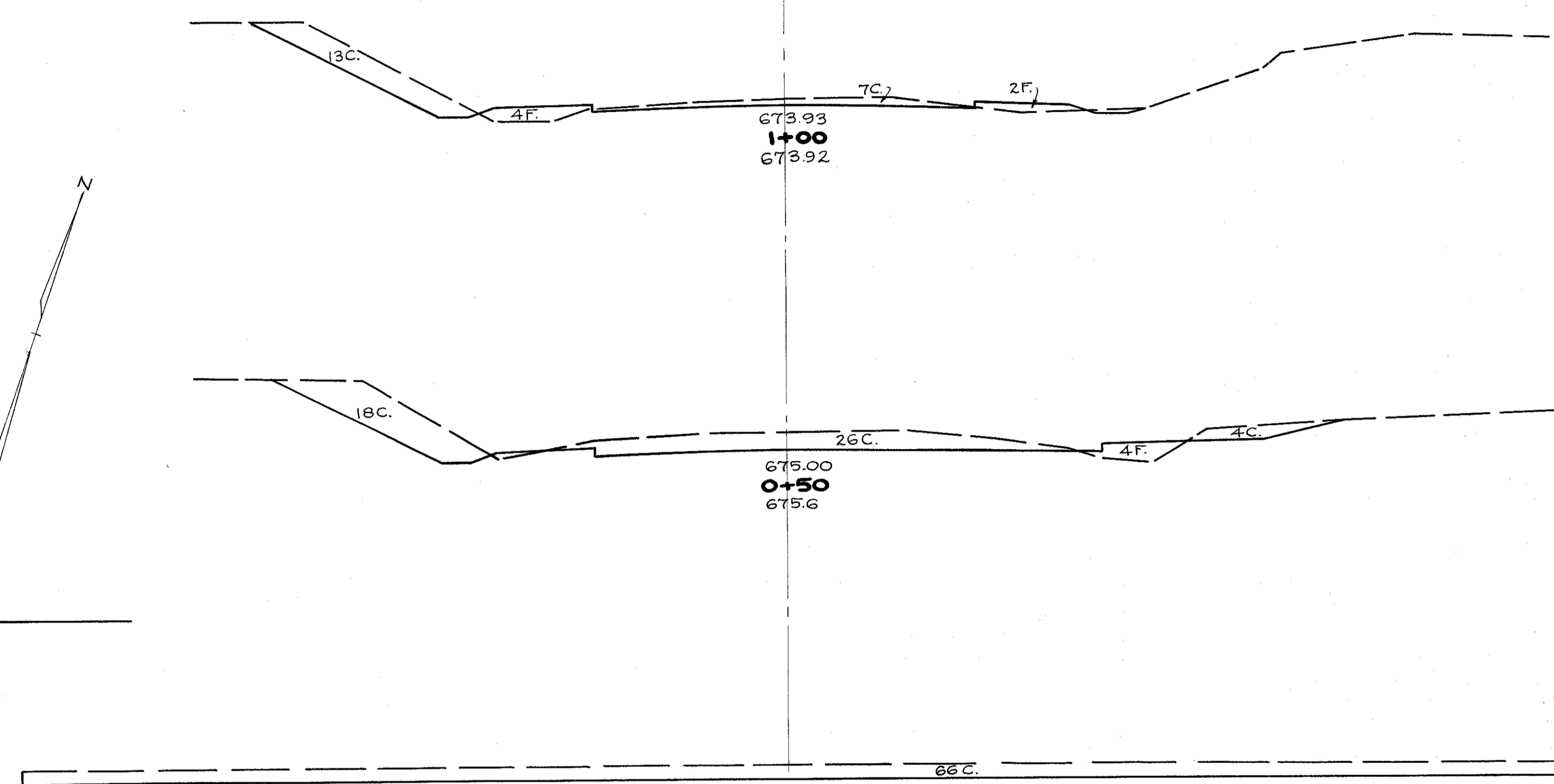

END AREA		CU. YDS.	
CUT	FILL	EXC.	EMB.
20	6		
		63	10
48	4		
		55	2
66	0		
TOTAL	118	118	12

ESTIMATED QUANTITIES

T-70 6" PORTLAND CEMENT CONCRETE PAVEMENT	100.9 SQ. YDS.
B-20 5" WATERBOUND BASE COURSE	123.2 SQ. YDS.
T-30 BITUMINOUS PRIME COAT	123.2 SQ. YDS.
T-31 BITUMINOUS SURFACE TREATMENT	123.2 SQ. YDS.
I-II DEDUCT SANDSTONE CURB	89.6 LIN. FT.
I-II SANDSTONE CURB	78.1 LIN. FT.