

**INTERSECTION DETAILS**  
**McMACKIN ROAD SOUTH**  
**STA. 433+79.89**

FED. RD. DIST. NO.	STATE	FED. AID PROJECT	FISCAL YEAR
10	OHIO	5-A(4)	1940

49  
64

**LAKE COUNTY**  
**S.H. 2 SEC. Q (PT.)**

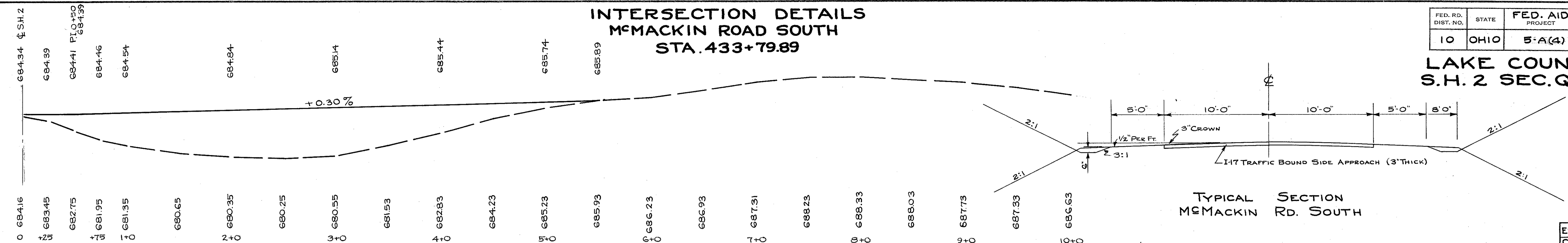

TYPICAL SECTION  
 McMACKIN RD. SOUTH

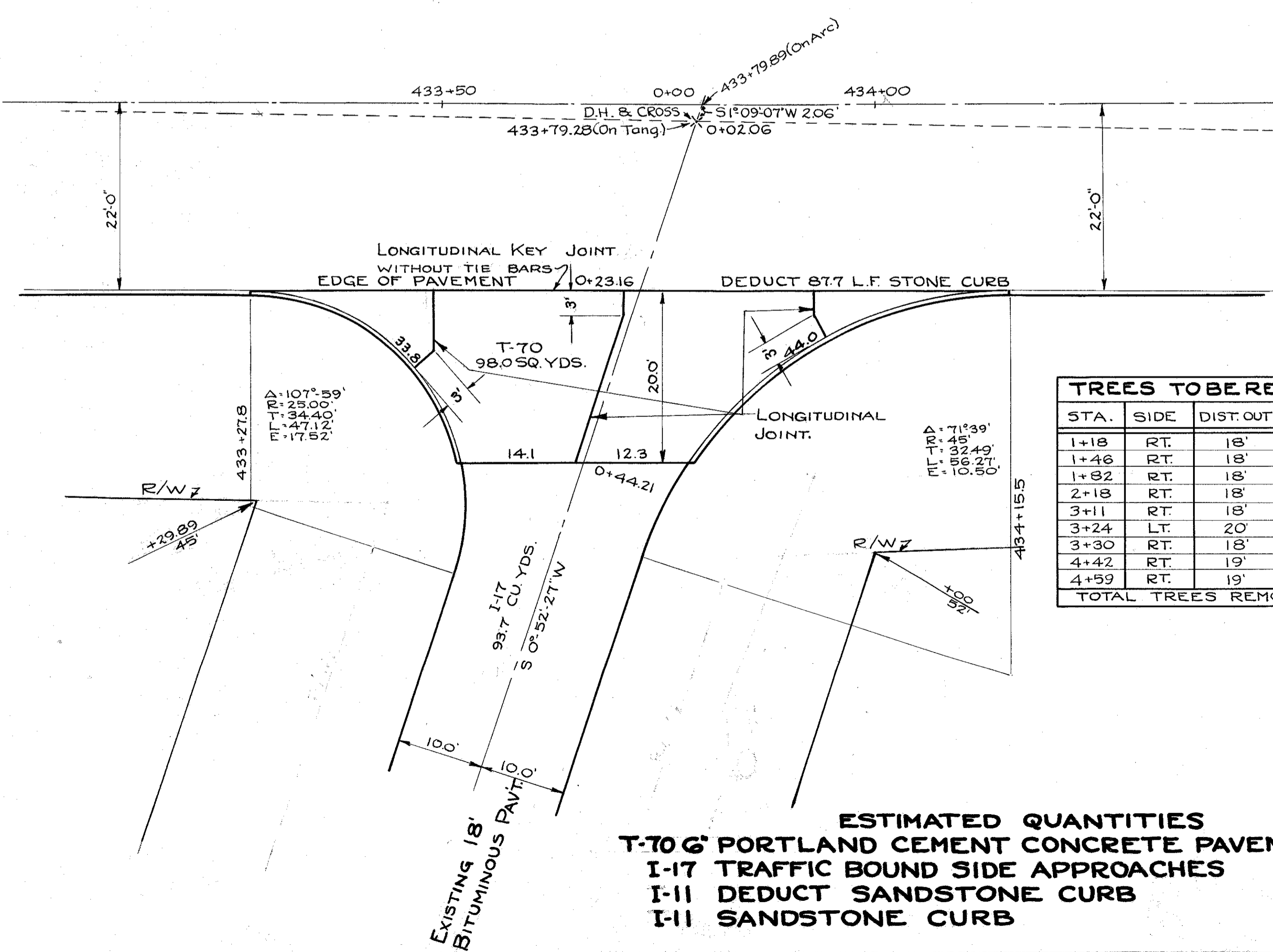
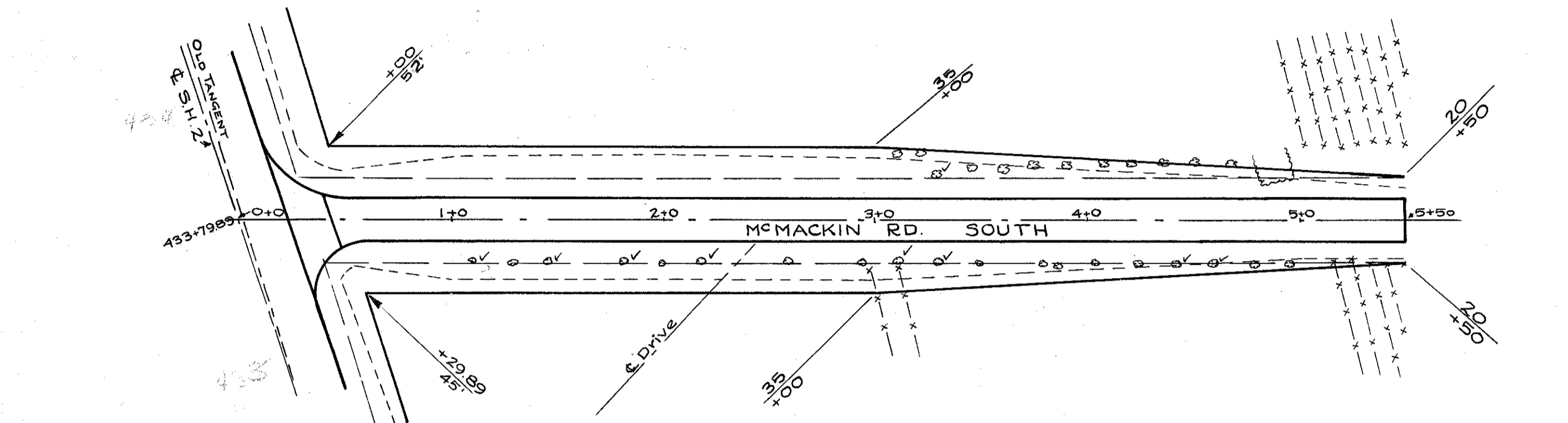

STA.	SIDE	DIST. OUT	SIZE	KIND
1+18	RT.	18'	10"	Cherry
1+46	RT.	18'	12"	Cherry
1+82	RT.	18'	17"	Cherry
2+18	RT.	18'	14"	Cherry
3+11	RT.	18'	10"	Cherry
3+24	LT.	20'	12"	Pear
3+30	RT.	18'	17"	Cherry
4+42	RT.	19'	12"	Cherry
4+59	RT.	19'	10"	Cherry
TOTAL TREES REMOVED - 9				

**ESTIMATED QUANTITIES**  
 T-70 PORTLAND CEMENT CONCRETE PAVEMENT 98.0 SQ. YDS.  
 I-17 TRAFFIC BOUND SIDE APPROACHES 93.7 CU. YDS.  
 I-11 DEDUCT SANDSTONE CURB 87.7 LIN. FT.  
 I-11 SANDSTONE CURB 77.8 LIN. FT.

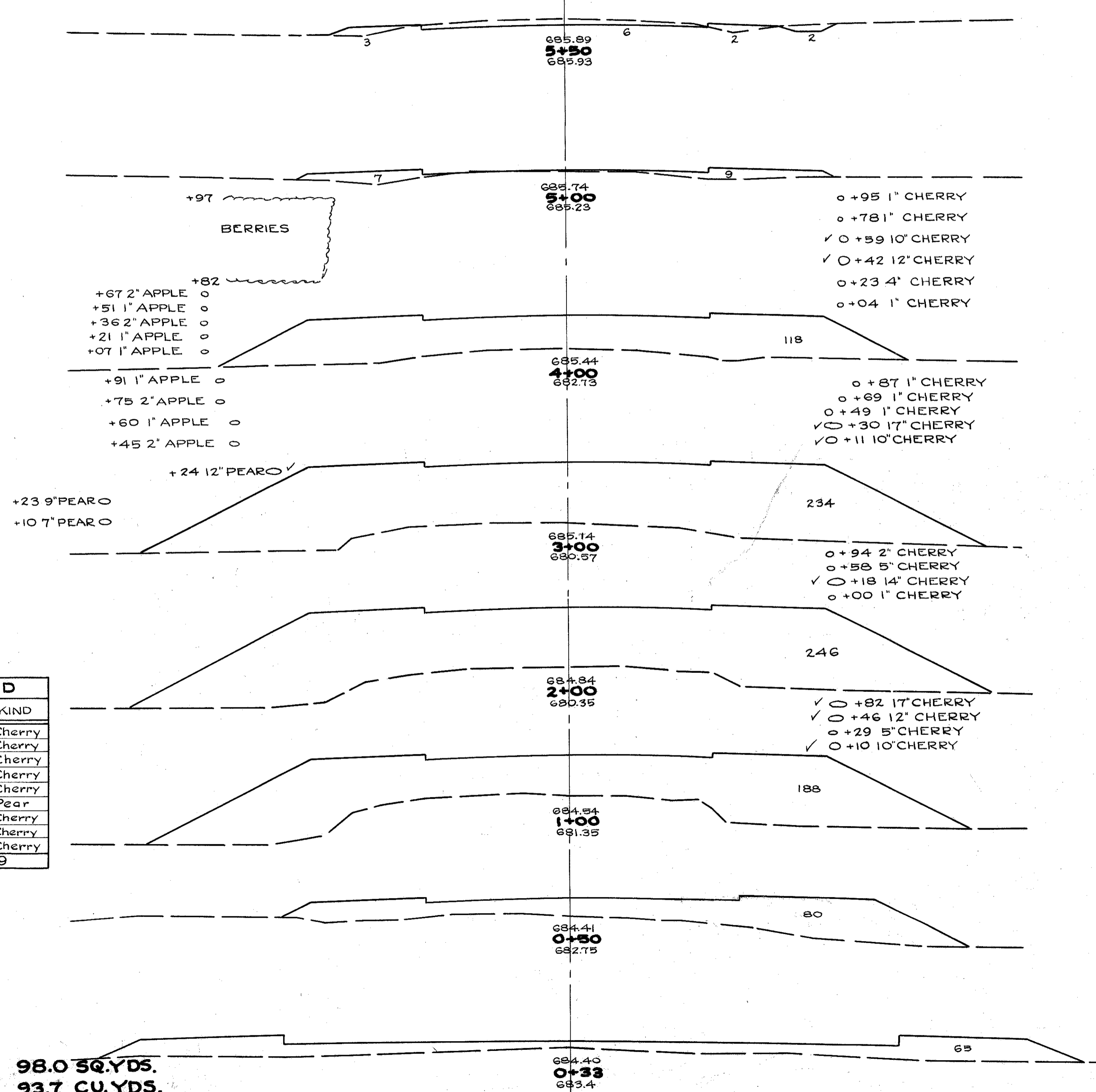

END AREA	CU. YDS.	
	CUT	FILL
8	5	
0	10	8 20
0	118	0 248
0	234	0 652
0	246	0 889
0	188	0 804
0	60	0 248
0	65	0 46
<b>TOTAL</b>	<b>8</b>	<b>2907</b>