

END OF PROJECT
F.A.P. 4 (3)
STA. 279+53.50

279+53.50 = 281+62.52 Original F.A.P. 4

1-Y Build Conc. steps at 278+36 on L.
See Detail on Sheet 29

STRUCTURES 20' SPAN & UNDER (C)							
Item No.	Station	Type	Size	Excav. Cu. Yds.	Pipe for Culv. Lin. Ft.	Std. No. 11-A Catch Basin Each	Std. No. 12-A Catch Basin Each
1-C	275+00	Pipe	12" x 37"	16.0	37	1 R	1 L
2-C	277+25	"	12" x 37"	16.0	37	1 R	1 L
3-C	279+50	"	12" x 37"	16.0	37	1 R	1 L
TOTALS				48.0	111	3	3

Work Required: Build Std. 12" x 37" Pipe Culv. See Detail on Sheet # 29

MANHOLE (M) Included in Rdwy Quant.		
Item No.	Station	Right or Left
1-M	279+96	L
TOTAL = 1		

TREES & STUMPS REM. & DISPOSED OF (C)				
Item No.	Station	Side	Size & Kind	Place
1	271+14	R	12" loc.	
2	271+19	R	12" loc.	
3	271+60	R	12" loc.	
4	271+71	R	10" loc.	
5	274+71	R	12" W. Cherry	

SEWERS (S)			
Item No.	Station	Right or Left	Pipe for St. Sew'r. Lin. Ft.
1-S	275+00	L	481
TOTAL 481			

PRIVATE DRIVES					
Item No.	Station	Side	Cu. Yds.	Place	
1-D	272+30	L	3.1	1.86	
2-D	273+88	L	5.3	1.86	
3-D	275+30	R	8.9	0.33	
4-D	275+88	R	0.8	0.33	
5-D	277+00	R	1.6	0.33	
TOTALS				11.3	0.0

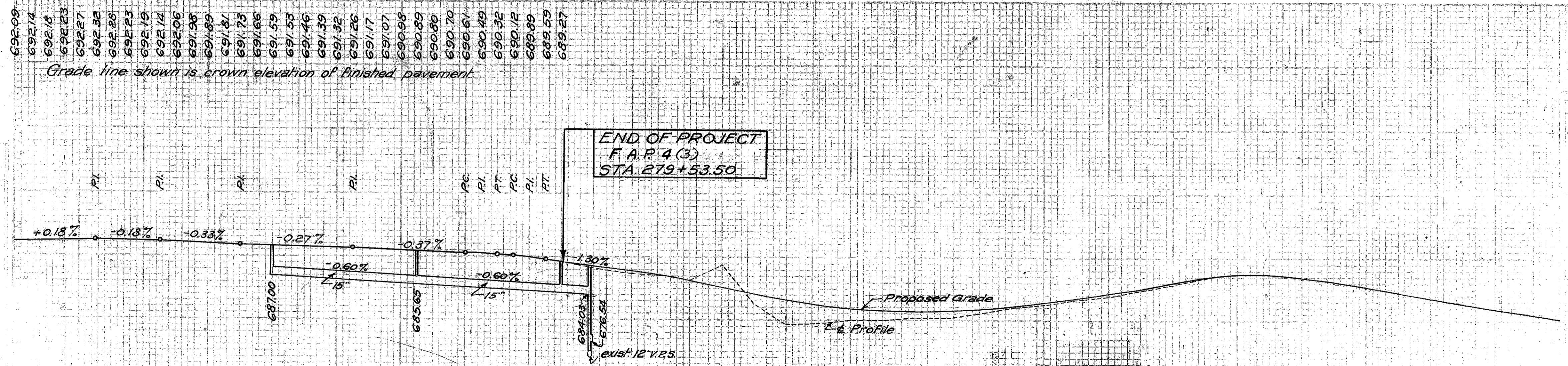

STATION	SURFACE ELEVATION	ELEVATIONS
272	691.98	691.98
273	692.00	692.00
274	692.02	692.02
275	692.07	692.07
276	692.12	692.12
277	692.03	692.03
278	692.08	692.08
279	692.03	692.03
280	691.98	691.98
281	691.88	691.88
282	691.70	691.70
283	691.62	691.62
284	691.53	691.53
285	691.52	691.52
286	691.41	691.41
287	691.34	691.34
288	691.29	691.29
289	691.20	691.20
290	691.15	691.15
291	691.06	691.06
292	690.98	690.98
293	690.86	690.86
294	690.76	690.76
295	690.68	690.68
296	690.62	690.62
297	690.54	690.54
298	690.44	690.44
299	690.32	690.32
300	690.13	690.13
301	689.95	689.95
302	689.73	689.73
303	689.58	689.58
304	689.42	689.42
305	689.23	689.23
306	689.09	689.09
307	688.92	688.92
308	688.73	688.73
309	688.59	688.59
310	688.57	688.57
311	688.40	688.40
312	688.3	688.3
313	688.9	688.9
314	688.6	688.6
315	679.3	679.3
316	679.6	679.6
317	680.0	680.0
318	680.0	680.0
319	680.3	680.3
320	680.2	680.2
321	681.0	681.0
322	681.66	681.66
323	681.37	681.37
324	681.3	681.3
325	681.22	681.22
326	681.81	681.81
327	681.76	681.76
328	686.78	686.78
329	687.25	687.25
330	687.25	687.25
331	686.80	686.80
332	686.04	686.04
333	685.23	685.23
334	684.40	684.40
335	683.59	683.59
336	682.80	682.80
337	681.89	681.89
338	681.11	681.11
339	680.26	680.26

Exc. = 78.4 Cu. Yds.
Emb. = 137.3 Cu. Yds.
Emb. + 20% = 164.8 Cu. Yds.