

LAKE COUNTY  
LAK - 20 - 19.39

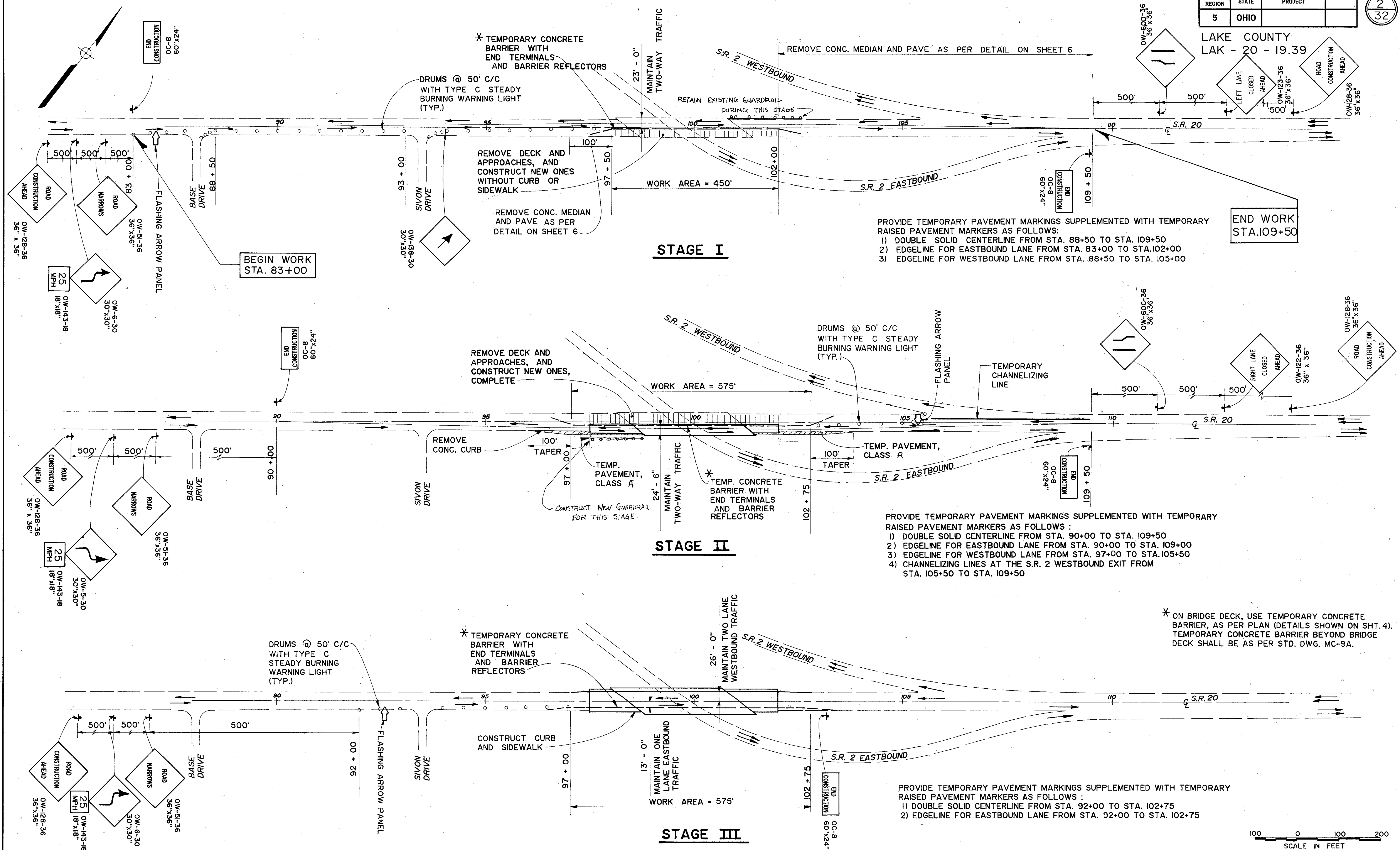

**STAGE I**

PROVIDE TEMPORARY PAVEMENT MARKINGS SUPPLEMENTED WITH TEMPORARY RAISED PAVEMENT MARKERS AS FOLLOWS:  
 1) DOUBLE SOLID CENTERLINE FROM STA. 88+50 TO STA. 109+50  
 2) EDGELINE FOR EASTBOUND LANE FROM STA. 83+00 TO STA. 102+00  
 3) EDGELINE FOR WESTBOUND LANE FROM STA. 88+50 TO STA. 105+00

**STAGE II**

PROVIDE TEMPORARY PAVEMENT MARKINGS SUPPLEMENTED WITH TEMPORARY RAISED PAVEMENT MARKERS AS FOLLOWS:  
 1) DOUBLE SOLID CENTERLINE FROM STA. 90+00 TO STA. 109+50  
 2) EDGELINE FOR EASTBOUND LANE FROM STA. 90+00 TO STA. 109+00  
 3) EDGELINE FOR WESTBOUND LANE FROM STA. 97+00 TO STA. 105+50  
 4) CHANNELIZING LINES AT THE S.R. 2 WESTBOUND EXIT FROM STA. 105+50 TO STA. 109+50

**STAGE III**

PROVIDE TEMPORARY PAVEMENT MARKINGS SUPPLEMENTED WITH TEMPORARY RAISED PAVEMENT MARKERS AS FOLLOWS:  
 1) DOUBLE SOLID CENTERLINE FROM STA. 92+00 TO STA. 102+75  
 2) EDGELINE FOR EASTBOUND LANE FROM STA. 92+00 TO STA. 102+75

\* ON BRIDGE DECK, USE TEMPORARY CONCRETE BARRIER, AS PER PLAN (DETAILS SHOWN ON SHT. 4). TEMPORARY CONCRETE BARRIER BEYOND BRIDGE DECK SHALL BE AS PER STD. DWG. MC-9A.



STAGE CONSTRUCTION PLAN