

**PART OF LOT 91  
NORTH PERRY VILLAGE & PERRY TOWNSHIP  
PART OF LOT 6, TRACT 4  
MADISON TOWNSHIP  
LAKE COUNTY, OHIO**

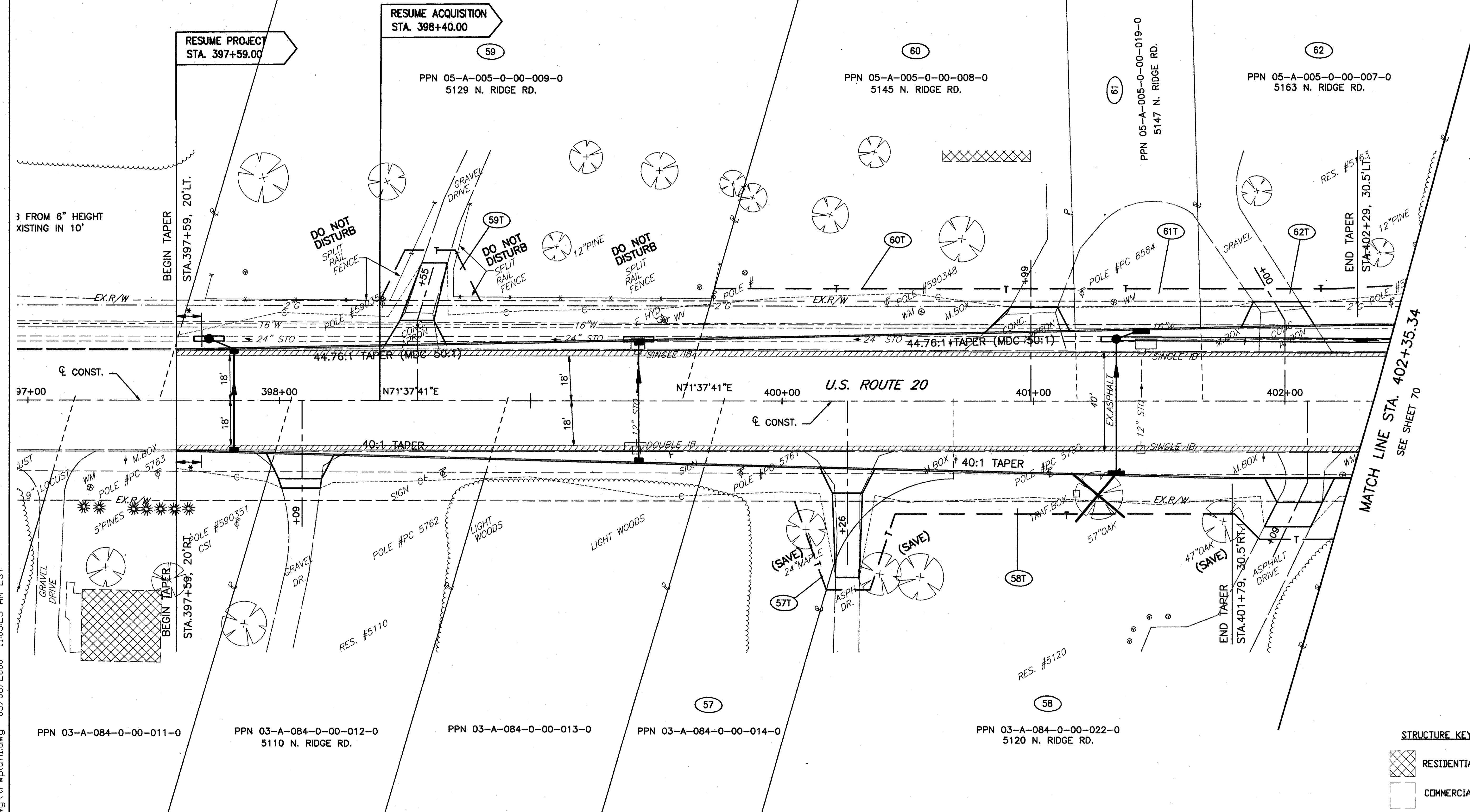
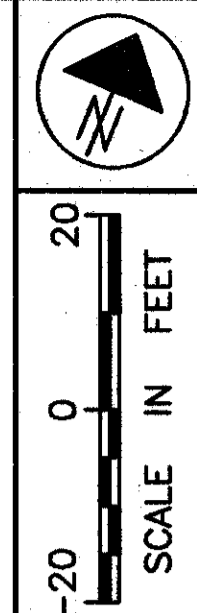

**STRUCTURE KEY**

	RESIDENTIAL
	COMMERCIAL

REV	DATE	DESCRIPTION

PLAN COMPLETED:

RIGHT OF WAY PLAN U. S. 20  
STA. 397+59.00 TO STA. 402+35.34

LAK - 20 - 18.72

FEDERAL PROJECT NO. 20343

68/87

422  
441

H:\1998\98404\dwg\trwplan1.dwg 03/08/2000 11:05:23 AM EST