

PID NO. 19686

R/W DESIGNER R/W REVIEWER

CENTERLINE PLAT

LAK-20-18.72

4/5

4/87

358/441

CENTERLINE SURVEY PLAT

LAK - 20 - 18.72

NORTH PERRY VILLAGE, PERRY TOWNSHIP & MADISON TOWNSHIP LAKE COUNTY

T=11N, R=7W & 8W

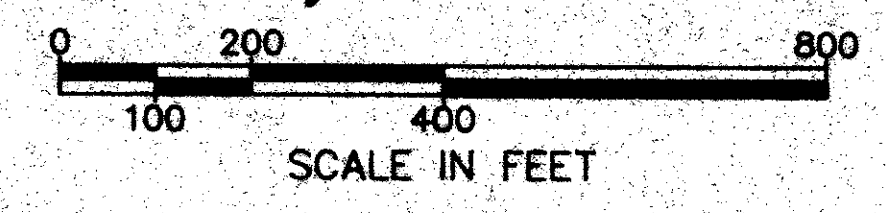

MONUMENTS TO BE (◆) SET DURING CONSTRUCTION				
STATION	DISTANCE FROM C. SUR.		ADJUSTABLE C. MONUMENT	C. REFERENCE MONUMENT
	LEFT	RIGHT		
405+25.66	C. TOWNLINE RD	0	1	
TOTALS			1	

MONUMENT LEGEND

- ◆ PROP. MON. ASSEMBLY
- ◇ EX. I.P. MON. FND.

NOTE: THE EXISTING RIGHT OF WAY WIDTH AND LOCATION WERE DETERMINED USING O.D.O.T. PLANS I.C.H. NO. 2 SEC. J (1918), S.H. 2 SEC. J (PT.) (1938) AND S.H. 2 SEC. Q (PT.) (1940).

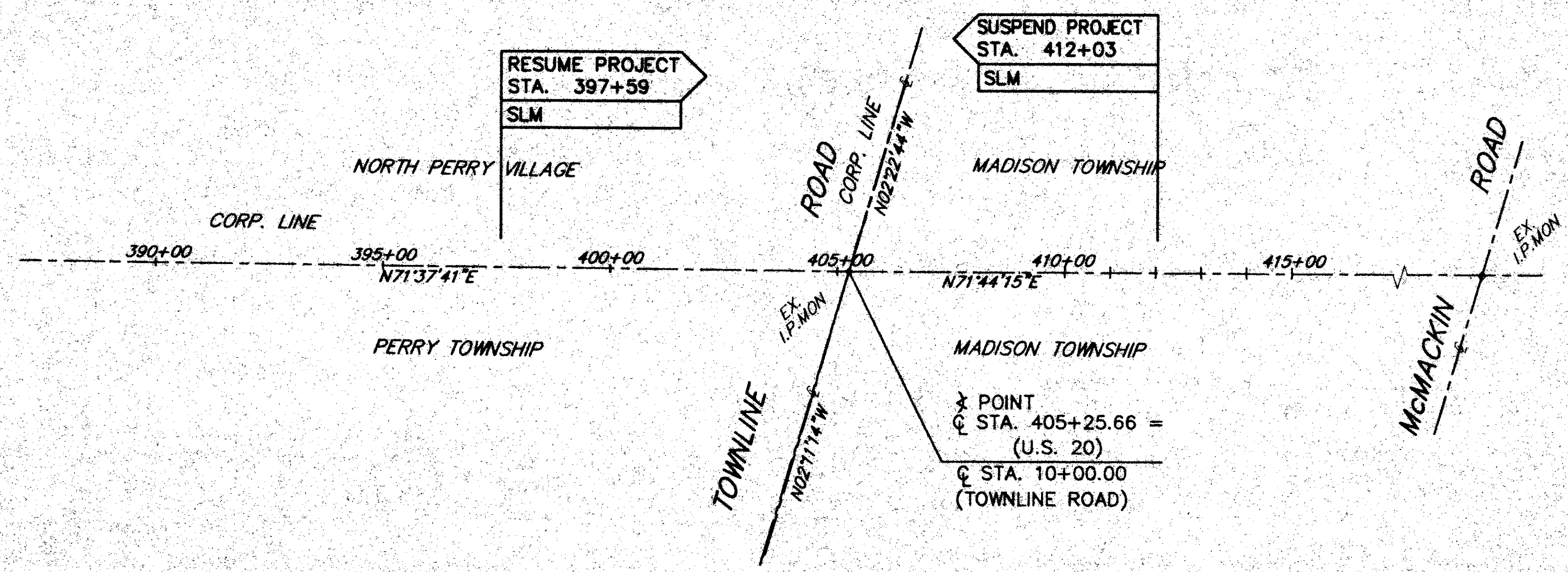

I:\PROJECTS\PID20343\09p\plgt\plmt.dgn 07-JAN-2003 3:50PM dlasfovk