

DATE: 10-03-02 - COPYRIGHT: CT CONSULTANTS, INC. H:\1998\98404\DWG\404GRT02.DWG (PLOT 1)

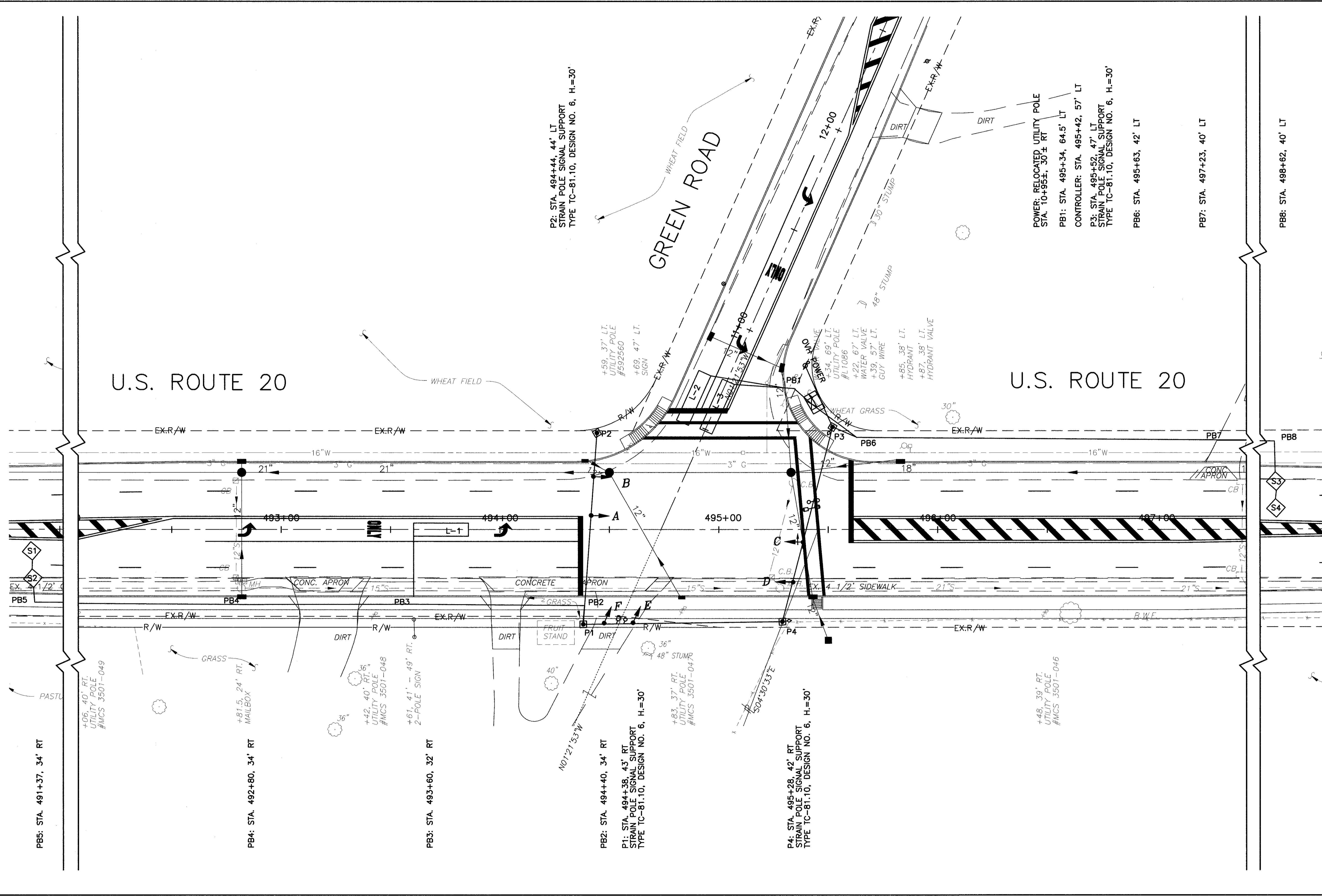

PB5: STA. 491+37, 34' RT

PB4: STA. 492+80, 34' RT

PB3: STA. 493+60, 32' RT

PB2: STA. 494+40, 34' RT

P1: STA. 494+36, 43' RT
STRAIN POLE SIGNAL SUPPORT
TYPE TC-81.10, DESIGN NO. 6, H.=30'

P4: STA. 495+28, 42' RT
STRAIN POLE SIGNAL SUPPORT
TYPE TC-81.10, DESIGN NO. 6, H.=30'

P2: STA. 494+44, 44' LT
STRAIN POLE SIGNAL SUPPORT
TYPE TC-81.10, DESIGN NO. 6, H.=30'

POWER, RELOCATED UTILITY POLE
STA. 10+95±, 30' ± RT
PB1: STA. 495+34, 64.5' LT
CONTROLLER: STA. 495+42, 57' LT

P3: STA. 495+52, 47' LT
STRAIN POLE SIGNAL SUPPORT
TYPE TC-81.10, DESIGN NO. 6, H.=30'

PB6: STA. 495+63, 42' LT

PB7: STA. 497+23, 40' LT

PB8: STA. 498+62, 40' LT

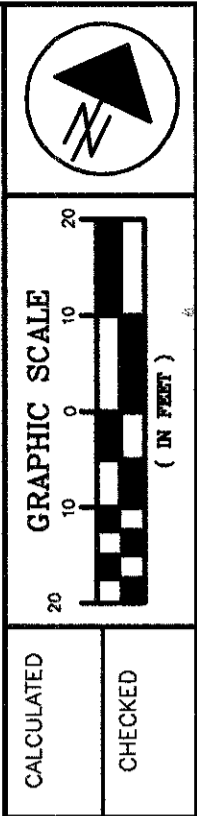

TRAFFIC SIGNAL PLAN
GREEN ROAD / U.S. 20

LAK - 20 - 18.72

335
441