

SIGNAL DIRECTION	SIGNAL HEAD	φ1 & φ5		φ1 & φ6		φ2 & φ5		φ2 & φ6		φ3 & φ7		φ3 & φ8		φ4 & φ7		φ4 & φ8		FLASH	
		R/W	CLEAR	R/W	CLEAR	R/W	CLEAR	R/W	CLEAR	R/W	CLEAR	R/W	CLEAR	R/W	CLEAR	R/W	CLEAR		
NORTHBOUND	A	R	R	R	R	R	R	R	R	R	R	R	R	R	R	R	R	R	
	B	R	R	R	R	R	R	R	R	R	R	R	R	R	R	R	R	R	
	I	R	R	R	R	R	R	R	R	R	R	R	R	R	R	R	R	R	
EASTBOUND	C	R	R	R	R	R	R	R	R	R	R	R	R	R	R	R	R	R	
	D	R	R	R	R	R	R	R	R	R	R	R	R	R	R	R	R	R	
SOUTHBOUND	E	R	R	R	R	R	R	R	R	R	R	R	R	R	R	R	R	R	
	F	R	R	R	R	R	R	R	R	R	R	R	R	R	R	R	R	R	
WESTBOUND	G	R	R	R	R	R	R	R	R	R	R	R	R	R	R	R	R	R	
	H	R	R	R	R	R	R	R	R	R	R	R	R	R	R	R	R	R	

(a) R/-G IF φ2 & φ5 IS NEXT (c) G/-Y IF φ2 & φ6 IS NEXT (e) R/-G IF φ3 & φ8 IS NEXT (g) G/-Y IF φ4 & φ8 IS NEXT
 (b) R/-G IF φ1 & φ6 IS NEXT (d) G IF φ2 & φ6 IS NEXT (f) R/-G IF φ4 & φ7 IS NEXT (h) G IF φ4 & φ8 IS NEXT

FUNCTION	φ1	φ2	φ3	φ4	φ5	φ6	φ7	φ8
INITIAL GREEN	10.0	28.0	10.0	15.0	10.0	28.0	10.0	15.0
MINIMUM GREEN	-	-	-	-	-	-	-	-
VEHICLE EXTENSION	3.0	3.0	3.0	3.0	3.0	3.0	3.0	3.0
MAXIMUM GREEN	20.0	35.0	20.0	30.0	20.0	35.0	20.0	30.0
PEDESTRIAN WALK	-	7.0	-	-	-	7.0	-	7.0
PEDESTRIAN CLEARANCE	-	21.0	-	-	-	21.0	-	21.0
VEHICLE YELLOW CLEARANCE	4.5	4.5	4.5	4.5	4.5	4.5	4.5	4.5
VEHICLE ALL RED CLEARANCE	2.0	2.0	2.0	2.0	2.0	2.0	2.0	2.0
RECALL	OFF	MIN	OFF	OFF	OFF	MIN	OFF	OFF
MEMORY	N.L.	N.L.	N.L.	N.L.	N.L.	N.L.	N.L.	N.L.

NOTE: LTT = 2 MUST BE SET AT WAPITI KEYSTROKES A + 3 + A.

SIGNAL TIMING CHART

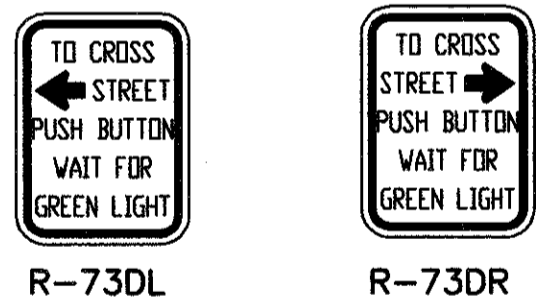

PEDESTRIAN PUSHBUTTON SIGNS

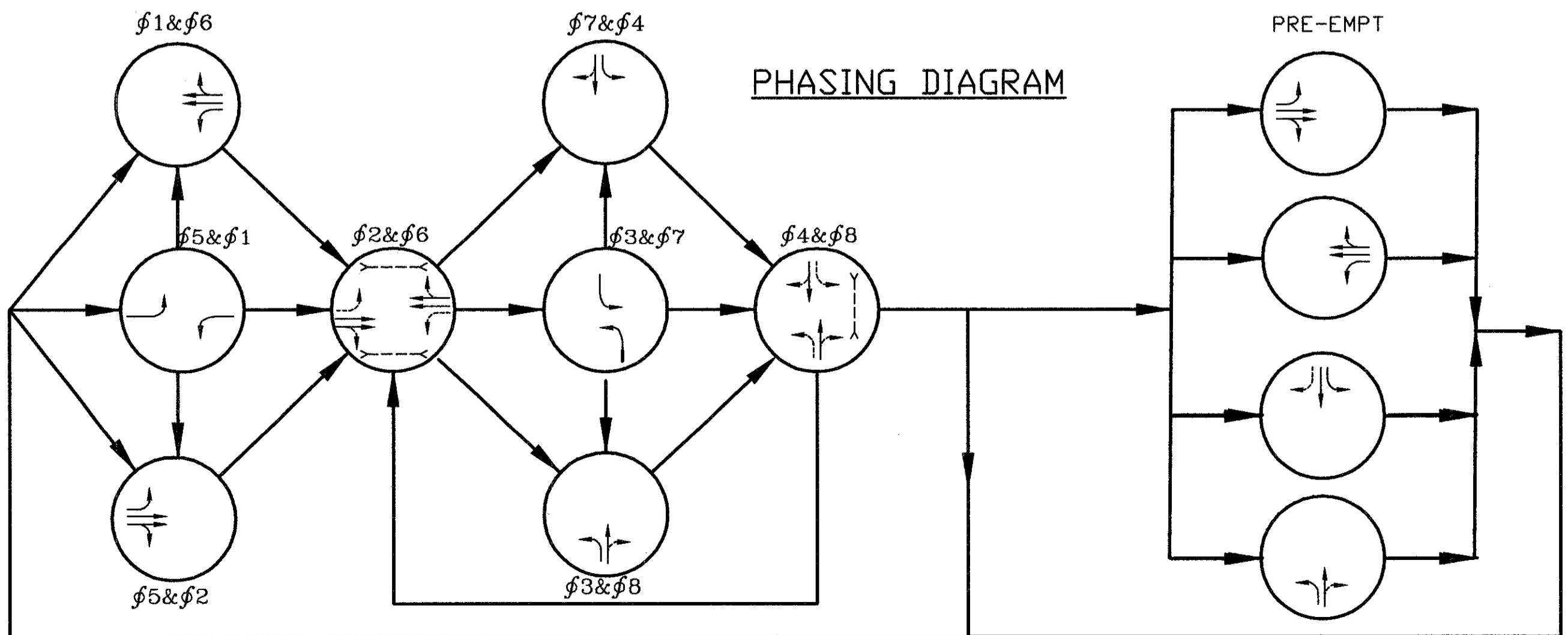

SIGNAL SEQUENCE CHART

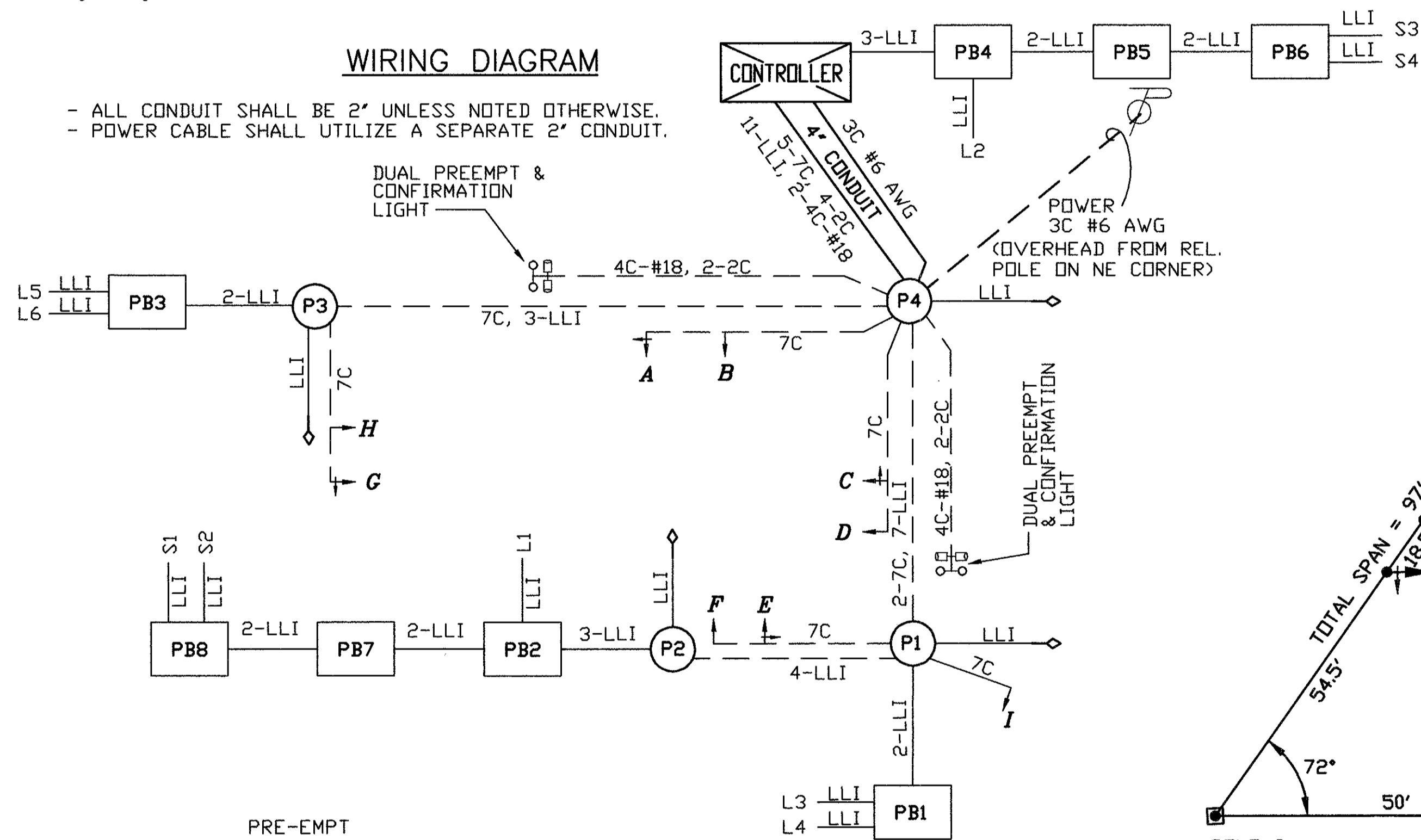

POLE NUMBER	STATION	OFFSET	DESIGN NUMBER	POLE HEIGHT (ft)	ATTACHMENT HEIGHT	INDEX LINE ANGLE (deg)	ANGLES (deg) FROM INDEX LINE					
							POWER SERVICE 1-1/2" BHC, 30"	AUXILIARY SIGNAL HEAD HEIGHT & ANGLE	PEDESTRIAN PUSH BUTTON	CONDUIT ELL SIZE & ANGLE	CABLE ENTRANCE, 2" BHC (12" FROM TOP)	2" CAPPED CONDUIT, ELL (FUTURE USE)
1	173+76.5	51' RT	6	30	24	210	-	11'-284	66	2"-0	90	180
2	172+80	44.5' RT	6	30	24	210	-	-	252	2"-112	180	270
3	173+17	45' LT	6	30	24	90	-	-	180	2"-135	180	315
4	174+20	44.5' LT	6	30	24	180	90	-	270	2"-90	180	270

TYPE TC-81.10 STRAIN POLE SIGNAL SUPPORT

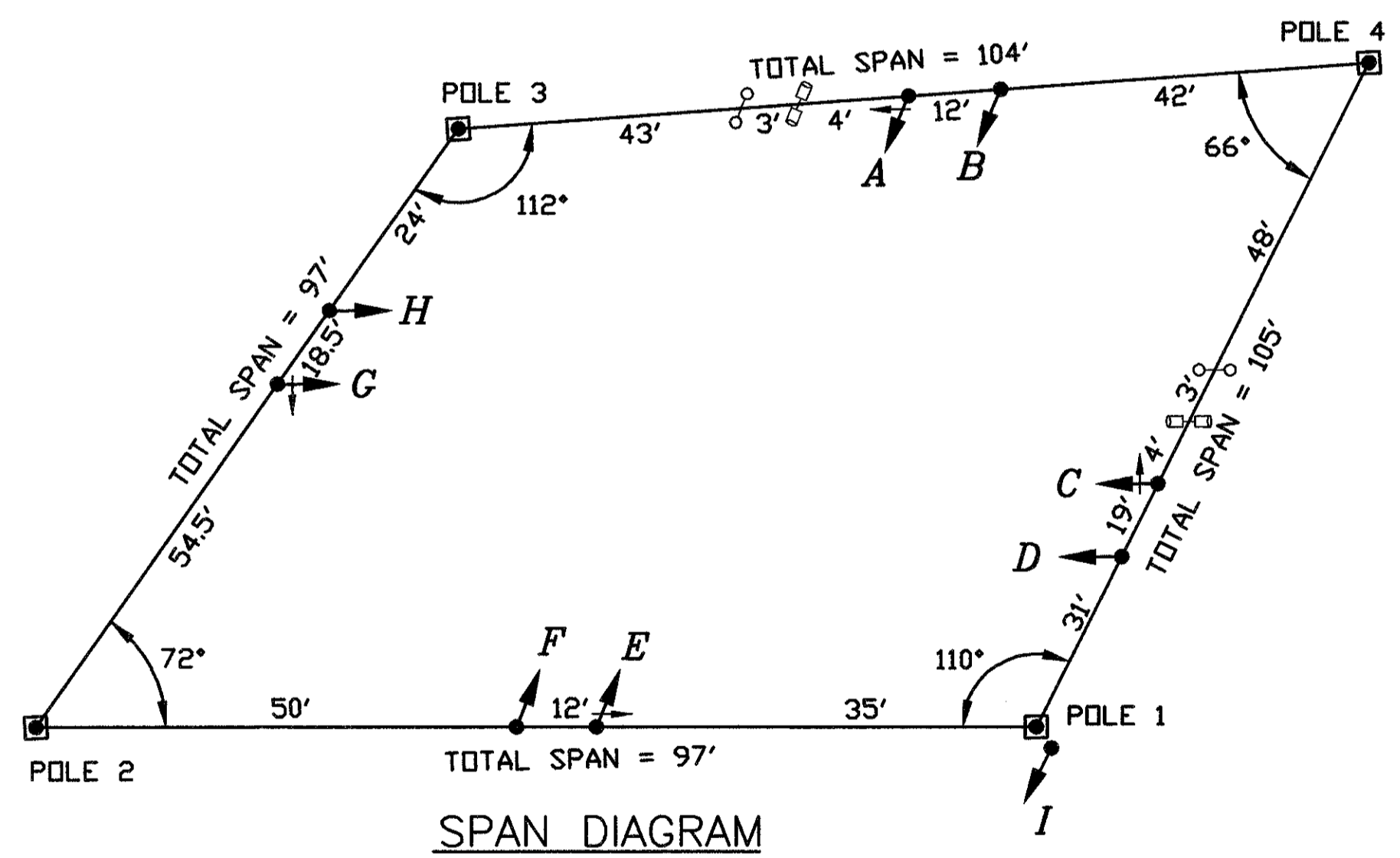
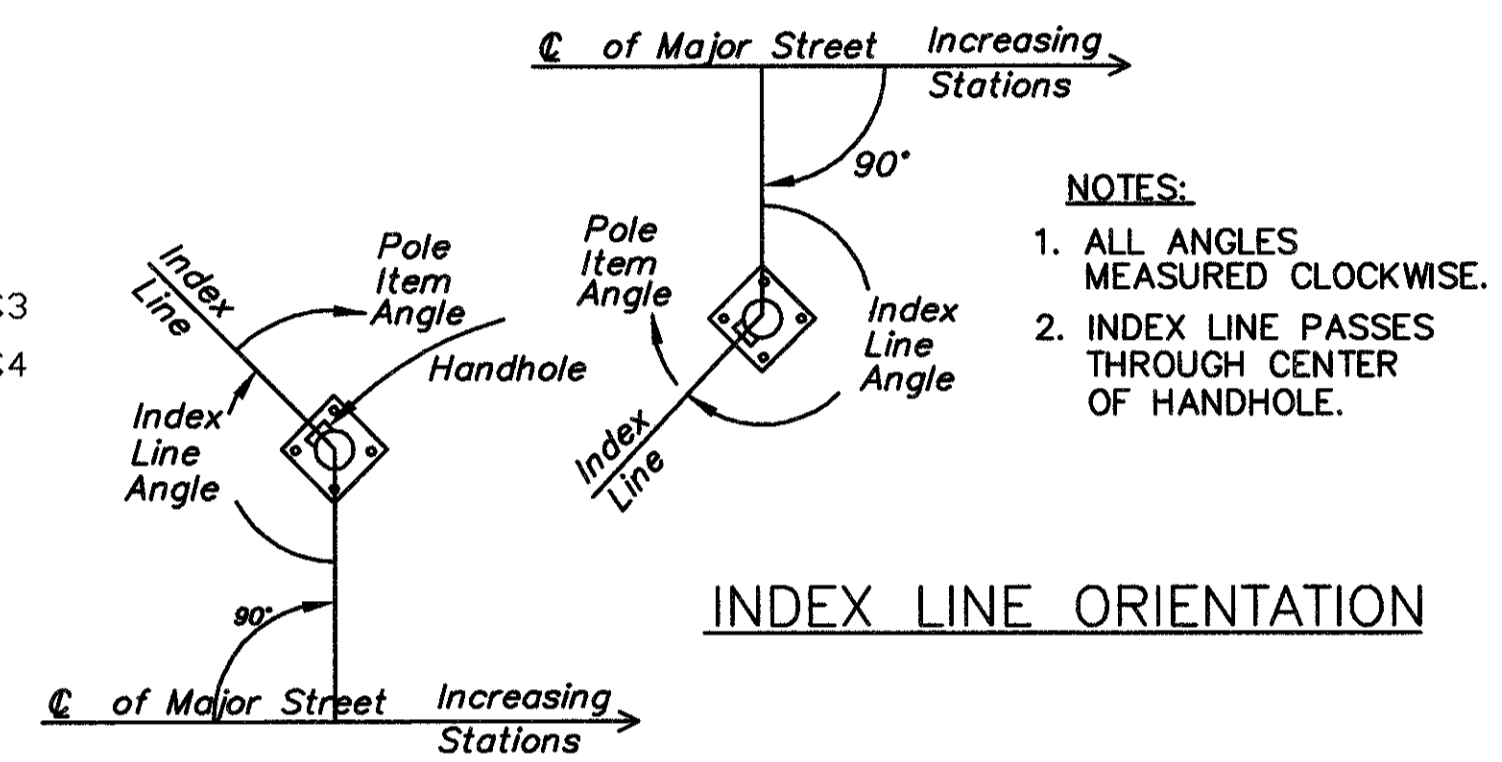

LOOP	SIZE	TURNS	MODE	DELAY	PHASE	REMARK	INHIBITED DELAY	LOCATION 1st FRONT CORNER	LOCATION 2nd FRONT CORNER
L-1	6x25	3	PRESENCE	-	φ5	STANDARD	-	STA. 172+71, 3' LT	STA. 172+71, 3' RT
L-2	6x25	3	PRESENCE	-	φ1	STANDARD	-	STA. 174+45, 3' LT	STA. 174+45, 3' RT
L-3	6x25	3	PRESENCE	2.0	φ3	STANDARD	φ3	STA. 19+41, 3' RT	STA. 19+41, 3' LT
L-4	6x25	3	PRESENCE	8.0	φ8	STANDARD	φ8	STA. 19+47, 9' RT	STA. 19+47, 15' RT
L-5	6x25	3	PRESENCE	8.0	φ4	STANDARD	φ4	STA. 20+52, 17.5' LT	STA. 20+52, 23.5' LT
L-6	6x25	3	PRESENCE	2.0	φ7	STANDARD	φ7	STA. 20+81, 4' LT	STA. 20+81, 10' LT
S-1	6x6	3	PULSE	-	φ2	DIAMOND	-	STA. 169+97, 23.5' RT	-
S-2	6x6	3	PULSE	-	φ2	DIAMOND	-	STA. 169+97, 10.5' RT	-
S-3	6x6	3	PULSE	-	φ6	DIAMOND	-	STA. 177+20, 23.5' LT	-
S-4	6x6	3	PULSE	-	φ6	DIAMOND	-	STA. 177+20, 11.5' LT	-

LOOP DETECTOR CHART

DATE: 09-26-02 - H: 1998\98404\DWG\98404T07.DWG