

DATE: 10-04-02 - H: 19981984041.DWG\98404T02.DWG

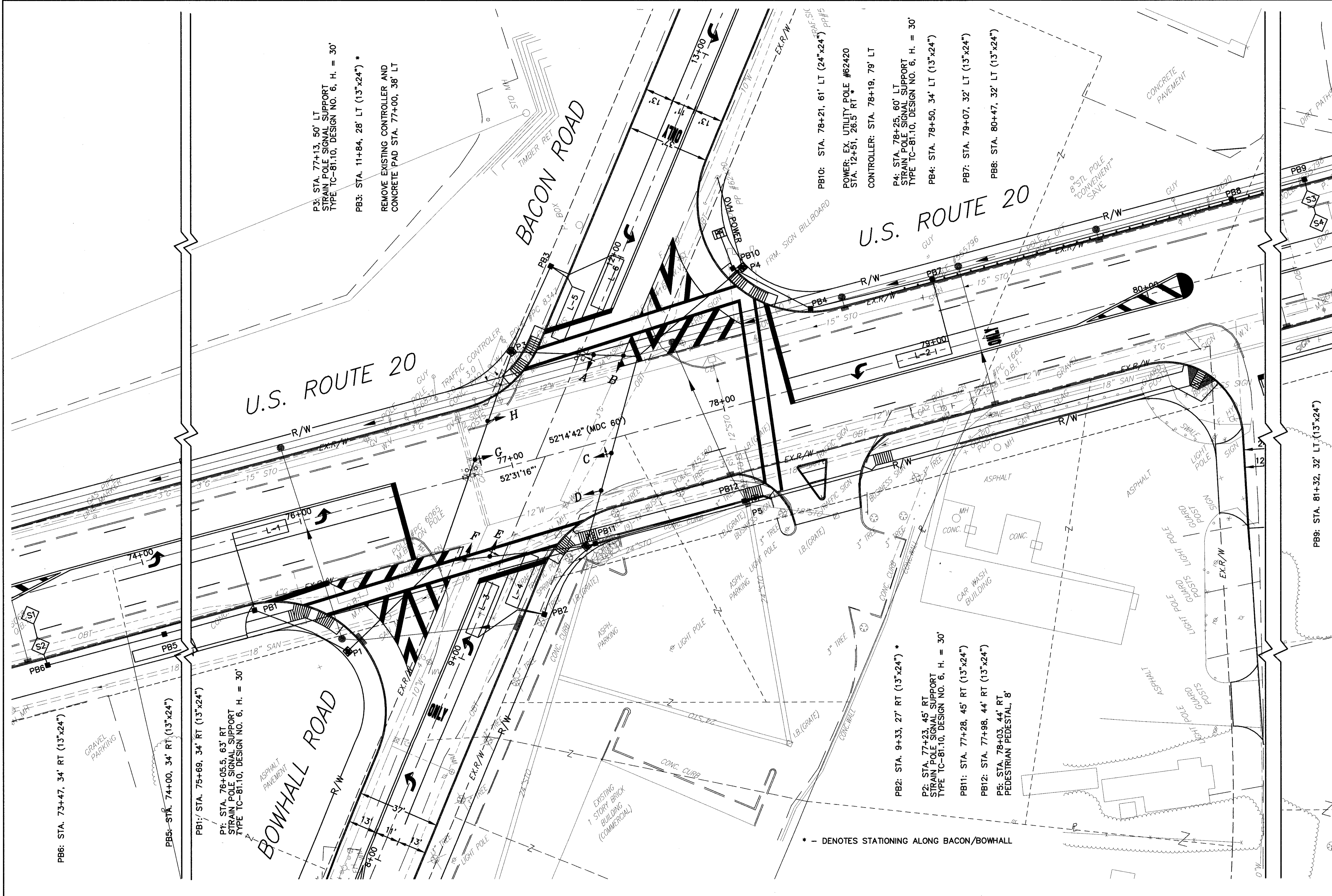

PB6: STA. 73+47, 34' RT (13"x24")

PB5: STA. 74+00, 34' RT (13"x24")

PB1: STA. 75+69, 34' RT (13"x24")

P1: STA. 76+05.5, 63' RT STRAIN POLE SIGNAL SUPPORT TYPE TC-81.10, DESIGN NO. 6, H. = 30'

P3: STA. 77+13, 50' LT STRAIN POLE SIGNAL SUPPORT TYPE TC-81.10, DESIGN NO. 6, H. = 30'

PB3: STA. 11+84, 28' LT (13"x24") * REMOVE EXISTING CONTROLLER AND CONCRETE PAD STA. 77+00, 38' LT

BACON ROAD

BOWHALL ROAD

U.S. ROUTE 20

PB2: STA. 9+33, 27' RT (13"x24") *

P2: STA. 77+23, 45' RT STRAIN POLE SIGNAL SUPPORT TYPE TC-81.10, DESIGN NO. 6, H. = 30'

PB11: STA. 77+28, 45' RT (13"x24")

PB12: STA. 77+98, 44' RT (13"x24")

P5: STA. 78+03, 44' RT PEDESTRIAN PEDESTAL, 8'

PB10: STA. 78+21, 61' LT (24"x24") * POWER: EX. UTILITY POLE #62420 STA. 12+51, 26.5' RT * CONTROLLER: STA. 78+19, 79' LT

P4: STA. 78+25, 60' LT STRAIN POLE SIGNAL SUPPORT TYPE TC-81.10, DESIGN NO. 6, H. = 30'

PB4: STA. 78+50, 34' LT (13"x24")

PB7: STA. 79+07, 32' LT (13"x24")

PB8: STA. 80+47, 32' LT (13"x24")

PB9: STA. 81+52, 32' LT (13"x24")

* - DENOTES STATIONING ALONG BACON/BOWHALL

CALCULATED TUF CHECKED JHM
 GRAPHIC SCALE (IN FEET)
 LAK - 20 - 18.72
 320 441
 TRAFFIC SIGNAL PLAN
 U.S. 20 / BACON ROAD / BOWHALL ROAD