

CALCULATED
CHECKED

BOWHALL ROAD WATER MAIN IMPROVEMENTS
STA. 2+00 TO STA. 6+00

LAK - 20 - 18.72

304
441

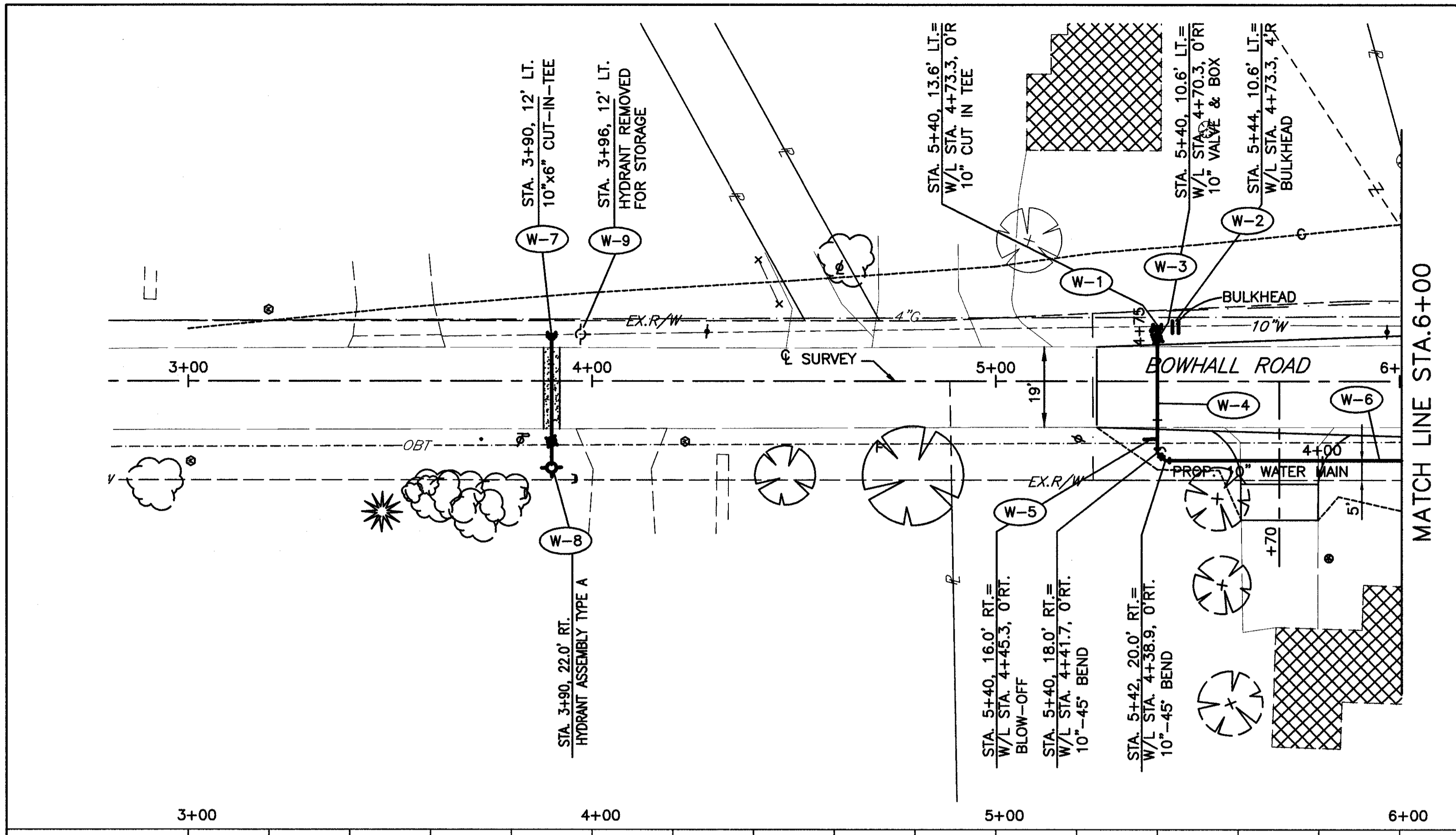

| | | | | | | | | | | | | | | | | | | | | | | | | |
|-----|--|--|--|--|--|--|---|--------|--|--|---|--|--|--|--|--|--|--|--|--|--|--|--|-----|
| 710 | | | | | | | | 686.77 | | | | | | | | | | | | | | | | 710 |
| 705 | | | | | | | | | | | PVI STA = 6+00 PVI ELEV = 685.72 SSD = 250' SSD EXCEEDS DESIGN VALUE 150.00' VC | | | | | | | | | | | | | 705 |
| 700 | | | | | | | | | | | | | | | | | | | | | | | | 700 |
| 695 | | | | | | | MATCH EXISTING STA. 5+25 ELEV. 686.77 | | | | | | | | | | | | | | | | | 695 |
| 690 | | | | | | | | | | | | | | | | | | | | | | | | 690 |
| 685 | | | | | | | | | | | | | | | | | | | | | | | | 685 |
| 680 | | | | | | | | | | | | | | | | | | | | | | | | 680 |
| 675 | | | | | | | | | | | | | | | | | | | | | | | | 675 |
| 670 | | | | | | | | | | | | | | | | | | | | | | | | 670 |
| 665 | | | | | | | | | | | | | | | | | | | | | | | | 665 |

3+00

4+00

5+00

6+00

MATCH LINE STA.6+00

MATCH LINE STA.6+00

EX GRADE

EX 10"WTR

MATCH EXISTING

ALL JOINTS WITHIN THIS AREA SHALL BE RESTRAINED
W/L STA. 4+12 TO STA. 4+75

PROPOSED WATERLINE TRENCH INVERTS

PROPOSED GRADE

5' MIN. COVER

PROP. 10" WATER MAIN

STA. 5+40, 16.0' RT. =
W/L STA. 4+45.3, 0 RT.

STA. 5+40, 18.0' RT. =
W/L STA. 4+41.7, 0 RT.

STA. 5+42, 20.0' RT. =
W/L STA. 4+38.9, 0 RT.

STA. 5+40, 13.6' LT. =
W/L STA. 4+73.3, 0 RT

STA. 5+40, 10.6' LT. =
W/L STA. 4+70.3, 0 RT

STA. 5+44, 10.6' LT. =
W/L STA. 4+73.3, 4 RT

STA. 3+90, 12' LT. =
10"x6" CUT-IN-TEE

STA. 3+96, 12' LT. =
HYDRANT REMOVED FOR STORAGE

STA. 3+90, 22.0' RT. =
HYDRANT ASSEMBLY TYPE A