

COPYRIGHT: CT CONSULTANTS INC. H:\1998\98404gr\DWG\GreenRd.dwg 07/21/99 11:01:32 AM EDT

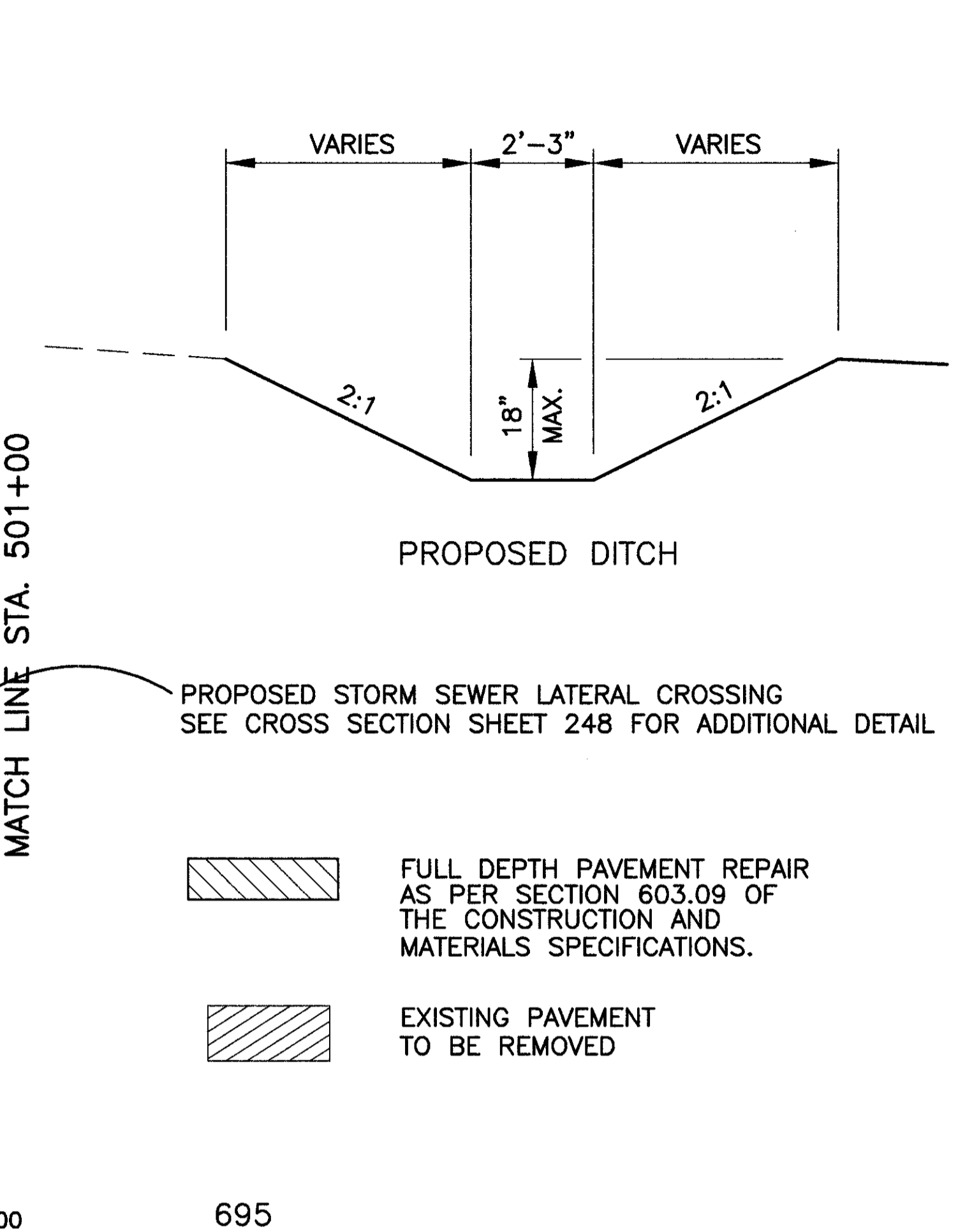
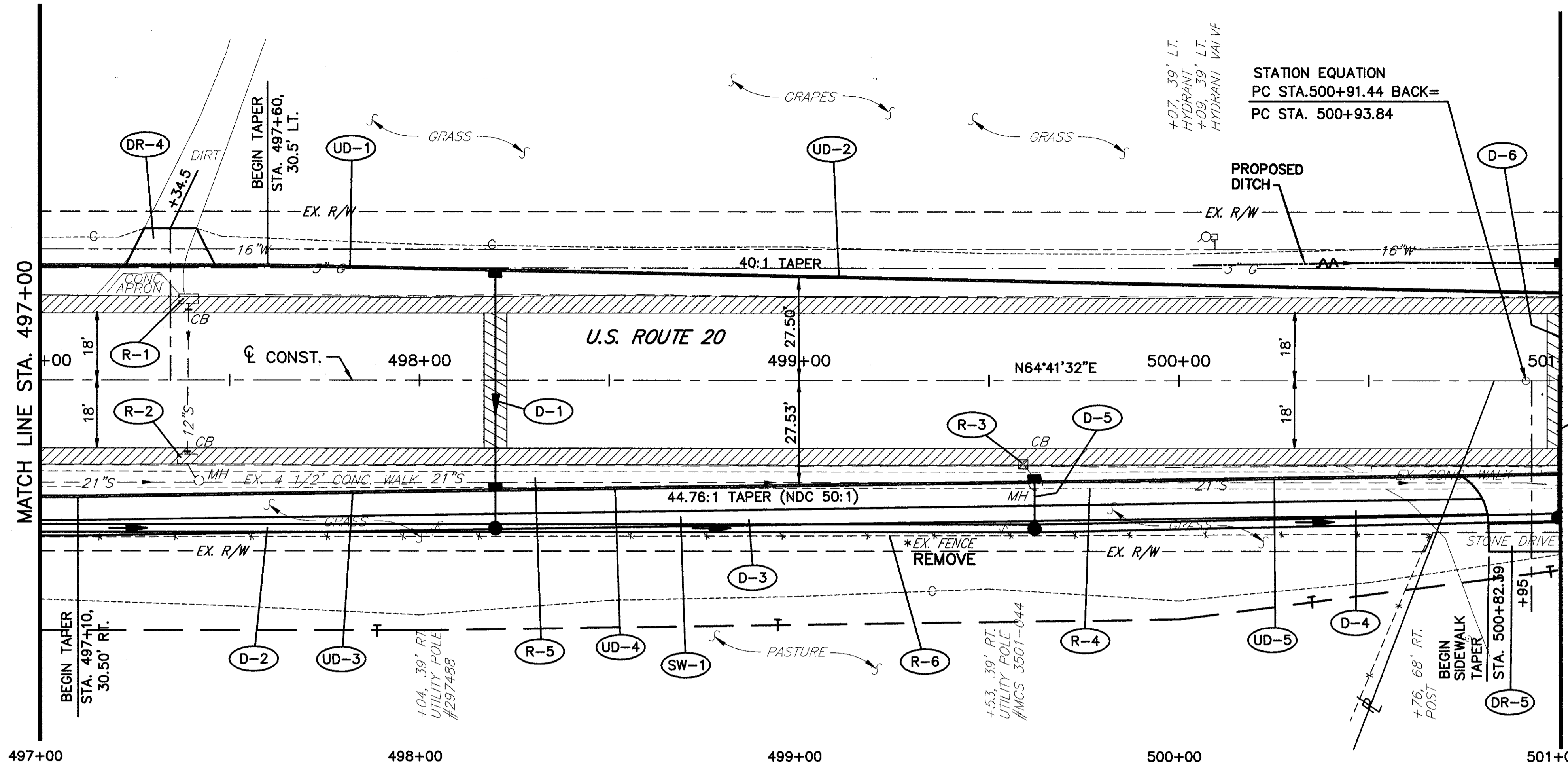

FULL DEPTH PAVEMENT REPAIR AS PER SECTION 603.09 OF THE CONSTRUCTION AND MATERIALS SPECIFICATIONS.
 EXISTING PAVEMENT TO BE REMOVED

695	497+00	498+00	499+00	500+00	501+00	695					
690	674.73	674.83	674.94	675.18	675.42	675.66	675.90	676.14	676.38	676.59	690
685	100.00' VC HIGH POINT ELEV = 676.62 HIGH POINT STA = 501+21.72 PVI STA = 501+27.39 PVI ELEV = 676.75 SSD > 625' SSD EXCEEDS DESIGN VALUE										685
680	400.00' VC LOW POINT ELEV = 674.42 LOW POINT STA = 495+31.82 PVI STA = 495+50.00 PVI ELEV = 673.98 SSD > 625' SSD EXCEEDS DESIGN VALUE										680
675	0.48% (NDC 0.50%)										675
670	EX. 21" STM.										670
665	EX. 18" W.M.										665
660	120' - 24" CONDUIT, TYPE C @ 0.10%			142' - 24" CONDUIT, TYPE C @ 0.10%			138' - 24" CONDUIT, TYPE C @ 0.10%			660	
655	MH NO.3 STA. 495+20.00, 39.0' RT. RIM 675.50 24" INV. 670.50 NE & SW 15" INV. 670.50 NW										655
650	STM. MH. 142, 26.6 RT. EXIST. RIM ELEV. = 674.72 INV. 21" E&W 670.88 INV. 12" N 671.14										650
645	675.01	675.18	675.37	675.62	675.81	676.05	676.31	676.51	676.51	645	
	497+00	498+00	499+00	500+00	501+00	497+00	498+00	499+00	500+00	501+00	