

COPYRIGHT: CT CONSULTANTS INC. H:\1998\98404-gr\DWG\GreenRd.dwg 07/21/99 11:01:32 AM EDT

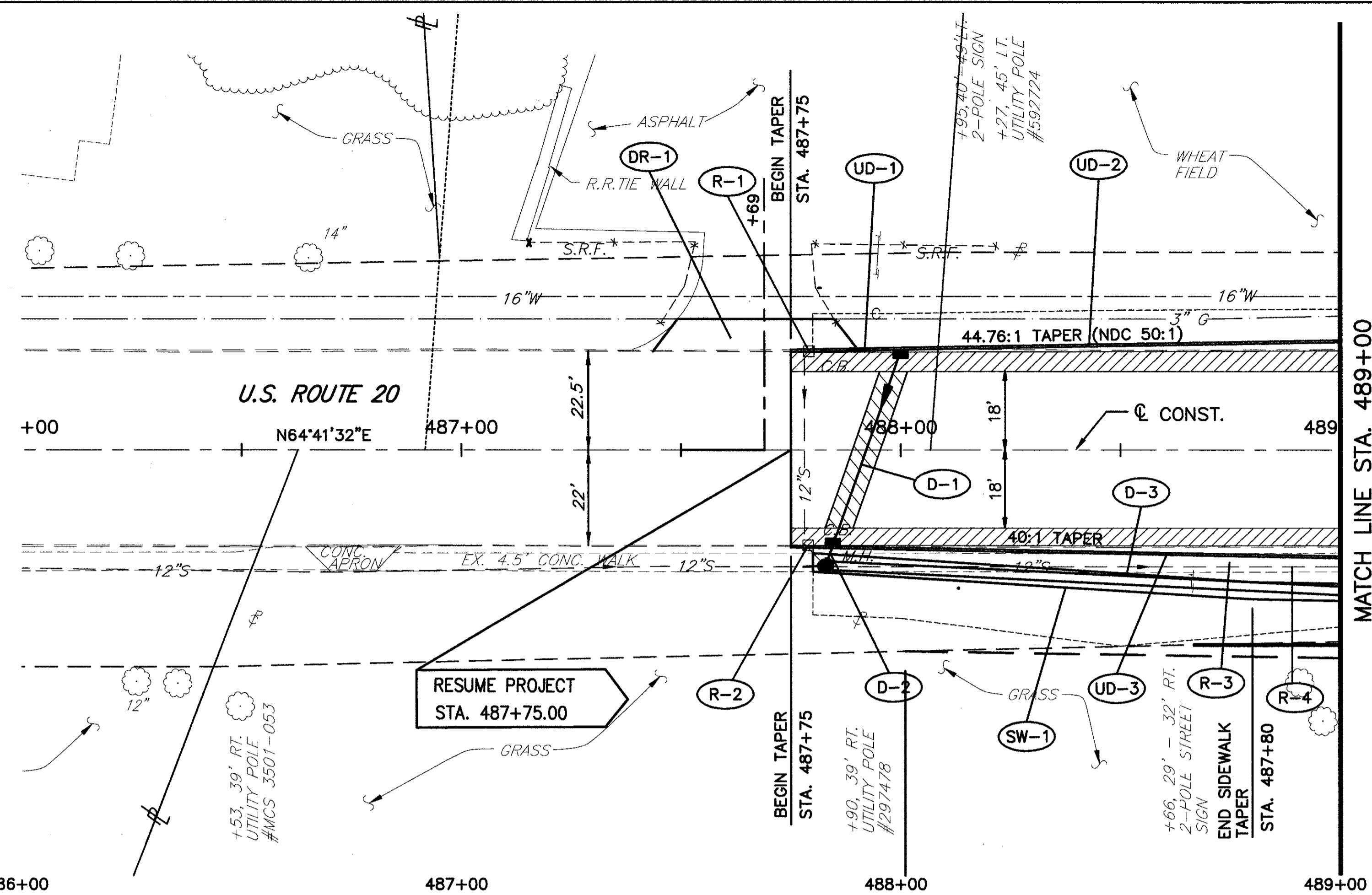

NOTE:
ALL EXISTING CATCH BASINS TO BE REMOVED
SHALL INCLUDE PLUGGING OF ABANDONED
STORM SEWER PIPES AT EACH BASIN. (TYPICAL)

- FULL DEPTH PAVEMENT REPAIR
AS PER SECTION 603.09 OF
THE CONSTRUCTION AND
MATERIALS SPECIFICATIONS.
- EXISTING PAVEMENT
TO BE REMOVED

