

H:\1998\98404\DWG\PRC062.DWG

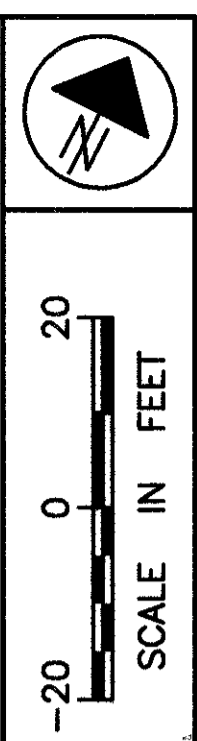
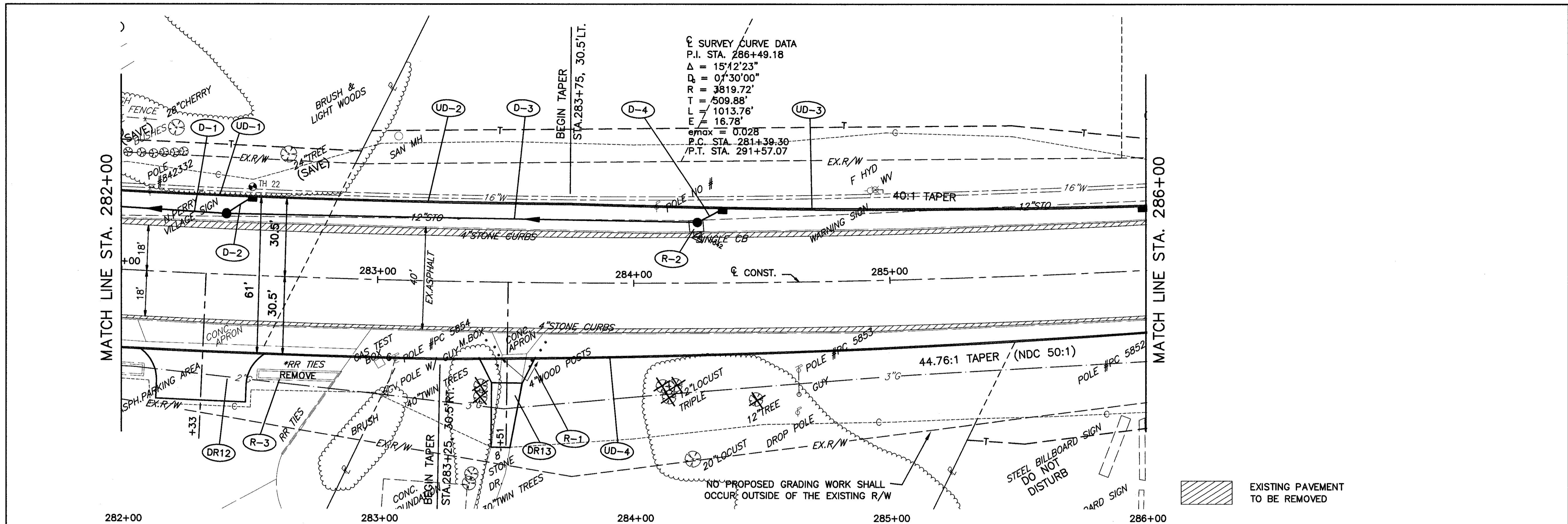

686.02	685.86	685.72	685.60	685.48	685.36	685.24	685.12	685.00	
695									
690									
685	GR. = -0.33% (NDC 0.50%)		GR. = -0.24% (NDC 0.50%)						685
680	EX. 12" STO		EX. 12" STO						680
675	EX. 16" W		EX. 16" W						675
670	EX. 8" SAN		185' - 15" CONDUIT, TYPE B @ 1.00%						670
665	MH NO. 3 STA. 282+40.00, 24' LT. RIM 685.40 15" INV. 679.72 NE 15" INV. 675.78 NE&SW		MH NO. 3 STA. 284+25.00, 24' LT. RIM 684.92 15" INV. 679.50 NE 15" INV. 677.62 SW						665
660	EX. SAN MH STA. 284+73.67, 61.9' RT. RIM 689.75 8" INV. 672.37 E 8" INV. 672.37 W STUB		EX. STO 1B STA. 284+25.22, 19.4' LT. RIM 684.38 12" INV. 679.33 W 12" INV. 679.33 E						660
686.16	685.76	685.51	685.34	685.28	685.26	685.19	685.12	685.10	
282+00	283+00	284+00	285+00	286+00	286+00	286+00	286+00	286+00	

CALCULATED  
CHECKED

US ROUTE 20 PLAN AND PROFILE  
STA. 282+00 TO STA. 286+00

LAK - 20 - 18.72