

H:\1998\98404\DWG\PRB032.DWG

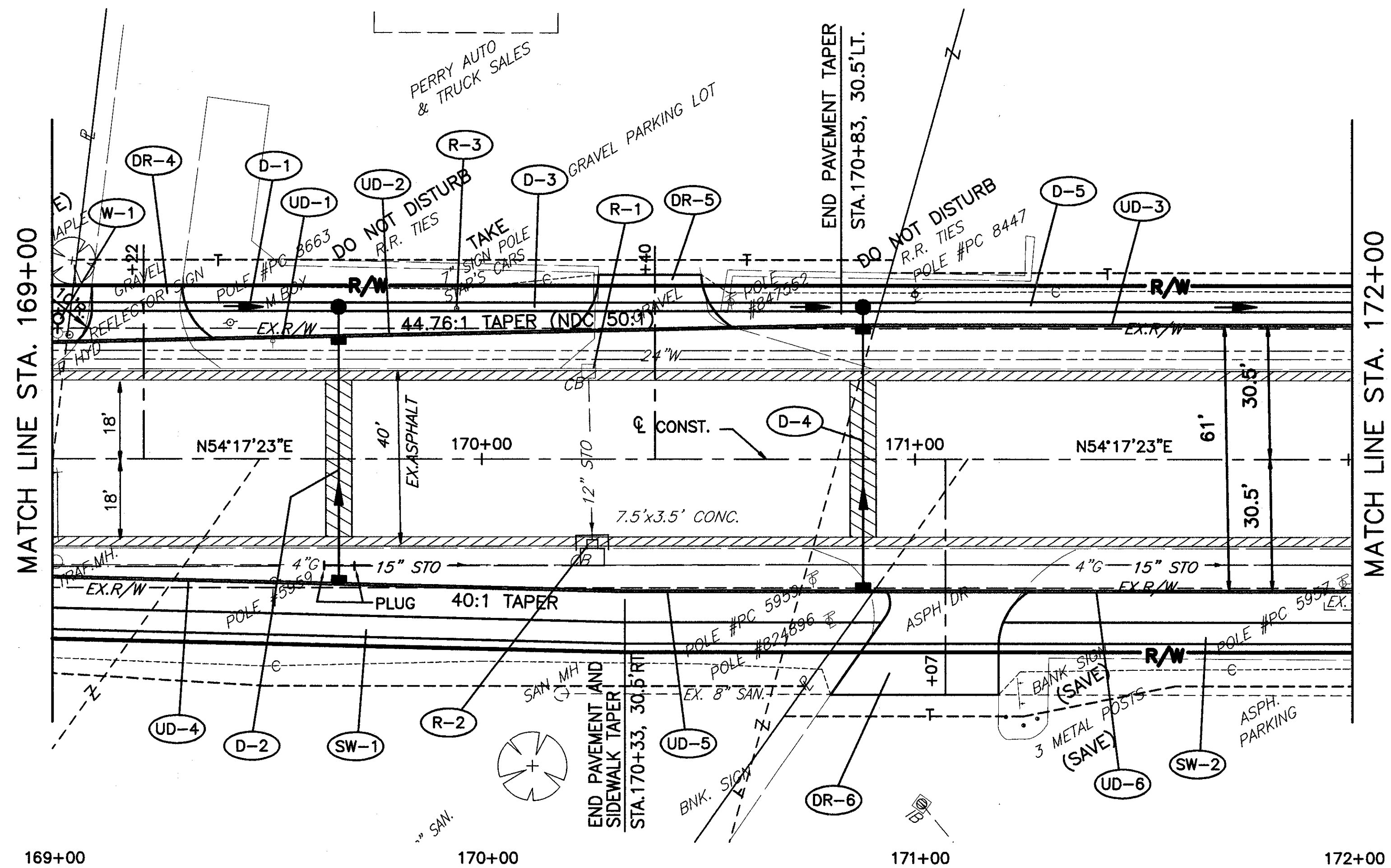

 FULL DEPTH PAVEMENT REPAIR AS PER SECTION 603.09 OF THE CONSTRUCTION AND MATERIALS SPECIFICATIONS.
 EXISTING PAVEMENT TO BE REMOVED

	685.01		684.89		684.77		684.65		684.53		684.41		684.29	
695														695
690														690
685				GR. = -0.24% (NDC 50:1)										685
680														680
675														675
670				67' - 24" CONDUIT, TYPE C @ 0.36%										670
665				121' - 24" CONDUIT, TYPE C @ 0.36%										665
660				112' - 27" CONDUIT, TYPE C @ 0.28%										660
				MH NO. 3 STA. 169+67.00, 35.0' LT. RIM 684.50 15" INV. 680.20 SE 24" INV. 672.84 NE & SW										
				EX. STO. IB STA. 170+25.49, 20.8' RT. RIM 684.00 15" INV. 680.30 W 12" INV. 680.40 N 5" INV. 680.30 E										
				MH NO. 3, AS PER PLAN STA. 170+88.00, 35.0' LT. RIM 684.50 15" INV. 674.40 SE 24" INV. 672.40 SW 27" INV. 672.15 NE										
				EX. SAN. MH STA. 170+18.28, 54.80' RT. RIM 684.30 8" INV. 677.60 W 8" INV. 677.50 N										
	684.92		684.74		684.64		684.49		684.40		684.31		684.19	
	169+00		170+00		171+00		172+00		172+00		172+00		172+00	

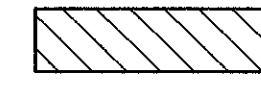
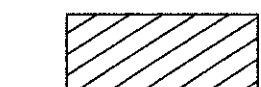
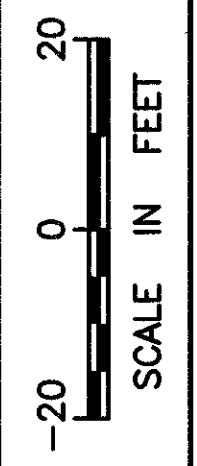

CALCULATED
CHECKED

US ROUTE 20 PLAN AND PROFILE
STA. 169+00 TO STA. 172+00

LAK - 20 - 18.72

143
441