

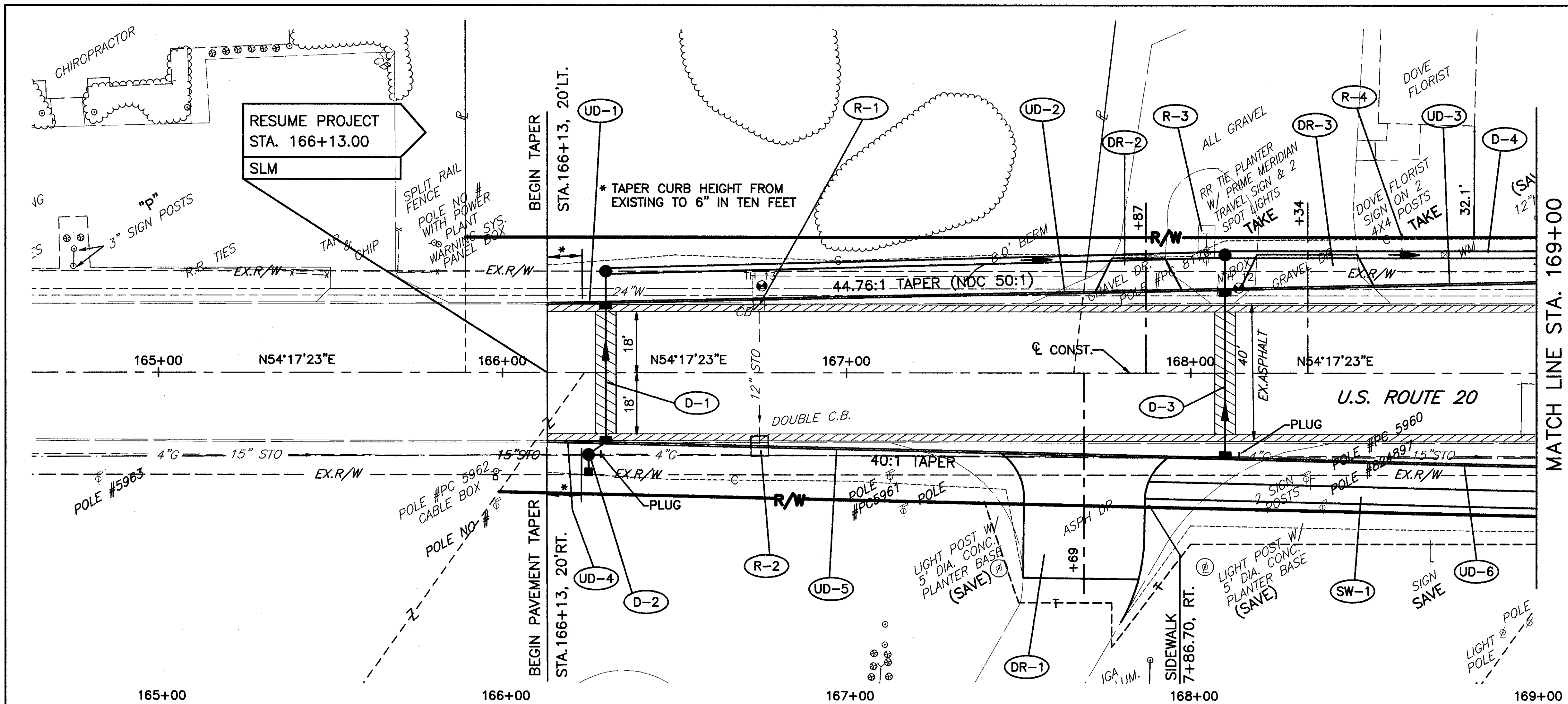

H: 1998 98404 DMG PRB031.DWG



NOTE:  
 ALL EXISTING CATCH BASINS TO BE REMOVED SHALL INCLUDE PLUGGING OF ABANDONED STORM SEWER PIPES AT EACH BASIN. (TYPICAL)

 FULL DEPTH PAVEMENT REPAIR AS PER SECTION 603.09 OF THE CONSTRUCTION AND MATERIALS SPECIFICATIONS.  
 EXISTING PAVEMENT TO BE REMOVED

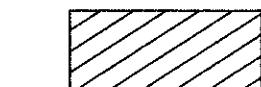
| Station | Elevation | Notes   |
|---------|-----------|---|
| 165+00  | 685.59    |   |
| 166+00  | 685.54    |   |
| 166+13  | 685.58±   | MATCH EXISTING STA. 166+13 ELEV. 685.58±  |
| 167+00  | 685.49    |   |
| 167+00  | 685.37    |   |
| 168+00  | 685.25    |   |
| 168+10  | 685.13    |   |
| 169+00  | 685.01    |   |
| 166+30  | 685.56    | MH NO.3 STA. 166+30.00, 30.0' LT. RIM 684.60 21" INV. 675.45 NE 21" INV. 680.85 SE                    |
| 167+74  | 685.43    | EX. ST0 1A STA. 166+74.70, 21.5' LT. RIM 684.74 12" INV. 681.7±                                       |
| 168+74  | 685.35    | EX. ST0 1B STA. 166+74.73, 28.2' RT. RIM 684.49 15" INV. 680.88 W 15" INV. 680.74 E 12" INV. 680.91 N |
| 168+10  | 685.19    | MH NO.3 STA. 168+10.00, 35.0' LT. RIM 684.50 15" INV. 681.09 SE 21" INV. 673.65 SW 24" INV. 673.40 NE |
| 169+00  | 684.92    |   |

US ROUTE 20 PLAN AND PROFILE  
 STA. 165+00 TO STA. 169+00

LAK - 20 - 18.72

141  
441